



DÉCLARATION DES PERFORMANCES

DoP 0235

pour cheville à frapper fischer FNA II (fixation mécanique pour utilisation dans le béton)

FR

1. <u>Code d'identification unique du type de produit:</u>	DoP 0235	
2. <u>Usage(s) prévu(s):</u>	Fixation dans le béton pour les systèmes redondants non structurels.	
3. <u>Fabricant:</u>	Voir annexes, en particulier les annexes B1- B3 fischerwerke GmbH & Co. KG, Klaus-Fischer-Str. 1, 72178 Waldachtal, Allemagne	
4. <u>Mandataire:</u>	–	
5. <u>Système(s) d'évaluation et de vérification de la constance des performances:</u>	2+	
6. <u>Document d'évaluation européen:</u> Evaluation Technique Européenne: Organisme d'évaluation technique: Organisme(s) notifié(s):	EAD 330747-00-0601, Edition 06/2018 ETA-06/0175; 2021-03-02 DIBt- Deutsches Institut für Bautechnik 2873 TU Darmstadt	
7. <u>Performance(s) déclarée(s):</u> Sécurité d'utilisation (BWR 4) Résistance caractéristique à la charge de traction (charge statique et quasi-statique):	Résistance à la rupture de l'acier: Résistance à l'extraction glissement: Résistance à la rupture du cône béton: Robustesse: Distance au bord et entraxe mini.: Distance au bord pour éviter la rupture par fendage sous charge:	NPD NPD NPD Annexe C1 Annexes B2, C1 NPD
Résistance caractéristique à la charge de cisaillement (charge statique et quasi-statique):	Résistance à la rupture de l'acier (charge de cisaillement) Résistance à la rupture par effet de levier : Résistance à la rupture du béton en bord de dalle:	NPD NPD NPD
Résistance caractéristique pour toutes les directions de charges et modes de ruine pour dimensionnement simplifié:	Résistance caractéristique:	Annexe C1
Durabilité:	Durabilité:	Annexes A2, B1
Sécurité en cas d'incendie (BWR 2) Réaction au feu: Résistance au feu:	Classe (A1) Résistance en cas d'incendie, rupture de l'acier Résistance en cas d'incendie, extraction glissement Résistance en cas d'incendie, rupture de l'acier	NPD NPD NPD
Résistance en cas d'incendie pour toutes les directions de charges et modes		Annexe C2



8. Documentation technique appropriée et/ou -
documentation technique spécifique:

Les performances du produit identifié ci-dessus sont conformes aux performances déclarées. Conformément au règlement (UE) no 305/2011, la présente déclaration des performances est établie sous la seule responsabilité du fabricant mentionné ci-dessus.

Signé pour le fabricant et en son nom par:



Dr. Oliver Geibig, Directeur Général Business Units & Ingénierie
Tumlingen, 2021-03-16



Jürgen Grün, Directeur Général Chimie & Qualité

Cette DoP a été préparée en plusieurs langues. En cas de différend relatif à l'interprétation, la version anglaise prévaudra.

L'annexe comprend des informations volontaires et complémentaires en langue anglaise dépassant les exigences légales (spécifiées de manière neutre).

Specific Part

1 Technical description of the product

The fischer nail anchor FNA II is an anchor made of galvanised (FNA II) or stainless steel (FNA II R) or high corrosion resistant steel (FNA II HCR). The anchor is pushed into a predrilled cylindrical drill hole and expanded by loading.

The product description is given in Annex A.

2 Specification of the intended use in accordance with the applicable European Assessment Document

The performances given in Section 3 are only valid if the anchor is used in compliance with the specifications and conditions given in Annex B.

The verifications and assessment methods on which this European Technical Assessment is based lead to the assumption of a working life of the anchor of at least 50 years. The indications given on the working life cannot be interpreted as a guarantee given by the producer, but are to be regarded only as a means for choosing the right products in relation to the expected economically reasonable working life of the works.

3 Performance of the product and references to the methods used for its assessment

3.1 Safety in case of fire (BWR 2)

Essential characteristic	Performance
Reaction to fire	Class A1
Resistance to fire	See Annex C 2

3.2 Safety in use (BWR 4)

Essential characteristic	Performance
Characteristic resistance to tension and shear load (static and quasi-static loading)	See Annex B 2 and C 1
Durability	See Annex B 1

4 Assessment and verification of constancy of performance (AVCP) system applied, with reference to its legal base

In accordance with European Assessment Document EAD No. 330747-00-0601, the applicable European legal act is: [97/161/EC].

The system to be applied is: 2+

**Only for multiple use for non-structural applications according to
EAD 330747-00-0601**

Design types:

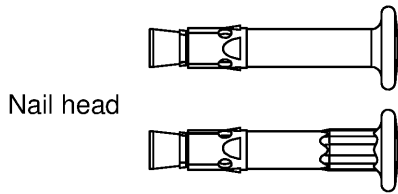

FNA II 6x25/..
FNA II 6x30/..

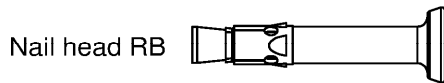

FNA II 6x25/.. RB
FNA II 6x30/.. RB

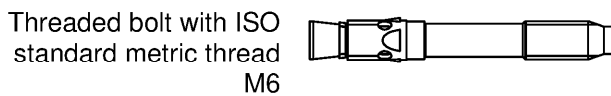

FNA II 6x25 M6/..
FNA II 6x30 M6/..

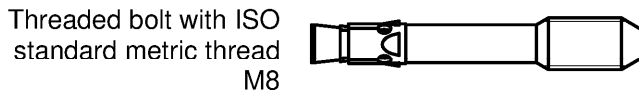

FNA II 6x25 M8/..
FNA II 6x30 M8/..

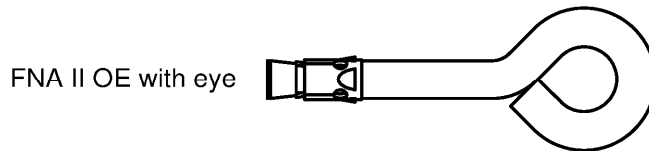

FNA II 6x25 OE
FNA II 6x30 OE

Intended use:

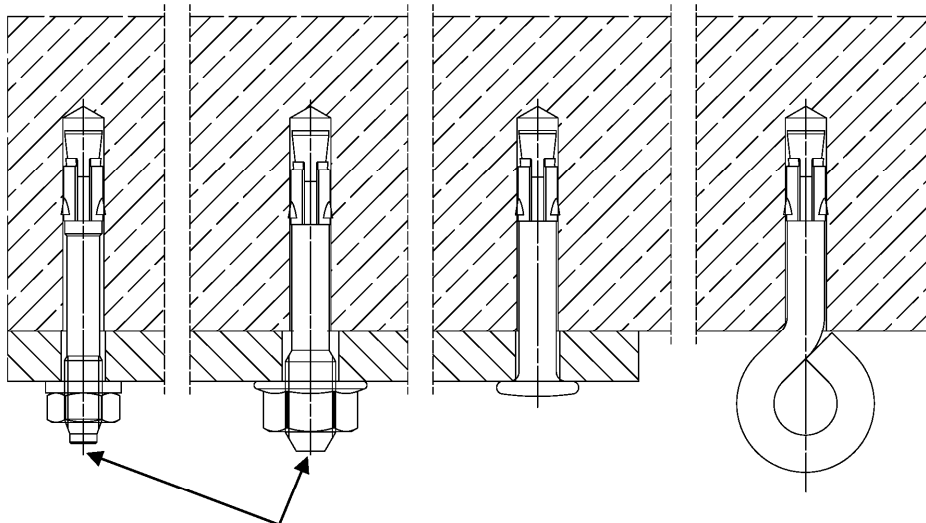

Additional marking only galvanised steel for $h_{ef} = 25$ mm (centring, bar or points)

(Fig. not to scale)

fischer nail anchor FNA II

Product description
Product and intended use

Annex A 1

Appendix 2 / 8

Marking:

Nail head

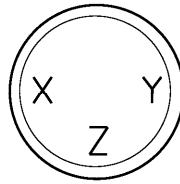

Marking at **X**: "O" for $h_{ef} = 25$ mm
and "I" for $h_{ef} = 30$ mm;

Marking at **Y**: t_{fix}

Marking at **Z**: "R" or "HCR" (stainless steel)

Expansion sleeve (or bolt)

e.g.:

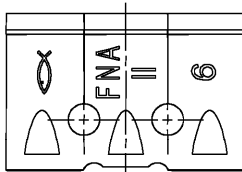

For stainless steel additional marking "R" or "HCR"

Marking-Codes for Y:

	A	Q	T	N	P	B	L	H	U
t_{fix}	5	10	15	20	25	30	35	40	45
	D	V	S	W	X	E	M	Z	K
t_{fix}	50	55	60	65	70	75	80	85	90
	(A)	F	(B)	(D)	(E)	G	J		
t_{fix}	95	100	105	110	115	120	125		

At $t_{fix} > 125$ mm the corresponding figure is marked.

Shaft (threaded bolt)

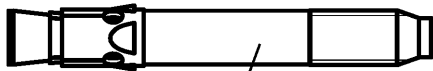

Marking e.g.: 6/10
thread size/thickness of the fixture

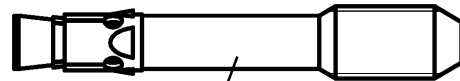

Marking e.g.: 8/10
thread size /thickness of the fixture
Exception: 8/5 no marking

Table A2.1: Materials FNA II

Part	Designation	Material		
		FNA II	FNA II R	FNA II HCR
	Steel grade	Steel	Stainless steel R	High corrosion resistant steel HCR
		Zinc plated $\geq 5 \mu\text{m}$, ISO 4042:2018	Acc. to EN 10088:2014 Corrosion resistance class CRC III acc. to EN 1993-1-4:2015	Acc. to EN 10088:2014 Corrosion resistance class CRC V acc. to EN 1993-1-4:2015
1	Expansion sleeve	Cold strip, EN 10139:2016 or stainless steel EN 10088:2014	Stainless steel EN 10088:2014	Stainless steel EN 10088:2014
2	Cone bolt			High corrosion resistant steel EN 10088:2014

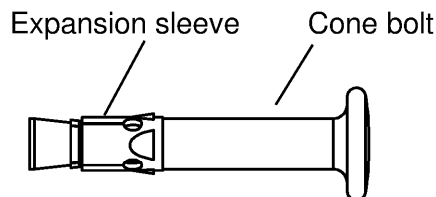

(Fig. not to scale)

fischer nail anchor FNA II

Product description
Marking and materials

Annex A 2

Specifications of intended use

Fastenings subject to:

Size	FNA II, FNA II R, FNA II HCR
Hammer drilling with standard drill bit 	All types
Static and quasi-static loads	✓
Cracked and uncracked concrete	
Fire exposure	

Base materials:

- Compacted reinforced and unreinforced normal weight concrete without fibres (cracked and uncracked) according to EN 206:2013+A1:2016
- Strength classes C12/15 to C50/60 according to EN 206:2013+A1:2016

Use conditions (Environmental conditions):

- Structures subject to dry internal conditions (FNA II, FNA II R, FNA II HCR) with $h_{ef} \geq 25$ mm
- For all other conditions according to EN 1993-1-4:2006 + A1:2015 corresponding to corrosion resistance class
 - CRC III: for FNA II R with $h_{ef} \geq 30$ mm
 - CRC V: for FNA II HCR with $h_{ef} \geq 30$ mm

Design:

- Fastenings are to be designed under the responsibility of an engineer experienced in fastenings and concrete work
- Verifiable calculation notes and drawings have to be prepared taking account of the loads to be anchored. The position of the fastener is indicated on the design drawings (e.g. position of the fastener relative to reinforcement or to supports, etc.)
- Simplified design method C according to EN 1992-4:2018 Annex G

Installation:

- Fastener installation carried out by appropriately qualified personnel and under the supervision of the person responsible for technical matters on site
- Use of the fastener only as supplied by the manufacturer without exchanging the components of the fastener
- Checking before placing the fastener to ensure that the strength class of the concrete in which the fastener is to be placed, is in the range given and is not lower than that of the concrete to which the characteristic loads apply
- Check of concrete being well compacted, e.g. without significant voids
- Drill hole created perpendicular +/- 5° to concrete surface, positioning without damaging the reinforcement
- In case of aborted hole: new drilling at a minimum distance twice the depth of the aborted drill hole or smaller distance if the aborted drill hole is filled with high strength mortar (e.g. FIS HB, FIS SB, FIS EM Plus, FIS V Plus) and if under shear or oblique tension load it is not in the direction of load application

fischer nail anchor FNA II

Intended Use
Specifications

Annex B 1

Appendix 4 / 8

Table B2.1: Installation parameters

Effective embedment depth	$h_{ef} \geq$	[mm]	25	30
Nominal drill bit diameter	$d_0 =$		6	
Cutting diameter of drill bit	$d_{cut,max} \leq$		6,4	
Depth of drill hole	$h_0 \geq$		31	36
Diameter of clearance hole in the fixture for all FNA II except for M8 and OE	$d_f \leq$	[Nm]	7	
Diameter of clearance hole in the fixture for M8	$d_f \leq$		9	
Maximum torque moment (only threaded types)	$max. T_{inst} \leq$		4	
Minimum thickness of member	h_{min}	[mm]	80	
Maximum thickness of fixture	$max. t_{fix}$		400	

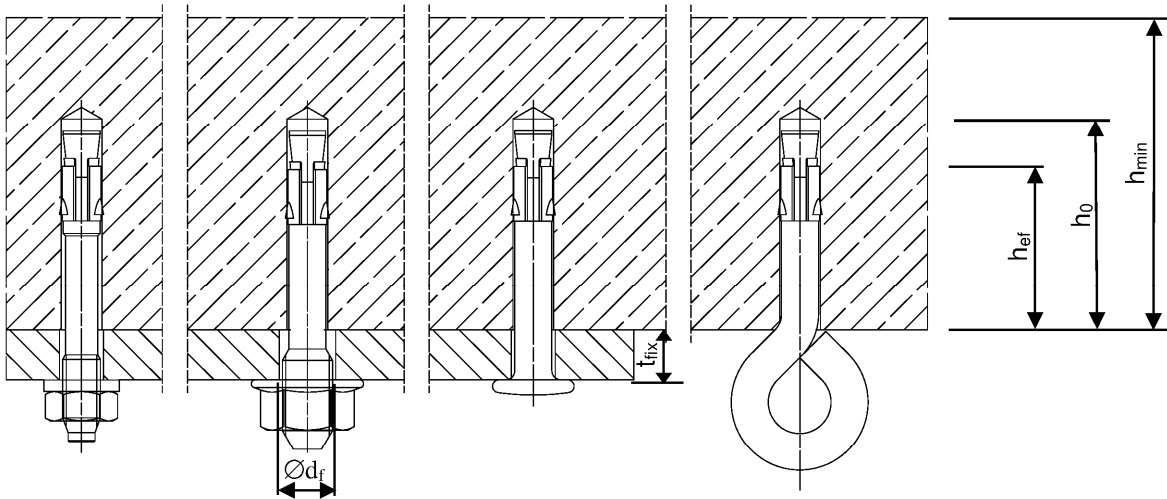

(Fig. not to scale)

fischer nail anchor FNA II

Intended Use
Installation parameters

Annex B 2

Appendix 5 / 8

Installation instruction:

Drill the hole

Clean the hole

Set the fastener

Apply max. T_{inst}

Push through installation

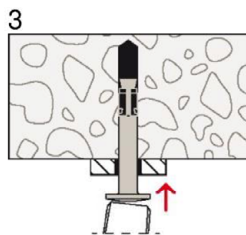
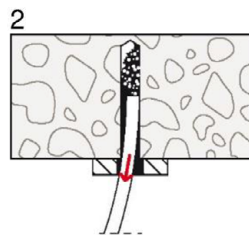
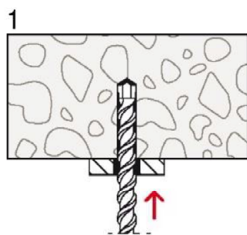
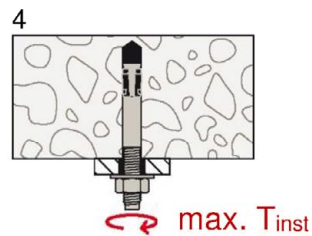
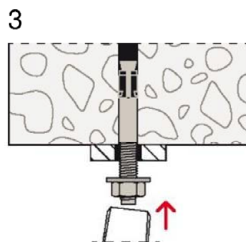
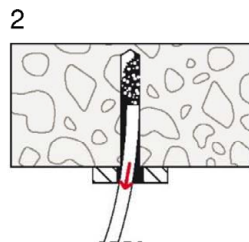
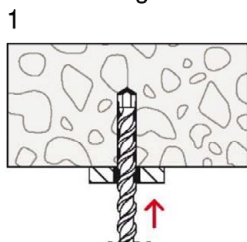

Pre-positioned installation

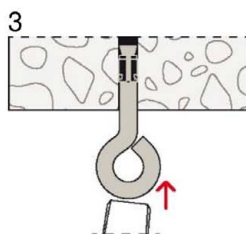
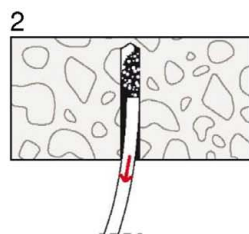
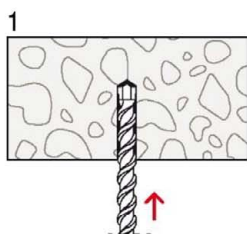
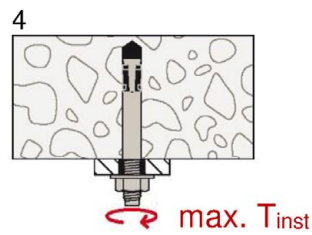
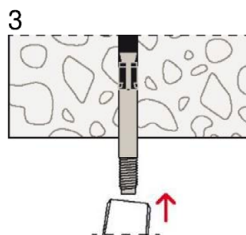
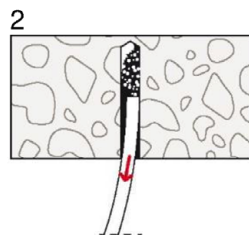
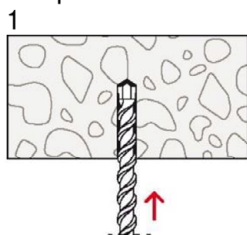

(Fig. not to scale)

fischer nail anchor FNA II

Intended Use
Installation instruction

Annex B 3

Appendix 6 / 8

Table C1.1: Characteristic resistance of a fixing point¹⁾ for all load directions

Type of anchor		FNA II 6x25/..		FNA II 6x25 M6/.. FNA II 6x25 M8/..		FNA II 6x25 OE		FNA II 6x30 OE		FNA II 6x30/..		FNA II 6x30 M6/.. FNA II 6x30 M8/..		
		Material		FNA II		FNA II		FNA II, FNA II R, FNA II HCR		FNA II, FNA II R, FNA II HCR		FNA II, FNA II R, FNA II HCR		
Effective anchorage depth	$h_{ef} \geq$ [mm]	25		30										
Installation factor	γ_{inst} [-]	1,0												
Characteristic bending moment	$M^0_{Rk,s}$ [Nm]	10,7	9,2		13,2	9,2								
Partial factor	γ_{Ms} [-]	1,25												
Maximum load and corresponding spacing - and edge distances														
Characteristic spacing between fixing points ¹⁾	$a_1 = a_2 \geq$ [mm]	200												
Minimum spacing within a fixing point ¹⁾	$s_{cr} =$	50												
Characteristic resistance F_{Rk} C20/25 to C50/60 (C12/15)	$c_{cr}^{(2)} \geq 100$ mm	[kN]	3,0 (2,5)	1,5		5,0 (4,0)								
	$c_{cr}^{(2)} \geq 50$ mm	[kN]	2,35 (1,9)			2,35 (1,9)								
Partial factor	γ_M [-]	1,5												
Reduced loads for reduced spacing - and corresponding edge distances														
Characteristic spacing between fixing points ¹⁾	$a_1 = a_2 \geq$ [mm]	100												
Minimum spacing within a fixing point ¹⁾	$s_{cr} =$	50												
Characteristic resistance F_{Rk} C20/25 to C50/60 (C12/15)	$c_{cr}^{(2)} \geq 200$ mm	[kN]	3,0 (2,5)	1,5		5,0 (4,0)								
	$c_{cr}^{(2)} \geq 50$ mm	[kN]	1,7 (1,2)	1,5 (1,2)		1,7 (1,2)								
Partial factor	γ_M [-]	1,5												
Reduced loads for minimum spacing - and edge distance														
Characteristic spacing between fixing points ¹⁾	$a_1 = a_2 \geq$ [mm]	100												
Minimum spacing within a fixing point ¹⁾	$s_{cr} =$	40												
Characteristic resistance F_{Rk} C20/25 to C50/60 (C12/15)	$c_{cr} \geq 40$ mm	[kN]	1,30 (0,85)											
Partial factor	γ_M [-]	1,5												

¹⁾ See EN 1992-4:2018, Picture 3.4

²⁾ Intermediate values for c may be calculated by linear interpolation

fischer nail anchor FNA II

Performances

Characteristic resistance

Annex C 1

Appendix 7 / 8

Table C2.1: Characteristic resistance of a fixing point²⁾ under fire exposure in concrete C20/25 to C50/60

Characteristic resistance under fire exposure for all load directions for $h_{ef} = 25$ mm

Type of anchor	Spacing	Edge distance	Effective anchorage depth	Characteristic resistance $F_{Rk,fi}$ [kN]					
				$s_{cr,fi} \geq$ [mm]	$c_{cr,fi} \geq$ [mm]	$h_{ef} \geq$ [mm]	R 30	R 60	R 90
FNA II 6x25/..	100	50	25		0,6	0,3	0,6	0,5	0,3
FNA II 6x25 M6/..							0,35	0,3	
FNA II 6x25 M8/..									
FNA II 6x25 OE							0,3	0,2	

Characteristic resistance under fire exposure for all load directions for $h_{ef} = 30$ mm

Type of anchor	Spacing	Edge distance	Effective anchorage depth	Characteristic resistance $F_{Rk,fi}$ [kN]				
				$s_{cr,fi} \geq$ [mm]	$c_{cr,fi} \geq$ [mm]	$h_{ef} \geq$ [mm]	R 30	R 60
FNA II 6x30/..	120	60	30		0,9	0,8	0,5	0,3
	100	50						
FNA II 6x30 M6/..	120	60			0,6	0,35	0,3	
	100	50						
FNA II 6x30/..R/HCR	120	60			0,9		0,7	
	100	50			0,6		0,5	
FNA II 6x30 M6/.. R/HCR	120	60			0,9		0,7	
FNA II 6x30 M8/.. R/HCR	100	50			0,6		0,5	
FNA II 6x30 OE R/HCR	100	50			0,3	0,2	0,1	

Characteristic resistance under fire exposure for all load directions for $h_{ef} = 30 + 5^{1)}$ mm

Type of anchor	Spacing	Edge distance	Effective anchorage depth	Characteristic resistance $F_{Rk,fi}$ [kN]				
				$s_{cr,fi} \geq$ [mm]	$c_{cr,fi} \geq$ [mm]	$h_{ef} \geq$ [mm]	R 30	R 60
FNA II 6x30/.. R/HCR	140	70	30+5 ¹⁾		1,3		1,0	0,7
FNA II 6x30 M6/.. R/HCR					0,7		0,6	
FNA II 6x30 M8/.. R/HCR	100	50						

Characteristic resistance under fire exposure for shear load without level arm

Type of anchor	Characteristic resistance $M^0_{Rk,s,fi}$ [Nm]			
	R 30	R 60	R 90	R 120
FNA II 6x25 OE/..	0,2	0,1	0,08	0,07
FNA II 6x25..; FNA II 6x25 .. RB; /..	0,9	0,7	0,4	0,3
FNA II 6x25 M6..; FNA II 6x25 M8.. / ..	0,3	0,2	0,2	0,2
FNA II 6x30..; FNA II 6x30 .. RB; /.. R/HCR	4,4	2,0	1,2	0,8
FNA II 6x30 M6..; FNA II 6x30 M8.. /.. R/HCR	2,8	1,3	0,8	0,5

¹⁾ The effective anchorage depth $h_{ef} = 30 + 5$ mm is reached by setting the anchor FNA II 6x30/... 5 mm deeper with an anchor that is 5 mm longer than required for the actual thickness of the fixture.

²⁾ A fixing point is defined as a single anchor or a group of 2 or 4 anchors

In case of fire attack from more than one side, the edge distance shall be $c_{fi,min} \geq 300$ mm

fischer nail anchor FNA II

Performances

Characteristic resistance under fire exposure

Annex C 2