

# nVent LENTON DR16 Ultimate Terminator

The nVent LENTON DR16 Ultimate Terminator is designed to eliminate reinforcing bar hooks and simplify bar placement. The Terminator head area exceeds 5x bar area (net 4x) and maintains greater design flexibility than hooked bars. The system is designed to meet Caltrans Ultimate performance with A706 grade 60 rebar, ASTM A970 Classes A, HA, and B performance with A706 and A615 grade 60 and grade 80 rebar.



## FEATURES

- Minimizes embedment lengths and reduces congestion
- Simplifies concrete placement
- Permanently fastened to the bar for secure transportation
- Fast installation makes it ideal for high-volume shear ties

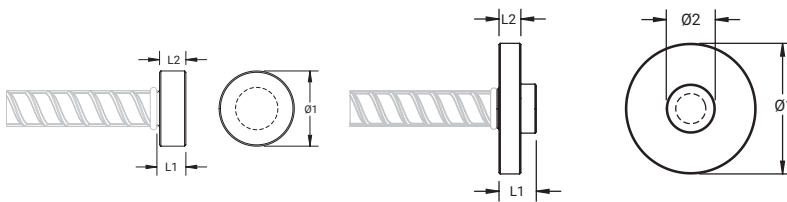

Finish: Plain | Material: Steel  
100% U.S. Domestic Content: Yes



Part Number	Rebar Size, US	Rebar Size, Canada	Diameter 1 Ø1	Diameter 2 Ø2	Length 1 L1	Length 2 L2	Unit Weight
LU12DR16D	#4	10 M	1.38"	0.51"	0.79"	0.59"	0.3 lb
LU16DR16D	#5	15 M	1.75"	0.67"	0.79"	0.59"	0.4 lb
LU20DR16D	#6	20 M	2.00"	0.83"	0.79"	0.59"	0.6 lb
LU22DR16D	#7	–	2.25"	0.91"	0.83"	0.63"	0.7 lb
LU25DR16D	#8	25 M	2.50"	1.02"	0.98"	0.78"	1.1 lb
LU28DR16D	#9	30 M	2.75"	1.14"	0.98"	0.78"	1.4 lb
LU32DR16D	#10	–	3.00"	1.30"	1.14"	0.90"	1.9 lb
LU36DR16D	#11	35 M	3.25"	1.46"	1.22"	0.98"	2.4 lb
LU43TDR16D	#14	45 M	4.00"	2.25"	1.75"	1.04"	4.7 lb
LU57TDR16D	#18	55 M	5.13"	3.00"	2.50"	1.44"	10.8 lb

Designed to Meet: ACI 318; AS3600; ASTM A970

Our powerful portfolio of brands:

**CADDY ERICO HOFFMAN ILSCO RAYCHEM SCHROFF**