

REAR VIEW

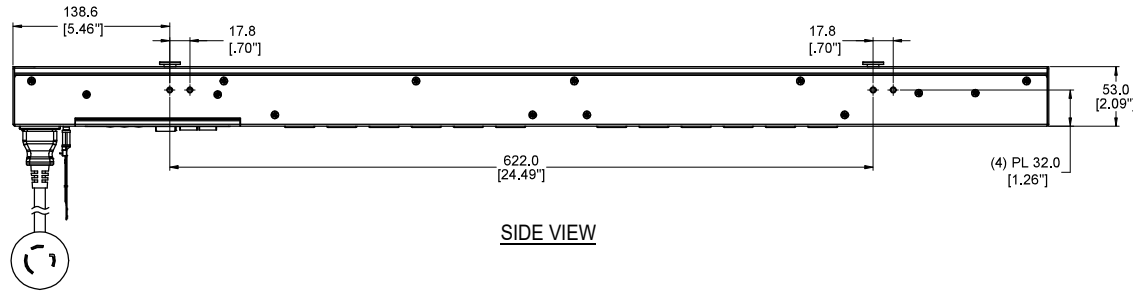

SIDE VIEW

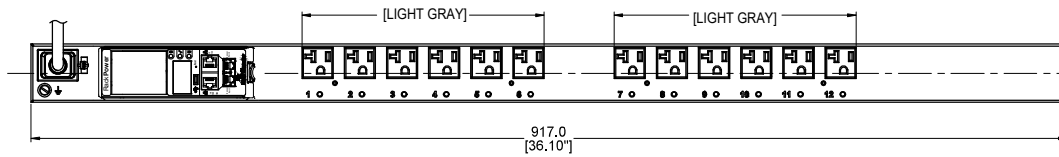

FRONT VIEW

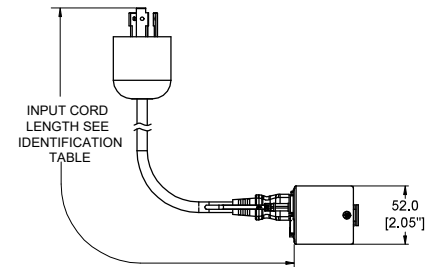

BOTTOM VIEW

TECHNICAL SPECIFICATIONS	
UNIT TYPE:	MONITORED SWITCHED
ORIENTATION:	VERTICAL, 0U HALF
OUTLET QTY & TYPE:	(12)5-20R
INPUT VOLTAGE:	100-120VAC
INPUT CURRENT:	20A (16A DERATED)
BREAKER QTY & TYPE:	N/A
INPUT PHASE:	SINGLE-PHASE
RATED POWER:	1.9kVA
INPUT PLUG:	SEE NOTE 7
INPUT POWER CORD:	SEE IDENTIFICATION TABLE
FEATURES	
METERING ACCURACY	+/-1% TO ISO/ IEC 62052-21
METERING ATTRIBUTES	VOLTAGE(V), CURRENT(A), APPARENT POWER(kVA), REAL POWER(kW), POWER FACTOR, ENERGY(kWh)
METERED COMPONENTS	INPUT(PHASE)
REMOTE OUTLET SWITCHING	YES
ENVIRONMENTAL CONDITIONS	
OPERATING TEMPERATURE	-5 TO 60 C (23 TO 140 F)
STORAGE TEMPERATURE	-20 TO 60 C (-4 TO 140 F)
HUMIDITY (OPERATING/STORAGE)	5-90% RH / 5-95% RH; NON-CONDENSING
MAX OPERATING ELEVATION, ABOVE MSL	3000M(9840FT)
COMPLIANCE	
SAFETY&ENVIRONMENTAL	RoHS COMPLIANT

IDENTIFICATION TABLE	RP 2310	*	*	*	*
		INPUT PLUG	CHASSIS COLOR	CORD OPTION	ORIENTATION
MODEL IS SHOWN IN DEFAULT CONFIGURATION. FOR OPTIONAL CONFIGURATIONS, USE ITEM IDENTIFIER CODE IN PLACE OF EACH ASTERISK. ORDERABLE BASED ON FORMAT: RP2310* **** DO NOT INCLUDE TRAILING ZEROS IN **** SUFFIX		(DEFAULT) L5-20P=0	(DEFAULT) BLACK = 0 BLUE = B RED = R WHITE = W GREEN = G YELLOW = Y	(DEFAULT) 3m [10'] = 0 1m [3.2'] = 1 2m [6.6'] = 2	(DEFAULT) TOP FRONT FEED = 0 BOTTOM FEED = 2
OPTIONS LISTED ON THIS ROW ARE NON STANDARD, CONTACT SALES FOR ADDITIONAL INFORMATION			ORANGE = A	0.5m [1.6'] = A 1.2m [4'] = G 1.5m [4.9'] = B 1.8m [6'] = F 2.5m [8.2'] = C	

NOTES :

- INSTALLATION SHALL COMPLY WITH ALL APPLICABLE NATIONAL, STATE AND LOCAL CODES.
- PRIMARY DIMENSIONS ARE IN MILLIMETERS. SECONDARY DIMENSIONS ARE IN [INCHES]
- UNIVERSAL MOUNTING BRACKET IS AN ALTERNATIVE MOUNTING METHOD TO THE TOOLLESS MOUNT FOR 3RD PARTY ENCLOSURES. BRACKET IS PROVIDED WITH THE UNIT.
- DETAILED INSTALLATION INSTRUCTIONS CAN BE FOUND IN THE QUICK START GUIDE
- CONNECT EXTERNAL EARTH GROUND TO THE 10-32 SIZE THREADED NUT
- SEE PRODUCT DOCUMENTATION FOR FURTHER INFORMATION
- INPUT PLUG CONFIGURATION (SEE IDENTIFICATION TABLE) FOR DUAL-RATED UNITS, NEMA PLUGS ARE NAM RATED ONLY AND CAPTIVE AUS/NZ PLUGS ARE EMEA RATED ONLY



THIS DRAWING AND SPECIFICATIONS HEREIN ARE THE PROPERTY OF CIS GLOBAL AND SHALL NOT BE COPIED, REPRODUCED OR USED IN WHOLE OR IN PART, AS THE BASIS FOR THE MANUFACTURE OR SALE OF ITEMS WITHOUT WRITTEN PERMISSION FROM CIS GLOBAL. THIS DRAWING IS BASED UPON LATEST AVAILABLE INFORMATION AND IS SUBJECT TO CHANGE WITHOUT NOTICE

ECN/ECO	REV.	DESCRIPTION	DATE	APPROVED
ECN-2210-0226	E2	REVISE METER ACCURACY AND ATTRIBUTES CONTENT	2022/10/08	LRF
	E1	INITIAL DRAFT REVIEW	2022/05/13	LRF

REVISIONS		TITLE:	UNLESS NOTED, DIMENSIONS ARE IN MILLIMETERS & TOLERANCES ARE:	PART NO:	REV.
		Advantage Series Metered Switched	X: ±1 MM X*: ±1* X.X ±0.5 MM X.X*: ±0.5* X.XX ±0.20 MM X.XX*: ±0.20* ØX.X ±0.3 MM ØX.XX ±0.10 MM	RP2310WXYZ_DA	E2
		PROJECT: RackPower	BRACKETED DIMENSIONS ARE IN INCHES FOR REFERENCE ONLY	DRAWN BY: LRF	2022/05/13
			⊙ THIRD ANGLE PROJECTION	ENGINEER: LJB	2022/10/08
			INTERPRET PER ASME Y14.5M-1994	APPROVED BY: Hanson	2022/10/08
				SCALE: N/A	SHEET 1 OF 3
					A3

EXTERNAL GROUND

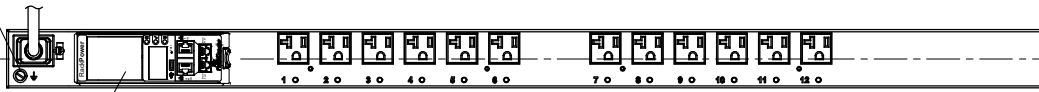

NMC SHOWN IN DEFAULT ORIENTATION

RECEPTACLE



NEMA 5 - 20R
16A, 125V MAX
RATED OUTPUT

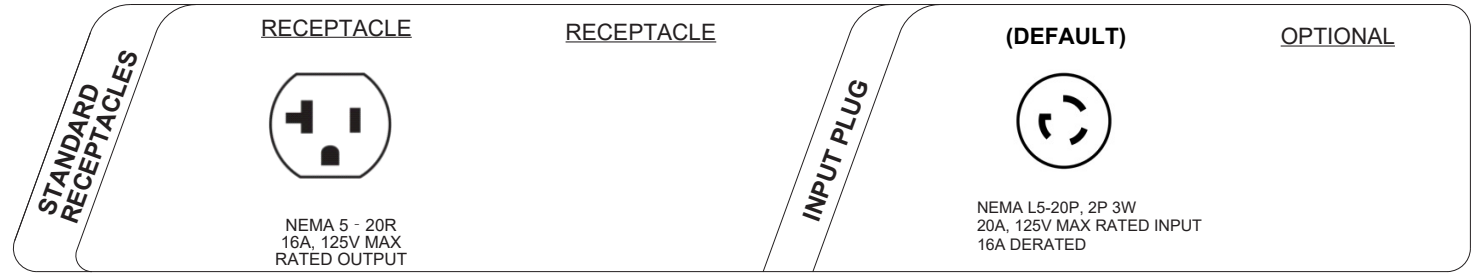

High Visibility Data Display

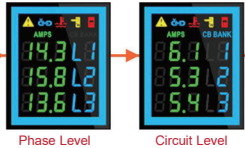

Critical Alarm Indicators

- PDU Alarm
- Cascade/Daisy Chain Alarm
- Environmental Beacon
- Security Alarm
- Circuit Breaker Alarm

Interactive Graphic Display



Dual Ethernet Port
For redundancy & cascading

Two Digital Sensor Port
Supports external sensors & peripherals

MOUNTING BUTTON

BUTTON MOUNTING SCREW
(INCLUDED)

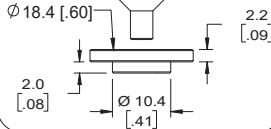

USB-C
Offline FW updates & Information Transfer

Gigabit Ethernet
Primary network communications

Tool-less Installation
Quick hot-swap or orientation changes



THIS DRAWING AND SPECIFICATIONS HEREIN ARE THE PROPERTY OF CIS GLOBAL AND SHALL NOT BE COPIED, REPRODUCED OR USED IN WHOLE OR IN PART, AS THE BASIS FOR THE MANUFACTURE OR SALE OF ITEMS WITHOUT WRITTEN PERMISSION FROM CIS GLOBAL. THIS DRAWING IS BASED UPON LATEST AVAILABLE INFORMATION AND IS SUBJECT TO CHANGE WITHOUT NOTICE

ECN-2210-0226	E2	REVISE METER ACCURACY AND ATTRIBUTES CONTENT	2022/10/08	LRF
	E1	INITIAL DRAFT REVIEW	2022/05/13	LRF
ECN/ECO	REV.	DESCRIPTION	DATE	APPROVED

REVISIONS			
TITLE:	UNLESS NOTED, DIMENSIONS ARE IN MILLIMETERS & TOLERANCES ARE:	PART NO:	REV.
Advantage Series Metered Switched	X: ±1 MM X*: ±1" X.X ±0.5 MM X.X* ±0.5" X.XX ±0.20 MM X.XX* ±0.5" ØX.X ±0.3 MM ØX.XX ±0.10 MM	RP2310WXYZ_DA	E2
		DRAWN BY: LRF	2022/05/13
PROJECT: RackPower	BRACKETED DIMENSIONS ARE IN INCHES FOR REFERENCE ONLY THIRD ANGLE PROJECTION INTERPRET PER ASME Y14.5M-1994	ENGINEER: LJB	2022/10/08
		APPROVED BY: Hanson	2022/10/08
		SCALE: N/A	SHEET 2 OF 3
			SIZE: A3

NOTES:
 1. INSTALLATION SHALL COMPLY WITH ALL APPLICABLE NATIONAL, STATE AND LOCAL CODES.
 2. SEE PRODUCT DOCUMENTATION FOR FURTHER INFORMATION

nvent | SCHROFF RackPower Distribution Unit **Metered Switched** Made In XXXXX (Factory ID: X)

SKU #: RP2310WXYZ
 Model #: EP23016-0020
 INPUT: 100-120VAC, 1PHASE, 50/60Hz, 16A
 OUTPUT: 5-20R; 100-120VAC, 16A per outlet
 16A Total

MAC0 Address: XX-XX-XX-XX-XX
 MAC1 Address: XX-XX-XX-XX-XX

THIS DEVICE COMPLIES WITH PART 15 OF THE FCC RULES. OPERATION IS SUBJECT TO THE FOLLOWING TWO CONDITIONS:
 (1) THIS DEVICE MAY NOT CAUSE HARMFUL INTERFERENCE, AND (2) THIS DEVICE MUST ACCEPT ANY INTERFERENCE RECEIVED, INCLUDING INTERFERENCE THAT MAY CAUSE UNDESIRABLE OPERATION.
 CAN ICES-3(A)/NMB-3(A)

UL LISTED I.T.E. E342720
 FC
 50

SKU# R P2310WXYZ
 Serial Number XXXXXXXX
 PRODUCT CODE XXXXXX

Mfr.Name:XXXXXXXXXXXXXXXXXXXXXXXXXXXX

- NOTES:
- INTERNAL WIRING:
 - WIRE TYPE: UL AWM 1015, 12 & 18AWG
 - LINE 1/R/X COLOR: BLACK
 - EARTH GROUND COLOR: GREEN/YELLOW STRIPE
 - NEUTRAL WIRE COLOR: WHITE
 - FOR FINISHED GOOD PART NUMBER SEE IDENTIFICATION

COMPLIANCE LABEL

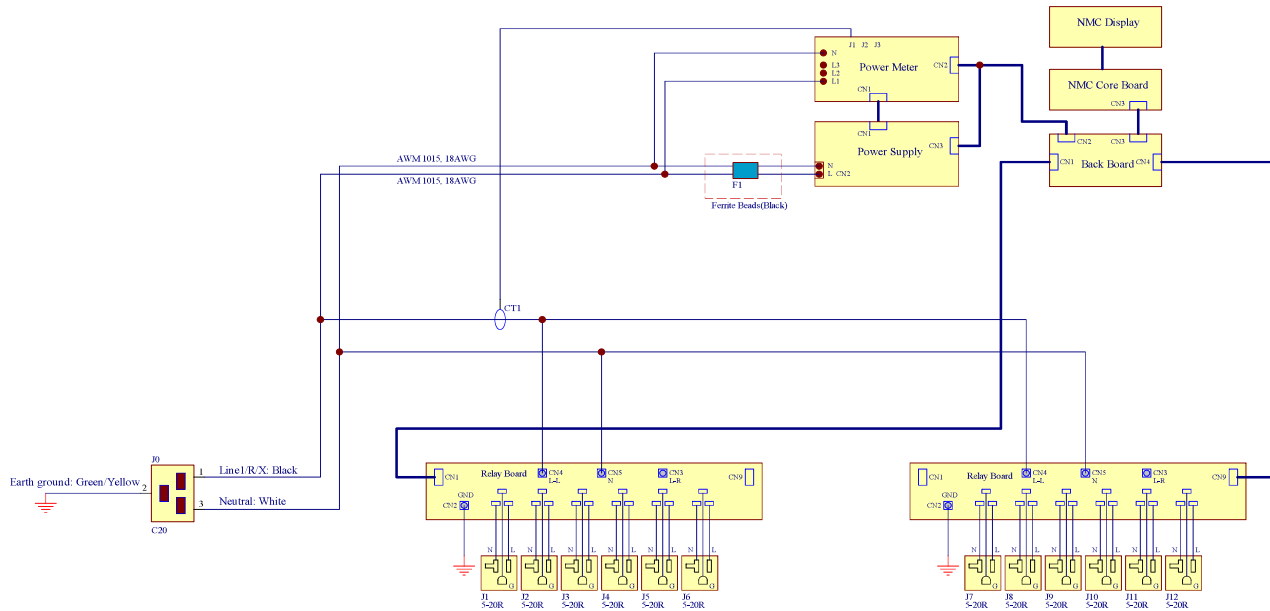

INTERNAL WIRING SCHEMATIC

- NOTES:
- INSTALLATION SHALL COMPLY WITH ALL APPLICABLE NATIONAL, STATE AND LOCAL CODES.
 - SEE PRODUCT DOCUMENTATION FOR FURTHER INFORMATION
 - THIS DRAWING DEPICTS THE POWER SYSTEM CONNECTIONS AND IS NOT REPRESENTATIVE OF THE PHYSICAL LAYOUT. PLEASE REFER TO MECHANICAL DRAWINGS FOR PHYSICAL LAYOUT.

nvent | SCHROFF

THIS DRAWING AND SPECIFICATIONS HEREIN ARE THE PROPERTY OF CIS GLOBAL AND SHALL NOT BE COPIED, REPRODUCED OR USED IN WHOLE OR IN PART, AS THE BASIS FOR THE MANUFACTURE OR SALE OF ITEMS WITHOUT WRITTEN PERMISSION FROM CIS GLOBAL. THIS DRAWING IS BASED UPON LATEST AVAILABLE INFORMATION AND IS SUBJECT TO CHANGE WITHOUT NOTICE

ECN-2210-0226	E2	REVISE METER ACCURACY AND ATTRIBUTES CONTENT	2022/10/08	LRF
	E1	INITIAL DRAFT REVIEW	2022/05/13	LRF
ECN/ECO	REV.	DESCRIPTION	DATE	APPROVED

REVISIONS				
TITLE: Advantage Series Metered Switched PROJECT: RackPower	UNLESS NOTED, DIMENSIONS ARE IN MILLIMETERS & TOLERANCES ARE: X. ±1 MM X* ±1" X.X ±0.5 MM X.X* ±0.5" X.XX ±0.20 MM ØX.X ±0.3 MM ØX.XX ±0.10 MM BRACKETED DIMENSIONS ARE IN INCHES FOR REFERENCE ONLY ③ THIRD ANGLE PROJECTION INTERPRET PER ASME Y14.5M-1994		PART NO: RP2310WXYZ_DA	REV. E2
			DRAWN BY: LRF	2022/05/13
			ENGINEER: LJB	2022/10/08
			APPROVED BY: Hanson	2022/10/08
			SCALE: N/A	SIZE: SHEET 3 OF 3 A3