

TECHNICAL SPECIFICATIONS	
UNIT TYPE:	MONITORED SWITCHED
ORIENTATION:	VERTICAL, OU MID
OUTLET QTY & TYPE:	(20)C13, (4)C19
INPUT VOLTAGE:	100-240VAC
INPUT CURRENT:	16A
BREAKER QTY & TYPE:	N/A
INPUT PHASE:	SINGLE-PHASE
RATED POWER:	3.7kVA
INPUT PLUG:	SEE NOTE 7
INPUT POWER CORD:	SEE IDENTIFICATION TABLE
FEATURES	
METERING ACCURACY	+/-1% TO ISO/ IEC 62052-21
METERING ATTRIBUTES	VOLTAGE(V), CURRENT(A), APPARENT POWER(kVA), REAL POWER(kW), POWER FACTOR, ENERGY(kWh)
METERED COMPONENTS	INPUT(PHASE)
REMOTE OUTLET SWITCHING	YES
ENVIRONMENTAL CONDITIONS	
OPERATING TEMPERATURE	-5 TO 60 C (23 TO 140 F)
STORAGE TEMPERATURE	-20 TO 60 C (-4 TO 140 F)
HUMIDITY (OPERATING/STORAGE)	5-90% RH / 5-95% RH; NON-CONDENSING
MAX OPERATING ELEVATION, ABOVE MSL	3000M(9840FT)
COMPLIANCE	
SAFETY&ENVIRONMENTAL	RoHS COMPLIANT

IDENTIFICATION TABLE	RP2326A	*	*	*	*
MODEL IS SHOWN IN DEFAULT CONFIGURATION. FOR OPTIONAL CONFIGURATIONS, USE ITEM IDENTIFIER CODE IN PLACE OF EACH ASTERISK. ORDERABLE BASED ON FORMAT: RP2326A**** DO NOT INCLUDE TRAILING ZEROS IN **** SUFFIX	INPUT PLUG (DEFAULT) 316P6(IP44)&L6-20P=0	CHASSIS COLOR (DEFAULT) BLACK = 0 BLUE = B RED = R WHITE = W GREEN = G YELLOW = Y	CORD OPTION (DEFAULT) 3m [10"] = 0 1m [3.2"] = 1 2m [6.6"] = 2	ORIENTATION (DEFAULT) TOP FEED = 0 BOTTOM FEED = 2	
OPTIONS LISTED ON THIS ROW ARE NON STANDARD. CONTACT SALES FOR ADDITIONAL INFORMATION		ORANGE = A	0.5m [1.6"] = A 1.2m [4"] = G 1.5m [4.9"] = B 1.8m [6"] = F 2.5m [8.2"] = C		

- NOTES :**
- INSTALLATION SHALL COMPLY WITH ALL APPLICABLE NATIONAL, STATE AND LOCAL CODES.
  - PRIMARY DIMENSIONS ARE IN MILLIMETERS. SECONDARY DIMENSIONS ARE IN [INCHES]
  - UNIVERSAL MOUNTING BRACKET IS AN ALTERNATIVE MOUNTING METHOD TO THE TOOLLESS MOUNT FOR 3RD PARTY ENCLOSURES. BRACKET IS PROVIDED WITH THE UNIT.
  - DETAILED INSTALLATION INSTRUCTIONS CAN BE FOUND IN THE QUICK START GUIDE
  - CONNECT EXTERNAL EARTH GROUND TO THE 10-32 SIZE THREADED NUT SEE PRODUCT DOCUMENTATION FOR FURTHER INFORMATION
  - INPUT PLUG CONFIGURATION (SEE IDENTIFICATION TABLE) FOR DUAL-RATED UNITS, NEMA PLUGS ARE NAM RATED ONLY AND CAPTIVE AUS/NZ PLUGS ARE EMEA RATED ONLY

THIS DRAWING AND SPECIFICATIONS HEREIN ARE THE PROPERTY OF CIS GLOBAL AND SHALL NOT BE COPIED, REPRODUCED OR USED IN WHOLE OR IN PART, AS THE BASIS FOR THE MANUFACTURE OR SALE OF ITEMS WITHOUT WRITTEN PERMISSION FROM CIS GLOBAL. THIS DRAWING IS BASED UPON LATEST AVAILABLE INFORMATION AND IS SUBJECT TO CHANGE WITHOUT NOTICE

ECN/ECNO	REV.	DESCRIPTION	DATE	APPROVED
ECN-2210-0226	E2	REVISE METER ACCURACY AND ATTRIBUTES CONTENT	2022/10/08	LRF
	E1	INITIAL DRAFT REVIEW	2022/05/06	Leo Liu

REVISIONS	
TITLE :	UNLESS NOTED, DIMENSIONS ARE IN MILLIMETERS & TOLERANCES ARE: X ±1 MM X° ±1° X.X ±0.5 MM X.X° ±0.5° X ±0.20 MM Ø X.X ±0.3 MM Ø X.XX ±0.10 MM
PROJECT :	BRACKETED DIMENSIONS ARE IN INCHES FOR REFERENCE ONLY ⊕ THRID ANGLE PROJECTION INTERPRET PER ASME Y14.5M-1994
	PART NO: RP2326WXYZ_DA REV. E1 DRAWN BY: Leo Liu 2022/05/06 ENGINEER: LJB 2022/10/08 APPROVED BY: Hanson 2022/10/08
	SCALE : N/A SHEET 1 OF 3 SIZE: A3

EXTERNAL GROUND

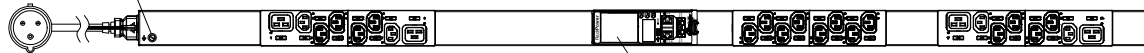

NMC SHOWN IN  
DEFAULT ORIENTATION

**RECEPTACLE**

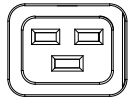

IEC 60320/C19  
16A, 250V MAX  
RATED OUTPUT

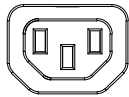

IEC 60320/C13  
10A, 250V MAX  
RATED OUTPUT

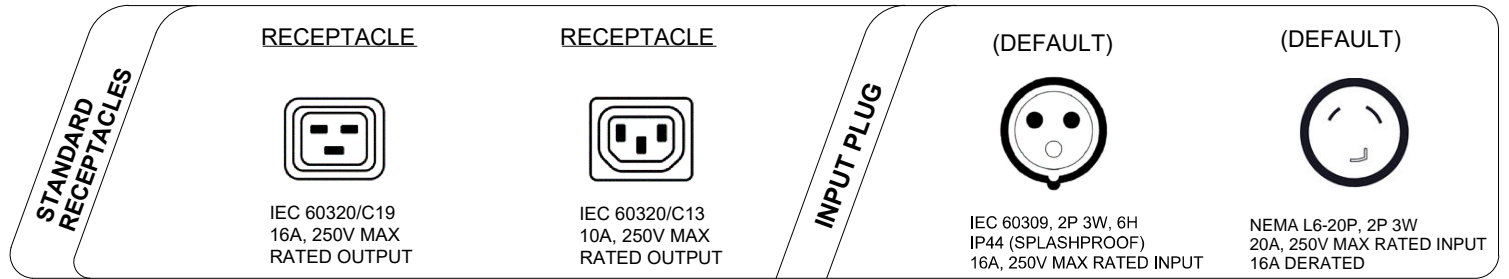

RECEPTACLE

RECEPTACLE

(DEFAULT)

(DEFAULT)

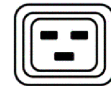

IEC 60320/C19  
16A, 250V MAX  
RATED OUTPUT



IEC 60320/C13  
10A, 250V MAX  
RATED OUTPUT



IEC 60309, 2P 3W, 6H  
IP44 (SPLASHPROOF)  
16A, 250V MAX RATED INPUT



NEMA L6-20P, 2P 3W  
20A, 250V MAX RATED INPUT  
16A DERATED

**High Visibility Data Display**

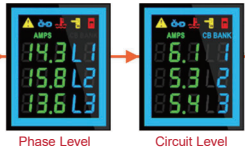

**Critical Alarm Indicators**

- PDU Alarm
- Cascade/Daisy Chain Alarm
- Environmental Beacon
- Security Alarm
- Circuit Breaker Alarm

**Interactive Graphic Display**



**MOUNTING BUTTON**

BUTTON MOUNTING SCREW  
(INCLUDED)

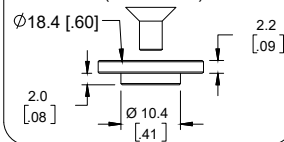

**USB-C**

Offline FW updates & Information Transfer

**Gigabit Ethernet**

Primary network communications

**Tool-less Installation**

Quick hot-swap or orientation changes



**Dual Ethernet Port**

For redundancy & cascading

**Two Digital Sensor Port**

Supports external sensors & peripherals

**NOTES :**

1. INSTALLATION SHALL COMPLY WITH ALL APPLICABLE NATIONAL, STATE AND LOCAL CODES.
2. SEE PRODUCT DOCUMENTATION FOR FURTHER INFORMATION



THIS DRAWING AND SPECIFICATIONS HEREIN ARE THE PROPERTY OF CIS GLOBAL AND SHALL NOT BE COPIED, REPRODUCED OR USED IN WHOLE OR IN PART, AS THE BASIS FOR THE MANUFACTURE OR SALE OF ITEMS WITHOUT WRITTEN PERMISSION FROM CIS GLOBAL. THIS DRAWING IS BASED UPON LATEST AVAILABLE INFORMATION AND IS SUBJECT TO CHANGE WITHOUT NOTICE

ECN-2210-0226	E2	REVISE METER ACCURACY AND ATTRIBUTES CONTENT	2022/10/08	LRF
	E1	INITIAL DRAFT REVIEW	2022/05/06	Leo Liu
ECN/ECO	REV.	DESCRIPTION	DATE	APPROVED

**REVISIONS**

<b>TITLE :</b>  Advantage Series Metered Switched	UNLESS NOTED, DIMENSIONS ARE IN MILLIMETERS & TOLERANCES ARE: X ±1 MM    X" ±1" X.X ±0.5 MM    X.X" ±0.5" X ±0.20 MM X ±0.3 MM Ø X.X ±0.10 MM	<b>PART NO:</b> RP2326 WXYZ_DA	<b>REV.:</b> E2
		<b>DRAWN BY:</b> Leo Liu	2022/05/06
		<b>ENGINEER:</b> LJB	2022/10/08
		<b>APPROVED BY:</b> Hanson	2022/10/08
<b>PROJECT :</b> RackPower	BRACKETED DIMENSIONS ARE IN INCHES FOR REFERENCE ONLY THRID ANGLE PROJECTION INTERPRET PER ASME Y14.5M-1994	SCALE : N/A	SHEET 2 OF 3

SIZE:  
A3

**nvent | SCHROFF**  
**SKU #: RP2326WXYZ**  
**Model #: EP25016-0013**  
**INPUT: 100-240VAC, 1PHASE, 50/60Hz, 16A**  
**OUTPUT: C13; 100-240VAC, 10A per outlet**  
**16A Total**  
**MAC0 Address: XX-XX-XX-XX-XX-XX**  
**MAC1 Address: XX-XX-XX-XX-XX-XX**

Metered Switched

Made In XXXXX (Factory ID: X)

THIS DEVICE COMPLIES WITH PART 15 OF THE FCC RULES. OPERATION IS SUBJECT TO THE FOLLOWING TWO CONDITIONS: (1) THIS DEVICE MAY NOT CAUSE HARMFUL INTERFERENCE, AND (2) THIS DEVICE MUST ACCEPT ANY INTERFERENCE RECEIVED, INCLUDING INTERFERENCE THAT MAY CAUSE UNDESIRE OPERATION. CAN ICES-3(A)/NMB-3(A)

CE UK CA FC 50 D LISTED I.T.E. E342720

SKU# R P2326 WXYZ  
 Serial Number XXXXXXXX  
 PRODUCT CODE XXXXX  
 XXXXX

nVent Electric plc  
 1665 Utica Ave, Suite 700  
 Minneapolis, MN 55416  
 Mfr.Name:XXXXXXXXXXXXXXXXXXXXXXXXXXXX

**NOTES:**

- INTERNAL WIRING:  
 WIRE TYPE: AWM 1015, 12 & 18AWG  
 LINE 1/R/X COLOR: BROWN  
 EARTH GROUND COLOR: GREEN/YELLOW STRIPE  
 NEUTRAL WIRE COLOR: BLUE
- FOR FINISHED GOOD PART NUMBER & DESCRIPTION

**COMPLIANCE LABEL**

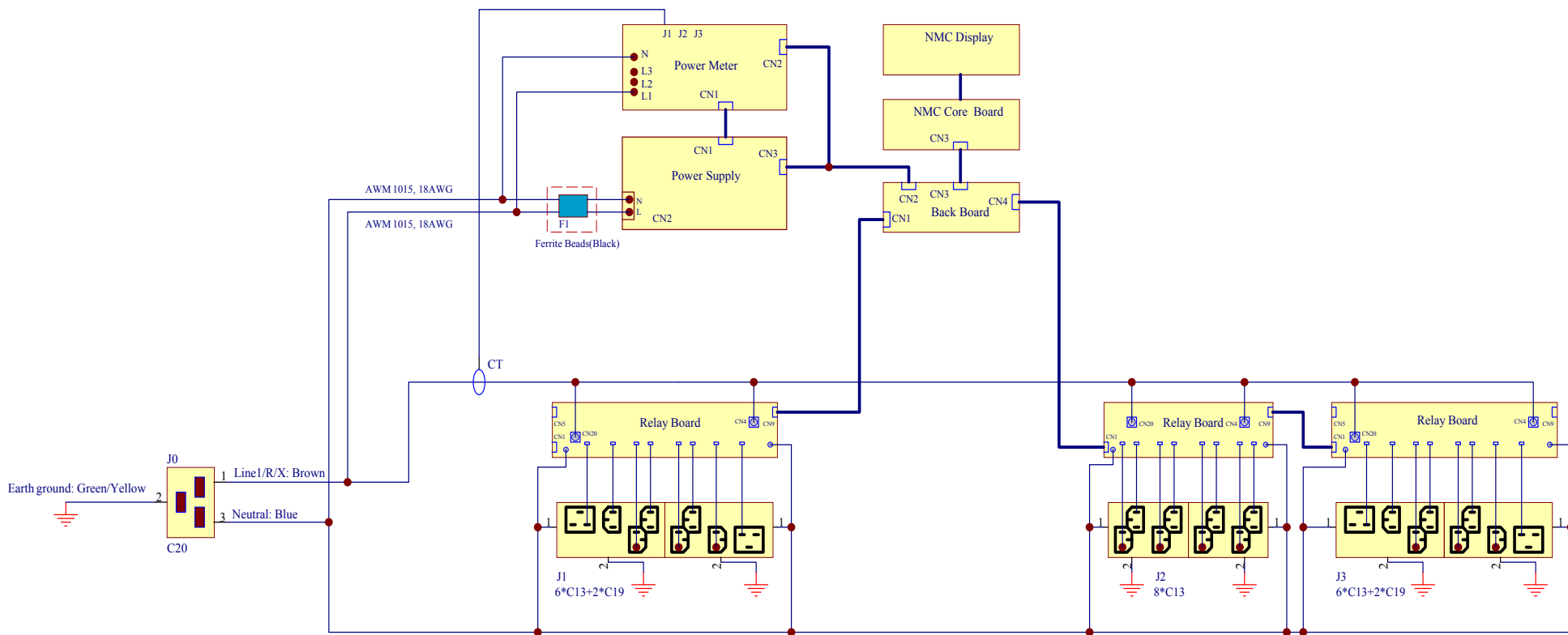

**INTERNAL WIRING SCHEMATIC DIAGRAM**

- NOTES:**
- INSTALLATION SHALL COMPLY WITH ALL APPLICABLE NATIONAL, STATE AND LOCAL CODES.
  - SEE PRODUCT DOCUMENTATION FOR FURTHER INFORMATION.
  - THIS DRAWING DEPICTS THE POWER SYSTEM CONNECTIONS AND IS NOT REPRESENTATIVE OF THE PHYSICAL LAYOUT. PLEASE REFER TO MECHANICAL DRAWINGS FOR PHYSICAL LAYOUT.

**nvent | SCHROFF**

THIS DRAWING AND SPECIFICATIONS HEREIN ARE THE PROPERTY OF CIS GLOBAL AND SHALL NOT BE COPIED, REPRODUCED OR USED IN WHOLE OR IN PART, AS THE BASIS FOR THE MANUFACTURE OR SALE OF ITEMS WITHOUT WRITTEN PERMISSION FROM CIS GLOBAL. THIS DRAWING IS BASED UPON LATEST AVAILABLE INFORMATION AND IS SUBJECT TO CHANGE WITHOUT NOTICE

ECN-2210-0226	E2	REVISE METER ACCURACY AND ATTRIBUTES CONTENT	2022/10/08	LRF
	E1	INITIAL DRAFT REVIEW	2022/05/06	Leo Liu
ECN/ECO	REV.	DESCRIPTION	DATE	APPROVED
<b>REVISIONS</b>				
<b>TITLE :</b>		UNLESS NOTED, DIMENSIONS ARE IN MILLIMETERS & TOLERANCES ARE:	<b>PART NO:</b>	
Advantage Series Metered Switched		X ±1 MM	X' ±1"	RP2326 WXYZ_DA
		XX ±0.5 MM	XX' ±0.5"	<b>REV.:</b> E2
PROJECT : <b>RackPower</b>		X ±0.20 MM	<b>DRAWN BY:</b> Leo Liu	
		Ø XX ±0.3 MM	<b>ENGINEER:</b> LJB	
		Ø XXX ±0.10 MM	<b>APPROVED BY:</b> Hanson	
		BRACKETED DIMENSIONS ARE IN INCHES FOR REFERENCE ONLY		<b>SCALE :</b> N/A
		THIRD ANGLE PROJECTION		<b>SHEET</b> 3 OF 3
		INTERPRET PER ASME Y14.5M-1994		<b>SIZE:</b> A3