

TECHNICAL SPECIFICATIONS	
UNIT TYPE:	MONITORED & SWITCHED PER OUTLET
ORIENTATION:	VERTICAL, 0U FULL
OUTLET QTY & TYPE:	(20)C13, (4)C19
INPUT VOLTAGE:	100-240VAC
INPUT CURRENT:	32A
BREAKER QTY & TYPE:	(2)16AMP, SINGLE-POLE
INPUT PHASE:	SINGLE-PHASE
RATED POWER:	7.4 KVA
INPUT PLUG:	SEE NOTE 7
INPUT POWER CORD:	SEE IDENTIFICATION TABLE
FEATURES	
METERING ACCURACY	+1% TO ISO/ IEC 62052-21
METERING ATTRIBUTES	VOLTAGE(V), CURRENT(A), APPARENT POWER(kVA), REAL POWER(kW), POWER FACTOR, ENERGY(kWh)
METERED COMPONENTS	INPUT(PHASE), CIRCUIT BREAKERS, OUTLETS
REMOTE OUTLET SWITCHING	YES
ENVIRONMENTAL CONDITIONS	
OPERATING TEMPERATURE	-5 TO 60 C (23 TO 140 F)
STORAGE TEMPERATURE	-20 TO 60 C (-4 TO 140 F)
HUMIDITY (OPERATING/STORAGE)	5-90% RH / 5-95% RH; NON-CONDENSING
MAX OPERATING ELEVATION, ABOVE MSL	3000M(9840FT)
COMPLIANCE	
SAFETY&ENVIRONMENTAL	RoHS COMPLIANT

IDENTIFICATION TABLE	RP 6325	*	*	*	*
MODEL IS SHOWN IN DEFAULT CONFIGURATION. FOR OPTIONAL CONFIGURATIONS, USE ITEM IDENTIFIER CODE IN PLACE OF EACH ASTERISK. ORDERABLE BASED ON FORMAT: RP6325**** DO NOT INCLUDE TRAILING ZEROS IN **** SUFFIX	INPUT PLUG (DEFAULT) 332P6(IP44) = 0	CHASSIS COLOR (DEFAULT) BLACK = 0 BLUE = B RED = R WHITE = W GREEN = G YELLOW = Y	CORD OPTION (DEFAULT) 3m [10'] = 0 1m [3.2'] = 1 2m [6.6'] = 2	ORIENTATION (DEFAULT) TOP FEED = 0 BOTTOM FEED = 2	
OPTIONS LISTED ON THIS ROW ARE NON STANDARD. CONTACT SALES FOR ADDITIONAL INFORMATION		ORANGE = A	0.5m [1.6'] = A 1.2m [4'] = G 1.5m [4.9'] = B 1.8m [6'] = F 2.5m [8.2'] = C		

- NOTES:**
- INSTALLATION SHALL COMPLY WITH ALL APPLICABLE NATIONAL, STATE AND LOCAL CODES.
  - PRIMARY DIMENSIONS ARE IN MILLIMETERS. SECONDARY DIMENSIONS ARE IN [INCHES]
  - UNIVERSAL MOUNTING BRACKET IS AN ALTERNATIVE MOUNTING METHOD TO THE TOOLLESS MOUNT FOR 3RD PARTY ENCLOSURES. BRACKET IS PROVIDED WITH THE UNIT.
  - DETAILED INSTALLATION INSTRUCTIONS CAN BE FOUND IN THE QUICK START GUIDE
  - CONNECT EXTERNAL EARTH GROUND TO THE 10-32 SIZE THREADED NUT SEE PRODUCT DOCUMENTATION FOR FURTHER INFORMATION
  - INPUT PLUG CONFIGURATION (SEE IDENTIFICATION TABLE) FOR DUAL-RATED UNITS, NEMA PLUGS ARE NAM RATED ONLY AND CAPTIVE AUS/NZ PLUGS ARE EMEA RATED ONLY

THIS DRAWING AND SPECIFICATIONS HEREIN ARE THE PROPERTY OF CIS GLOBAL AND SHALL NOT BE COPIED, REPRODUCED OR USED IN WHOLE OR IN PART, AS THE BASIS FOR THE MANUFACTURE OR SALE OF ITEMS WITHOUT WRITTEN PERMISSION FROM CIS GLOBAL. THIS DRAWING IS BASED UPON LATEST AVAILABLE INFORMATION AND IS SUBJECT TO CHANGE WITHOUT NOTICE

ECN/ECNO	REV.	DESCRIPTION	DATE	APPROVED
ECN-2210-0226	E2	REVISE METER ACCURACY AND ATTRIBUTES CONTENT	2022/10/08	LRF
	E1	INITIAL DRAFT REVIEW	2022/05/13	LRF

REVISIONS											
TITLE:	Advantage Series Metered & Switched per outlet										
PROJECT:	RackPower										
UNLESS NOTED, DIMENSIONS ARE IN MILLIMETERS & TOLERANCES ARE:	<table border="0"> <tr> <td>X ±1 MM</td> <td>X' ±1"</td> </tr> <tr> <td>.XX ±0.5 MM</td> <td>.X.X' ±0.5"</td> </tr> <tr> <td>X ±0.20 MM</td> <td></td> </tr> <tr> <td>Ø XX ±0.3 MM</td> <td></td> </tr> <tr> <td>Ø XXX ±0.10 MM</td> <td></td> </tr> </table>	X ±1 MM	X' ±1"	.XX ±0.5 MM	.X.X' ±0.5"	X ±0.20 MM		Ø XX ±0.3 MM		Ø XXX ±0.10 MM	
X ±1 MM	X' ±1"										
.XX ±0.5 MM	.X.X' ±0.5"										
X ±0.20 MM											
Ø XX ±0.3 MM											
Ø XXX ±0.10 MM											
BRACKETED DIMENSIONS ARE IN INCHES FOR REFERENCE ONLY											
THIRD ANGLE PROJECTION											
INTERPRET PER ASME Y14.5M-1994											

  

PART NO:	REV.
RP6325WXYZ_DA	E2
DRAWN BY:	LRF 2022/05/13
ENGINEER:	LJB 2022/10/08
APPROVED BY:	Hanson 2022/10/08

SCALE: N/A	SHEET 1 OF 3	SIZE: A3
------------	--------------	----------

EXTERNAL GROUND

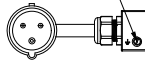

16 AMP, SINGLE-POLE ELECTRO MECHANICAL SWITCH / BREAKER(2) PLACES

NMC SHOWN IN DEFAULT ORIENTATION

**RECEPTACLE**

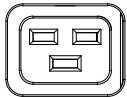

IEC 60320/C19  
16A, 250V MAX  
RATED OUTPUT

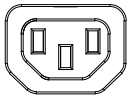

IEC 60320/C13  
10A, 250V MAX  
RATED OUTPUT

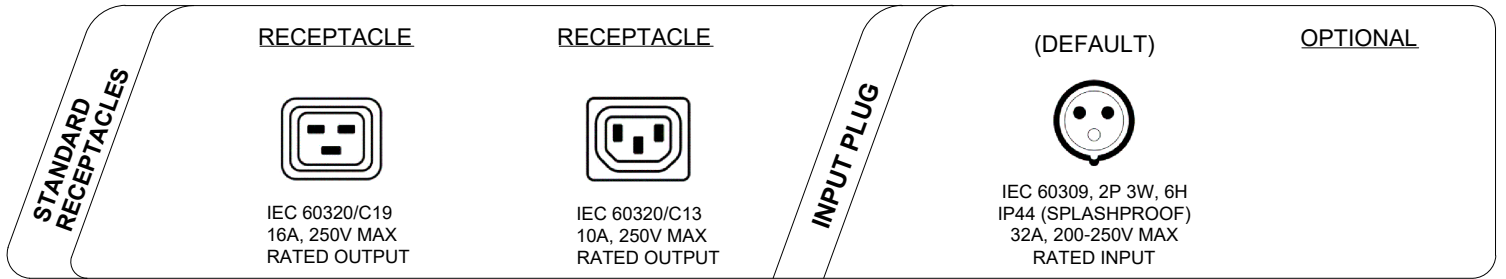

**High Visibility Data Display**

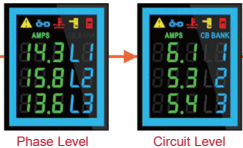

**Critical Alarm Indicators**

- PDU Alarm
- Cascade/Daisy Chain Alarm
- Environmental Beacon
- Security Alarm
- Circuit Breaker Alarm

**Interactive Graphic Display**



**USB-C**

Offline FW updates & Information Transfer

**Gigabit Ethernet**

Primary network communications

**Tool-less Installation**

Quick hot-swap or orientation changes

**MOUNTING BUTTON**

BUTTON MOUNTING SCREW (INCLUDED)

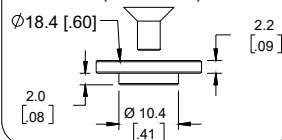

- NOTES :**
- INSTALLATION SHALL COMPLY WITH ALL APPLICABLE NATIONAL, STATE AND LOCAL CODES.
  - SEE PRODUCT DOCUMENTATION FOR FURTHER INFORMATION



THIS DRAWING AND SPECIFICATIONS HEREIN ARE THE PROPERTY OF CIS GLOBAL AND SHALL NOT BE COPIED, REPRODUCED OR USED IN WHOLE OR IN PART, AS THE BASIS FOR THE MANUFACTURE OR SALE OF ITEMS WITHOUT WRITTEN PERMISSION FROM CIS GLOBAL. THIS DRAWING IS BASED UPON LATEST AVAILABLE INFORMATION AND IS SUBJECT TO CHANGE WITHOUT NOTICE

ECN-2210-0226	E2	REVISE METER ACCURACY AND ATTRIBUTES CONTENT	2022/10/08	LRF
	E1	INITIAL DRAFT REVIEW	2022/05/13	LRF
ECN/ECO	REV.	DESCRIPTION	DATE	APPROVED

**REVISIONS**

<b>TITLE :</b> Advantage Series Metered & Switched per outlet	UNLESS NOTED, DIMENSIONS ARE IN MILLIMETERS & TOLERANCES ARE:		<b>PART NO:</b> RP6325WXYZ_DA	<b>REV.:</b> E2
	X ±1 MM	X" ±1"	<b>DRAWN BY:</b> LRF	2022/05/13
	X.X ±0.5 MM	X.X" ±0.5"	<b>ENGINEER:</b> LJB	2022/10/08
	X ±0.20 MM		<b>APPROVED BY:</b> Hanson	2022/10/08
<b>PROJECT :</b> RackPower	BRACKETED DIMENSIONS ARE IN INCHES FOR REFERENCE ONLY		SCALE : N/A	
	THIRD ANGLE PROJECTION		SHEET 2 OF 3	
	INTERPRET PER ASME Y14.5M-1994		SIZE: A3	

**nvent | SCHROFF** RackPower Distribution Unit  
 Metered & Switched per outlet  
 Made In XXXXX

SKU #: RP6325WXYZ  
 Model #: EP65032-0013  
 INPUT: 100-240VAC, 1PHASE, 50/60Hz, 32A  
 OUTPUT: C13; 100-240VAC, 10A per outlet  
 C19; 100-240VAC, 16A per outlet  
 32A Total

MAC0 Address: XX-XX-XX-XX-XX-XX  
 MAC1 Address: XX-XX-XX-XX-XX-XX

Mfr. Name: XXXXXXXXXXXXXXXXXXXXXXXXX

CE UKCA

150V

SKU# R6325WXYZ  
 Serial Number XXXXXXXX  
 PRODUCT CODE XXXXXX

NOTES:  
 1. INTERNAL WIRING

WIRE TYPE: UL AWM 1015, 10 & 12 & 18AWG  
 LINE 1/R/X COLOR: BROWN  
 EARTH GROUND COLOR: GREEN/YELLOW STRIPE  
 NEUTRAL WIRE COLOR: BLUE

COMPLIANCE LABEL

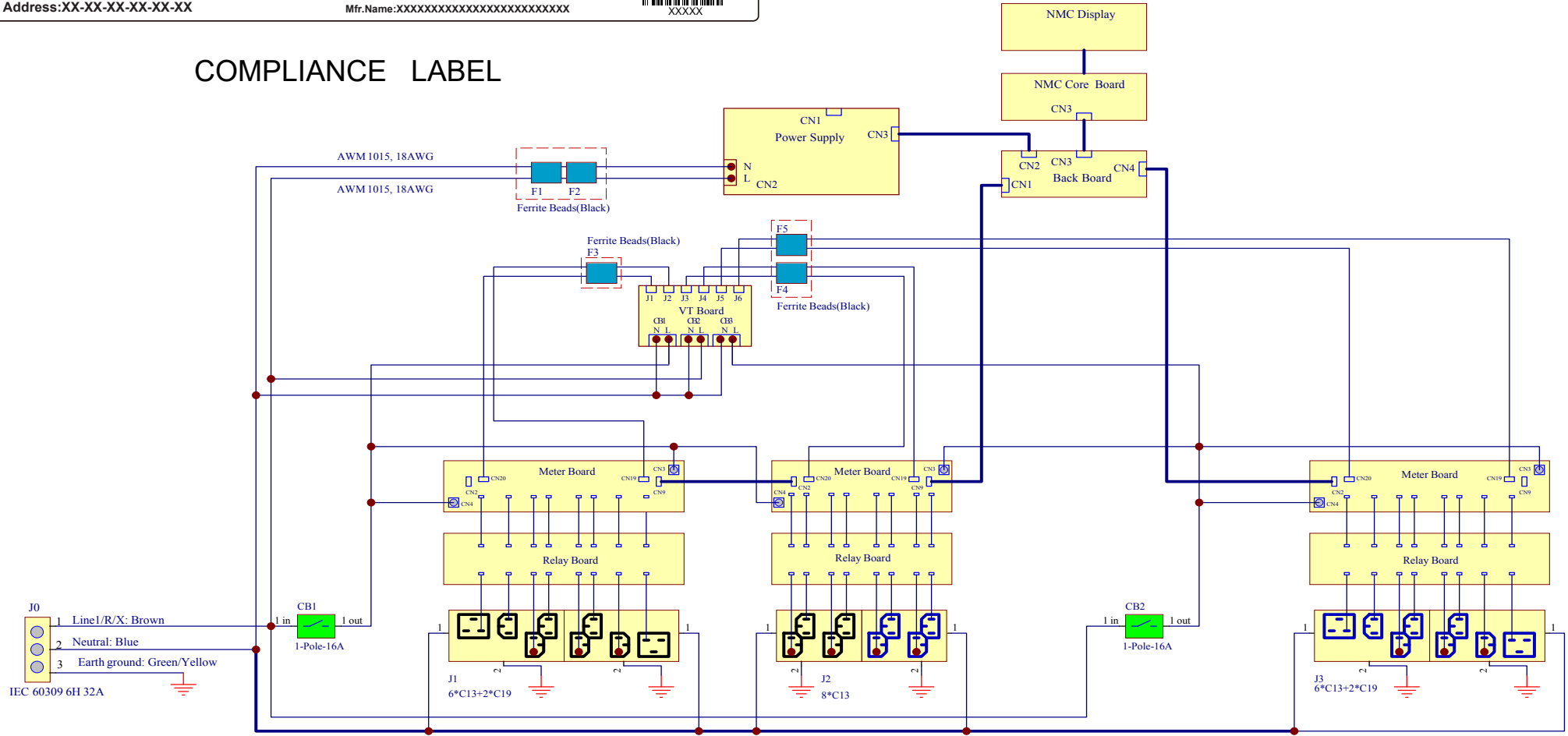

INTERNAL WIRING SCHEMATIC DIAGRAM

ECN-2210-0226	E2	REVISE METER ACCURACY AND ATTRIBUTES CONTENT	2022/10/08	LRF
	E1	INITIAL DRAFT REVIEW	2022/05/13	LRF
ECN/ECO	REV.	DESCRIPTION	DATE	APPROVED

- NOTES:
1. INSTALLATION SHALL COMPLY WITH ALL APPLICABLE NATIONAL, STATE AND LOCAL CODES.
  2. SEE PRODUCT DOCUMENTATION FOR FURTHER INFORMATION.
  3. THIS DRAWING DEPICTS THE POWER SYSTEM CONNECTIONS AND IS NOT REPRESENTATIVE OF THE PHYSICAL LAYOUT. PLEASE REFER TO MECHANICAL DRAWINGS FOR PHYSICAL LAYOUT.

**nvent | SCHROFF**

THIS DRAWING AND SPECIFICATIONS HEREIN ARE THE PROPERTY OF CIS GLOBAL AND SHALL NOT BE COPIED, REPRODUCED OR USED IN WHOLE OR IN PART, AS THE BASIS FOR THE MANUFACTURE OR SALE OF ITEMS WITHOUT WRITTEN PERMISSION FROM CIS GLOBAL. THIS DRAWING IS BASED UPON LATEST AVAILABLE INFORMATION AND IS SUBJECT TO CHANGE WITHOUT NOTICE

**Advantage Series**  
 Metered & Switched per outlet

**PROJECT: RackPower**

UNLESS NOTED, DIMENSIONS ARE IN MILLIMETERS & TOLERANCES ARE:  
 X ±1 MM X' ±1"  
 X.X ±0.5 MM X.X' ±0.5"  
 X ±0.20 MM  
 X.X ±0.3 MM  
 Ø X.XX ±0.10 MM

BRACKETED DIMENSIONS ARE IN INCHES FOR REFERENCE ONLY  
 THRID ANGLE PROJECTION  
 INTERPRET PER ASME Y14.5M-1994

PART NO: RP6325WXYZ\_DA  
 REV: E2  
 DRAWN BY: LRF  
 ENGINEER: LJB  
 APPROVED BY: Hanson

SCALE: N/A  
 SHEET 3 OF 3  
 SIZE: A3