

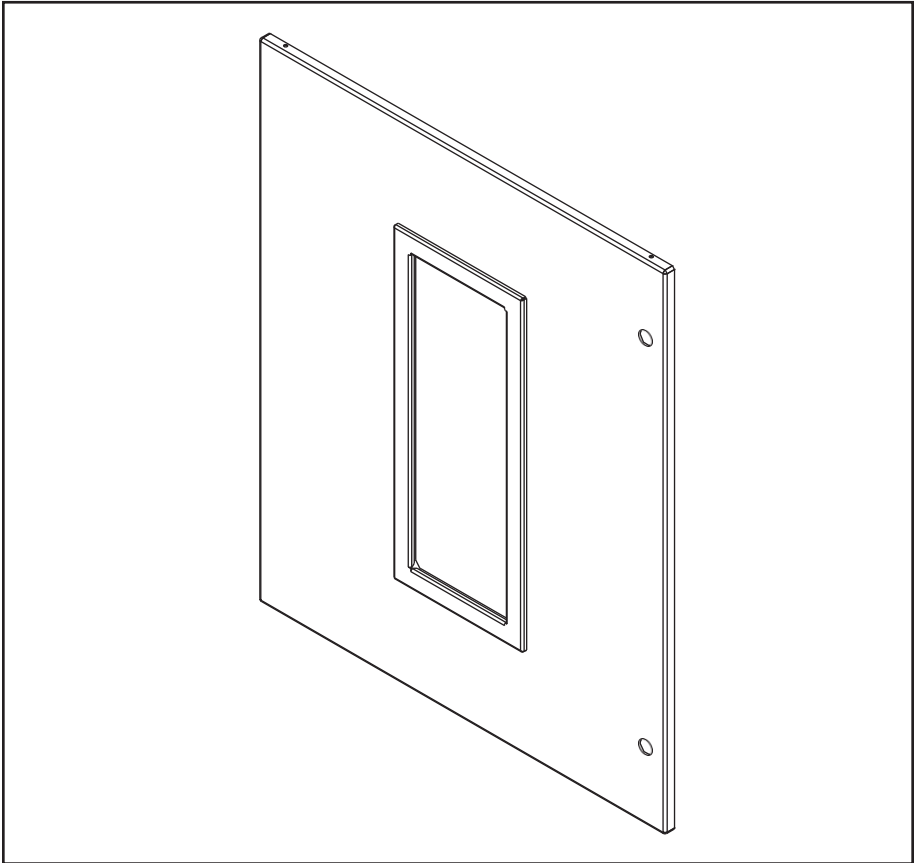

HOFFMAN

ZONEX™

Type EXWK ** Range of Window Kit Accessory



WARNING	AVERTISSEMENT	ADVERTENCIA
	<p>To avoid electric shock and equipment damage, disconnect any power supplies to the enclosure before installing the window kit. Do not energize any circuits before all internal and external electrical and mechanical clearances are checked to assure that all assembled equipment functions safely and properly.</p> <p>Pour éviter la décharge électrique et les dommages aux équipements, débrancher toutes les alimentations d'énergie au boîtier avant d'installer le Kit De Fenêtre. N'activer aucun circuit avant que des dégagements électriques et mécaniques tout internes et externes soient vérifiés pour s'assurer que tout l'équipement assemblé fonctionne sans risque et correctement.</p> <p>Para evitar descarga eléctrica y el equipo dañar, desconectar cualquier fuente de poder a la caja antes de instalar el juego de la ventana. No energizar ninguna circuitos antes de que las separaciones eléctricas y mecánicas todo internas y externas se comprueben para asegurar que funcione todo el equipo montado con seguridad y correctamente.</p>	

ATEX ATEX Directive 2014/34/EU Equipment for explosive atmospheres	IECEx	UKCA UK SI 2016:1107 Equipment and Protective Systems Intended for Use in Potentially Explosive Atmosphere Regulations
Certificate: Sira 13ATEX3315U II 2 GD Ex eb IIC Gb Ex tb IIIC Db IP 66 EN IEC 60079-0 EN 60079-7 EN 60079-31	Certificate: IECEx SIR 13.0123U Ex eb IIC Gb Ex tb IIIC Db IP 66 IEC 60079-0 IEC 60079-7 IEC 60079-31	Certificate: CSAE 21UKEX3371U II 2 GD Ex eb IIC Gb Ex tb IIIC Db IP66 EN IEC 60079-0 EN 60079-7 EN 60079-31

Attestation of Conformity

Please visit www.hoffman.nvent.com for the current version of the Attestation of Conformity.

Schedule of Limitation

Please refer to the appropriate certificate listed in the table above for the Schedule of Limitation.

1. The Type EXWK Range of Window Kit Accessory incorporates one of the following two gaskets, therefore the applicable limiting temperatures are as follows:

Gasket fitted	Limiting service temperature
HT800	-55°C to +180°C
U1E21	-40°C to +70°C

2. The fasteners must be secured with a minimum torque of 1.7 Nm and a maximum torque of 2.3 Nm
3. In order to minimize the risk of electrostatic discharge, when the window frame is painted, the following limitations apply:
 - i. Remove the explosive atmosphere prior to contact or cleaning.
 - ii. Make certain enclosure and window frame are grounded and external enclosure ground connection is made; all conducting parts should be properly bonded.
 - iii. For painted surfaces, avoid friction with surface; only clean with wet cloth moistened with deionized water.
 - iv. Avoid contact in low relative humidity environments. Increase environment humidity where possible.

Catalog No. Référence catalogue Número de catálogo	Cutout size Découpe size Perforación size in. (mm)
EXWK53SS6	6.69 x 4.69 (170 x 119)
EXWK95SS6	10.69 x 7.19 (272 x 183)
EXWK715SS6	16.69 x 8.69 (424 x 221)
EXWK138SS6	14.69 x 9.69 (373 x 246)
EXWK1711SS6	18.69 x 12.69 (475 x 322)
EXWK2315SS6	24.69 x 16.69 (627 x 424)
EXWK2919SS6	30.69 x 20.69 (780 x 526)
EXWK711SS6	8.69 x 12.69 (221 x 322)
EXWK720SS6	8.69 x 21.69 (221 x 551)
EXWK724SS6	8.69 x 25.69 (221 x 653)
EXWK729SS6	8.69 x 30.69 (221 x 780)

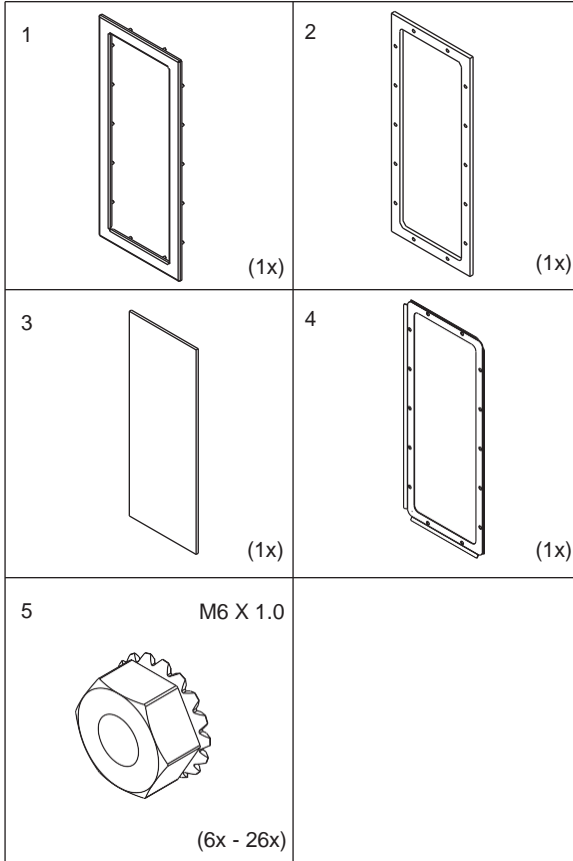

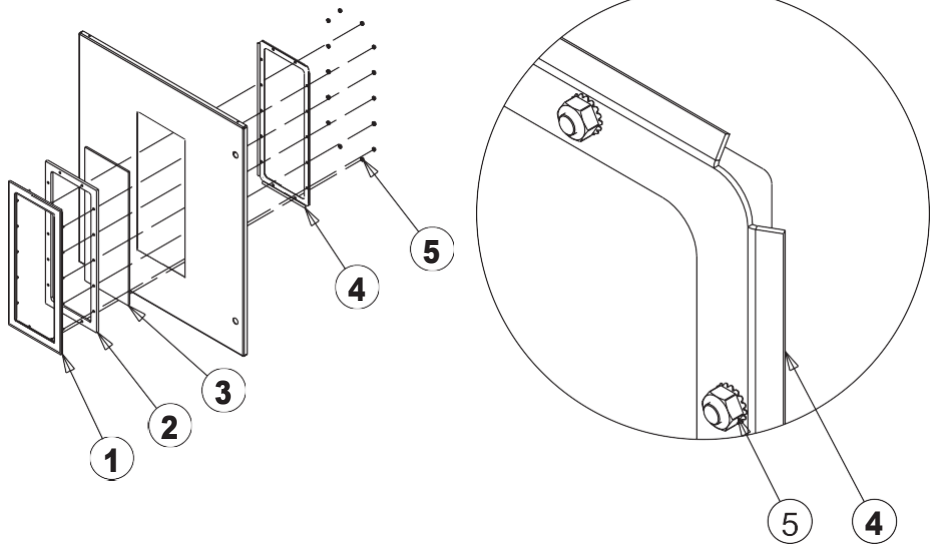

Instructions:

1. Window kit is compatible with enclosure thicknesses between .053 in. (1.3 mm) and .125 in. (3.2 mm).
2. Make a rectangular cutout of appropriate size where the window is to be mounted. See table for recommended opening size.
3. Remove the plastic from both sides of the window.
4. Place the window in the frame within the stud perimeter.
5. Place the frame and window against the enclosure with the studs protruding through the opening.
6. Attach retainer plate, flanges down, with nuts to inside of enclosure. Align the window, and tighten all nuts to 15-20 in-lbs (1.7-2.3 Nm) of torque.