

Floor standing enclosures

Mild steel flange mount disconnect MCF

MOUNTING INSTRUCTIONS
7697-0502-31 REV. 5

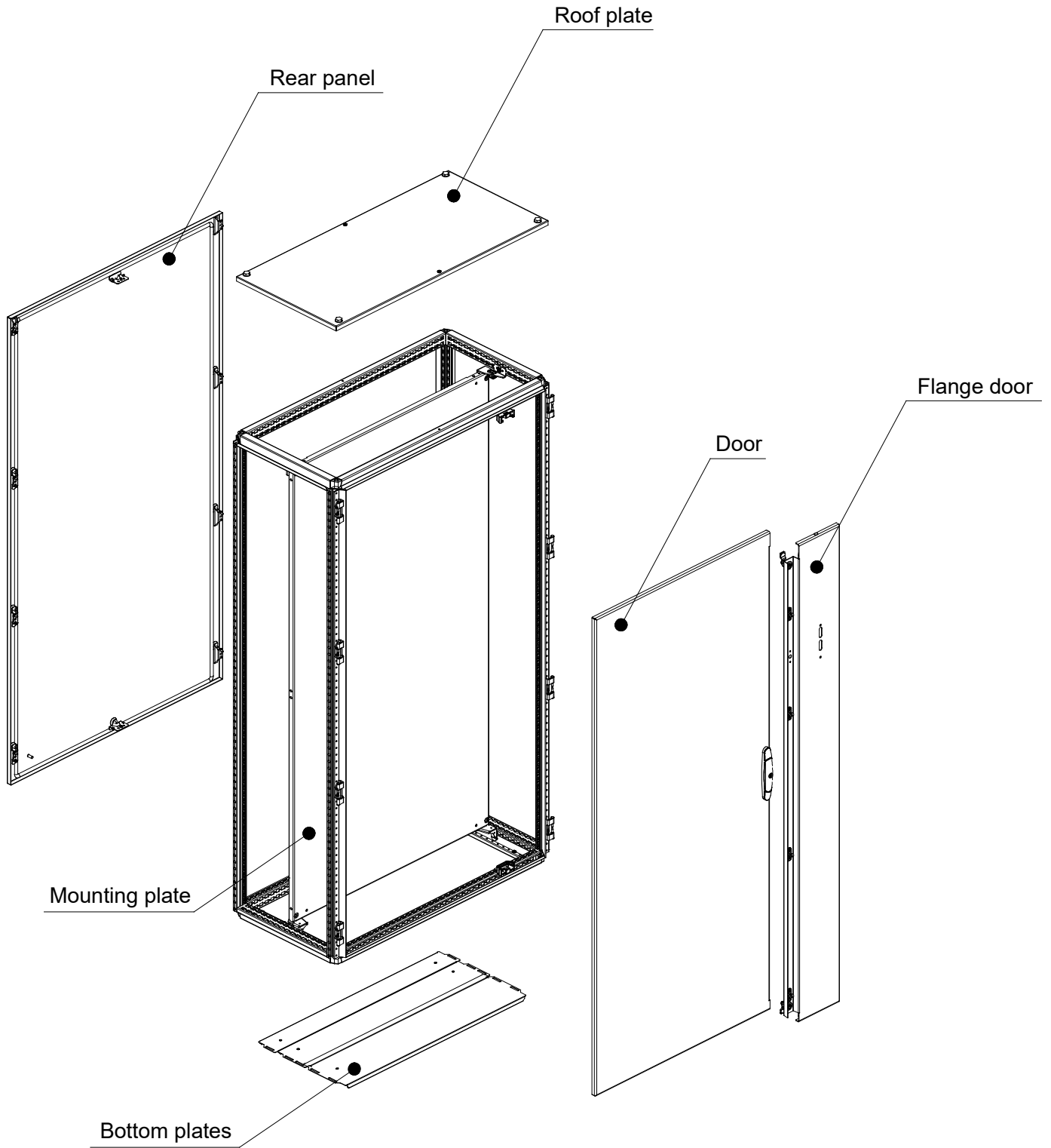



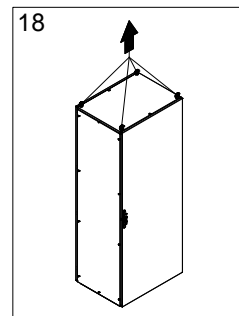
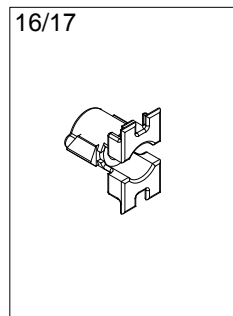
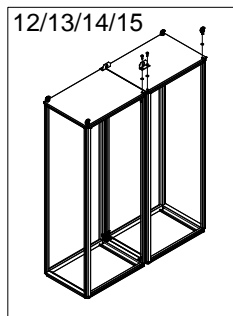
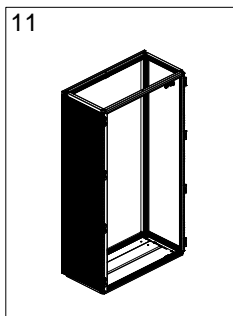
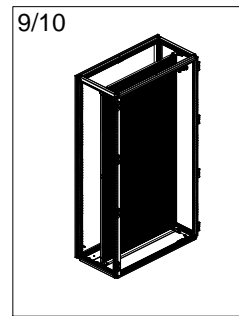
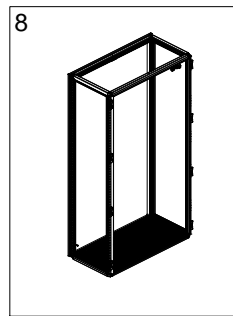
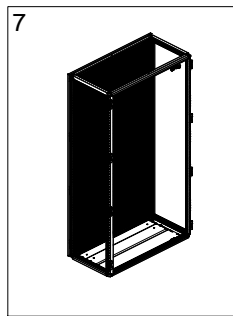
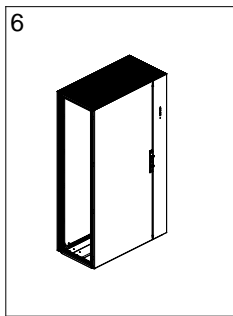
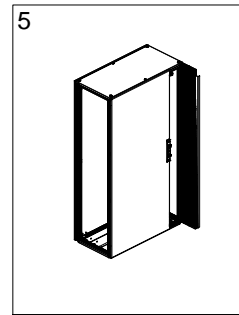
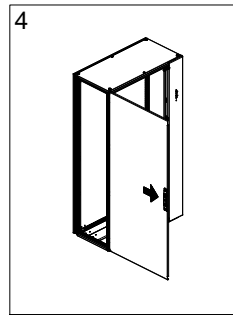
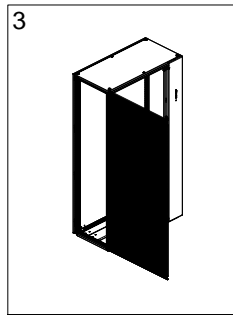
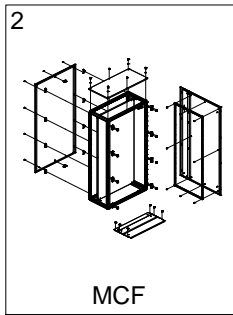

WARNING: When mounting on or over a combustible surface, a floor plate of at least 1.43 mm galvanized or 1.6 mm uncoated steel extended at least 150 mm beyond the equipment on all sides must be installed.

WARNING: In order to maintain the environmental integrity of the enclosure, devices with the same environmental ratings shall be used to close openings in customized enclosure.

MCF

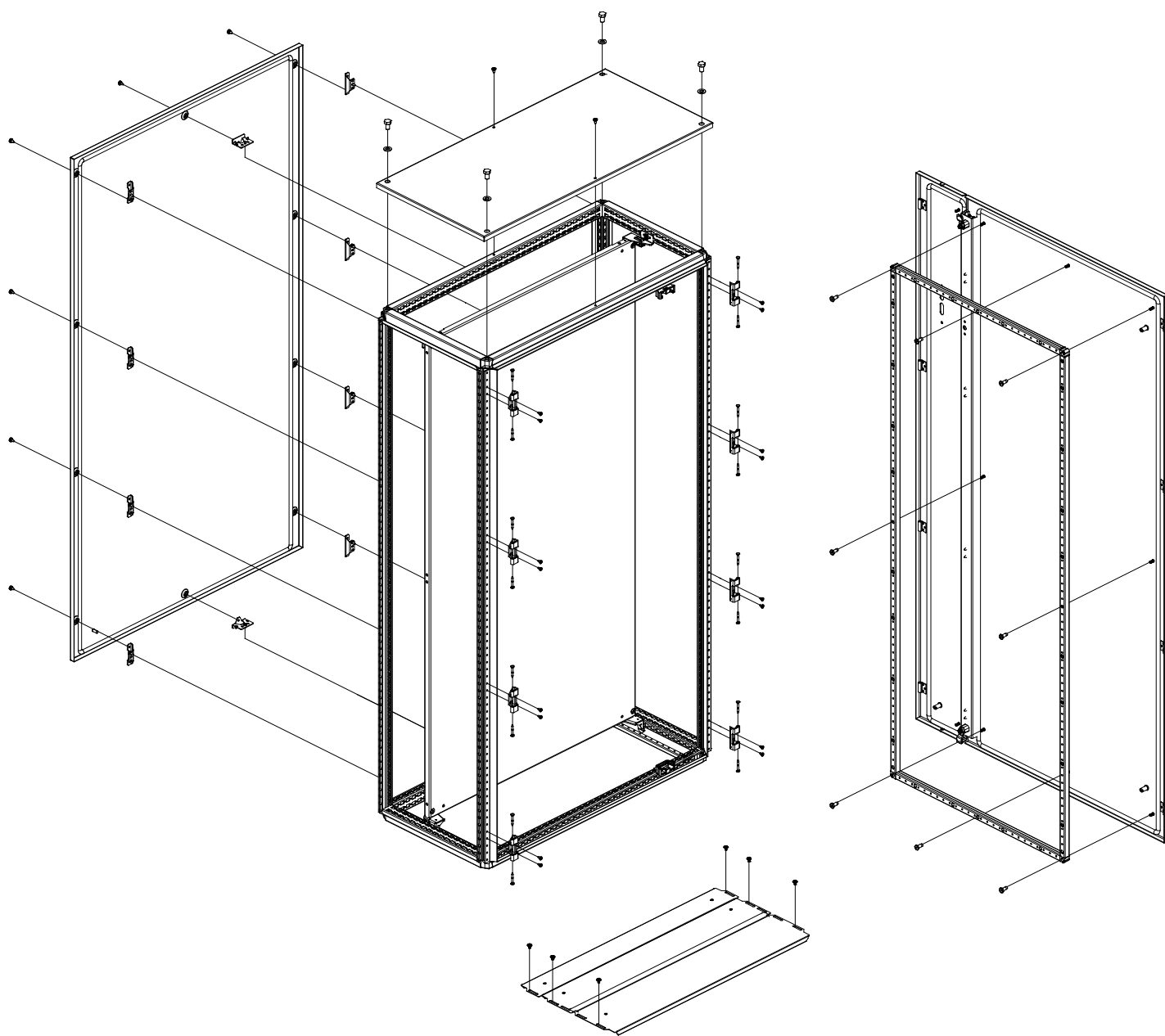

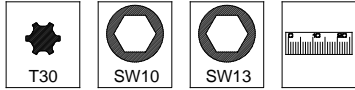

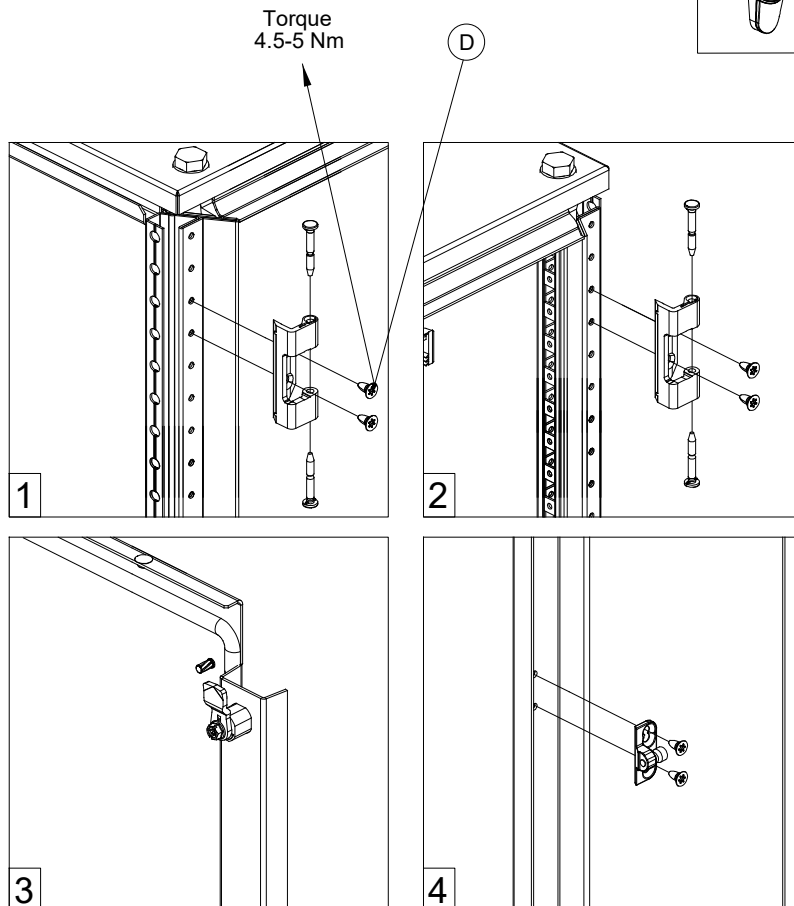
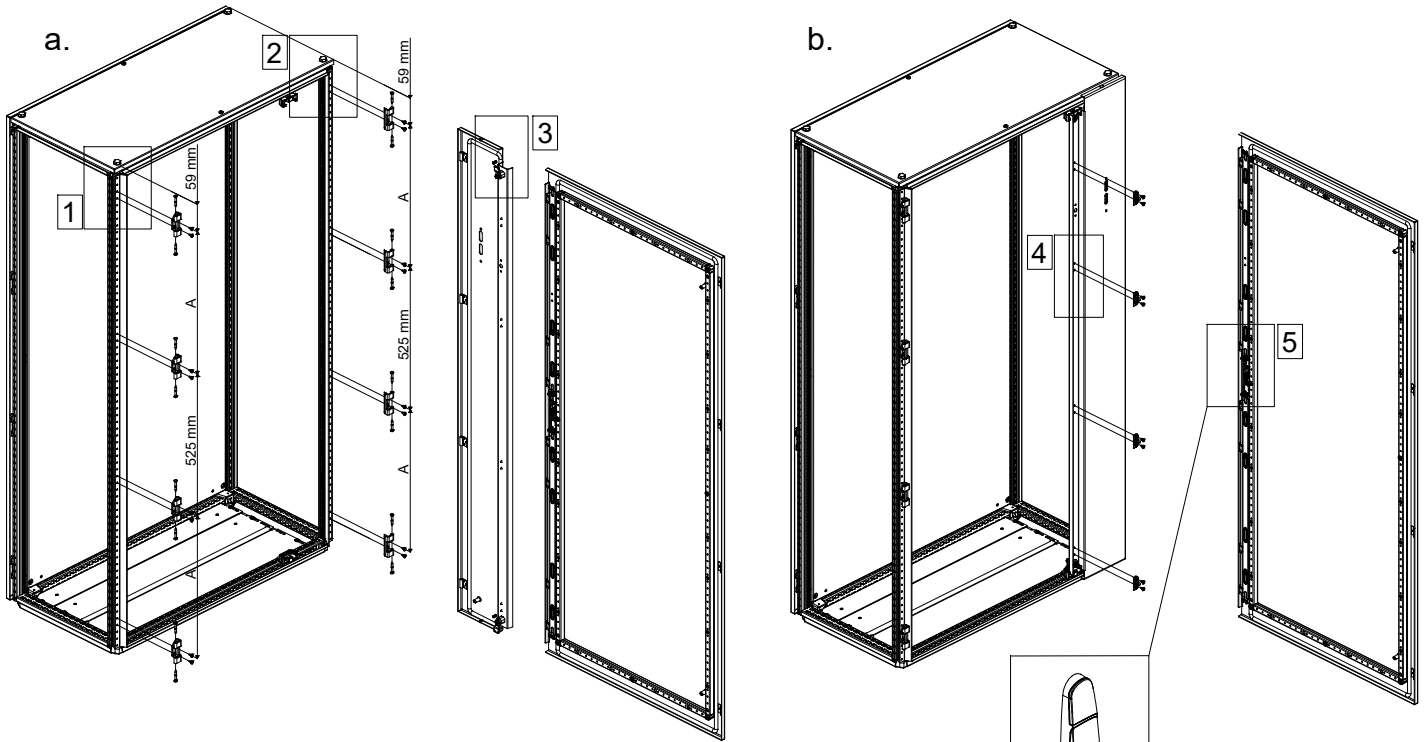

COMBINABLE ENCLOSURE

H	A
1800	525
2000	625





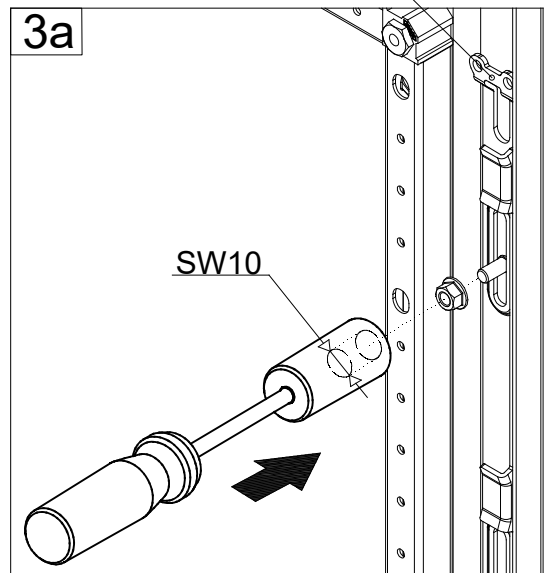
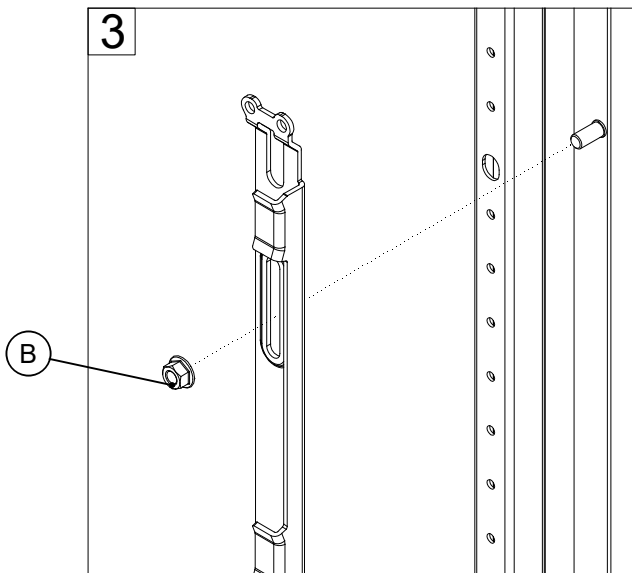
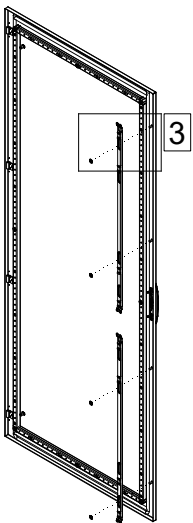
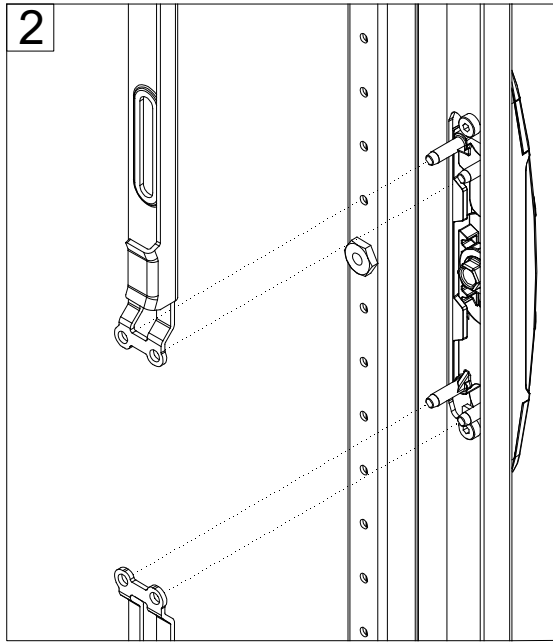
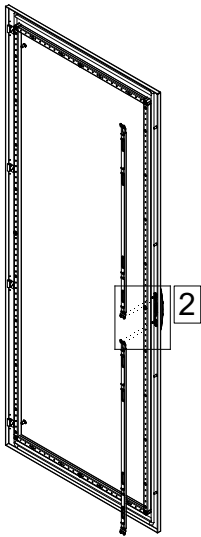
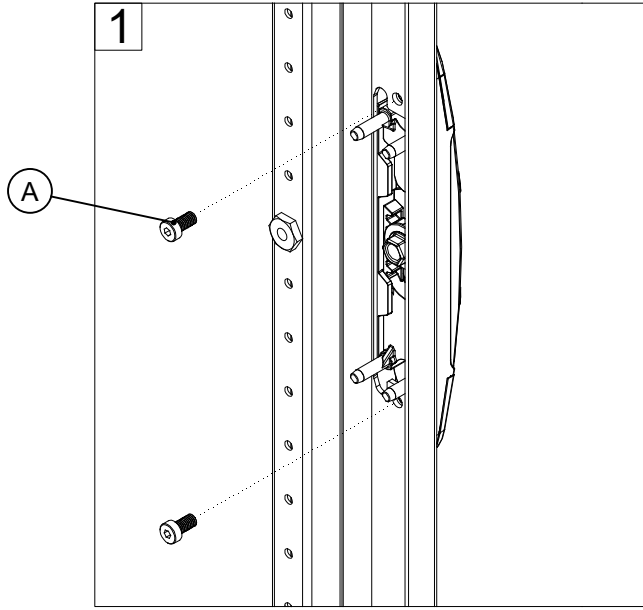
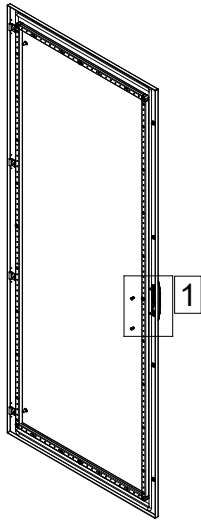

Ref.	Pic.	Qty.
A	 M5x10	2
B	 M5	4





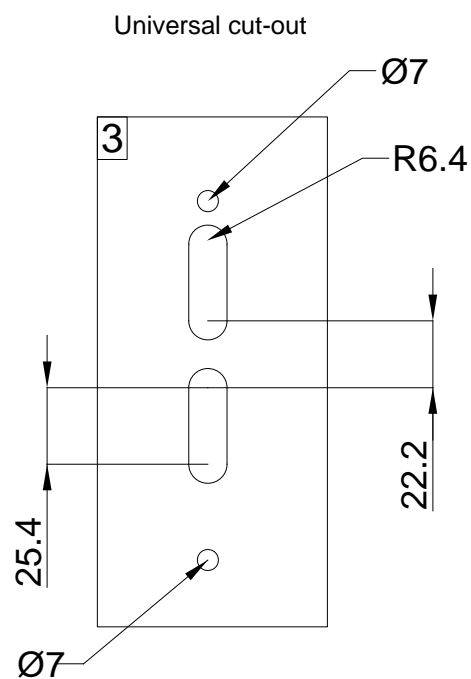
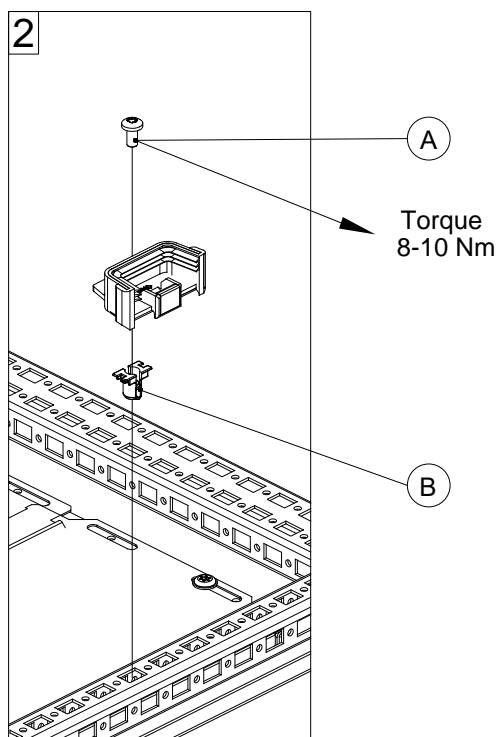
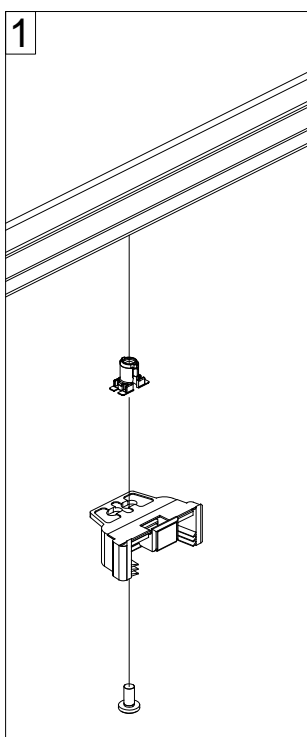
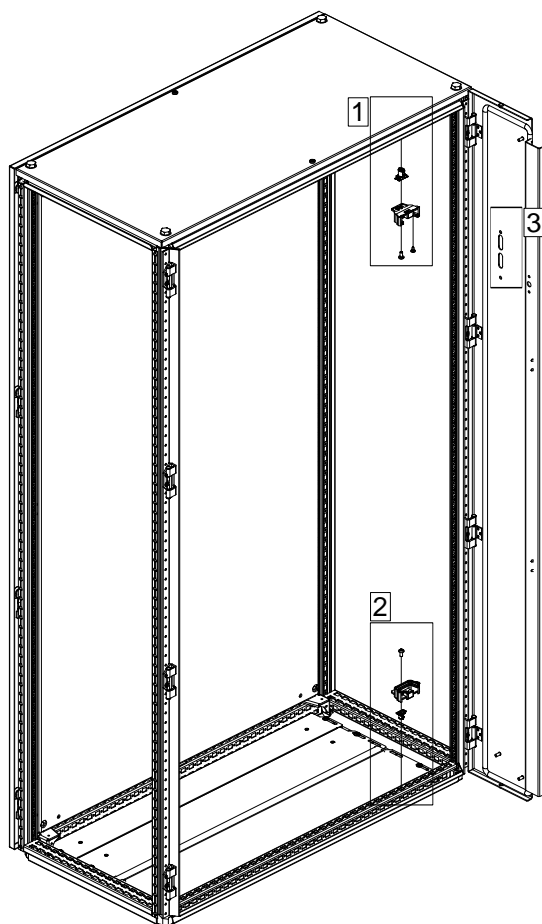

MCF-Flange door

Ref.	Pic.	Qty.
A	 M6x12	2
B	 M6	2





MCF-Top Panel

Ref.	Pic.	Qty.
A	 M6x12	2
B	 M12x20	4
C	 M12	4

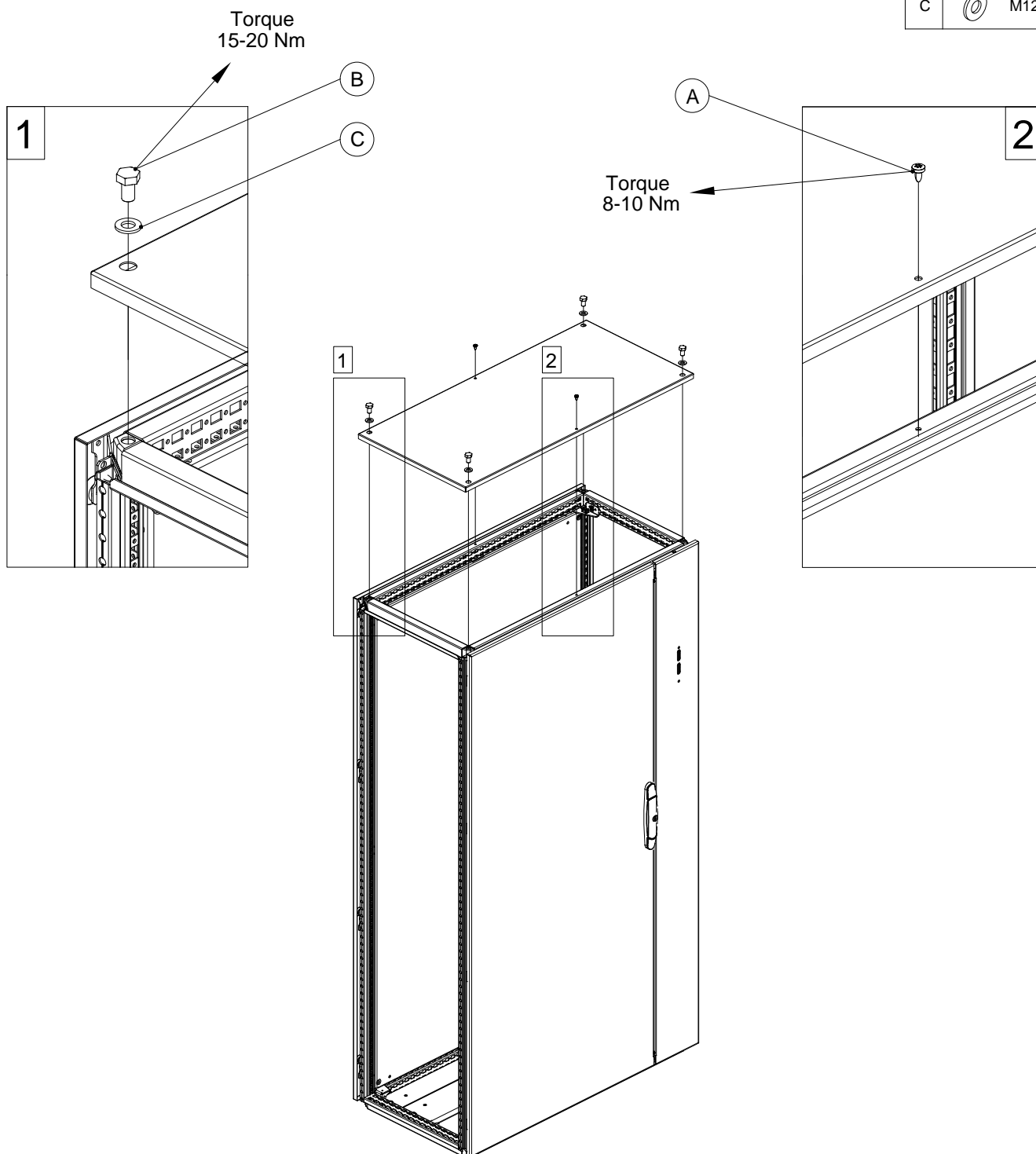

MCF-Rear Panel



Ref.	Pic.	W (mm)	<1000	≥1000
A		M5x10	-	2
B		M6x12	22	24

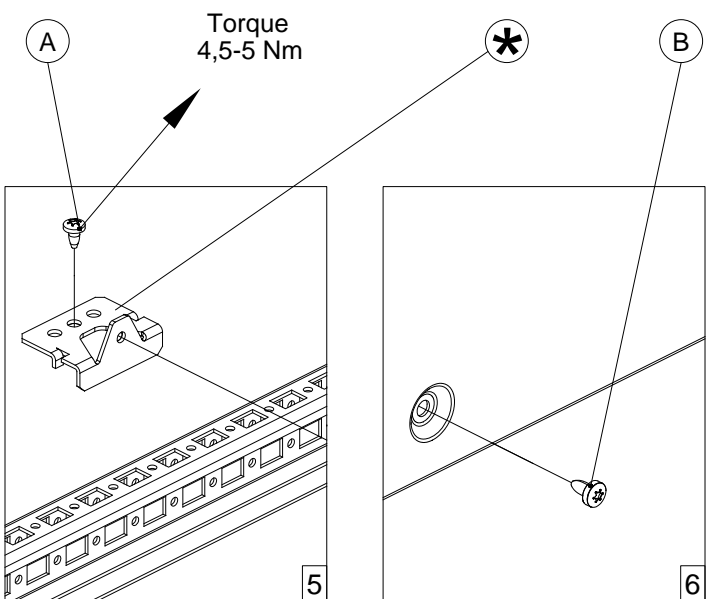
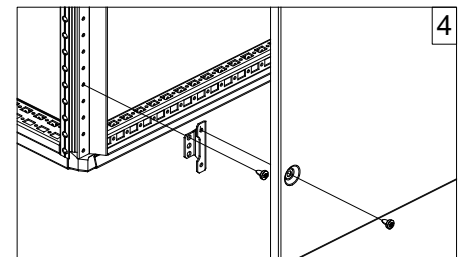
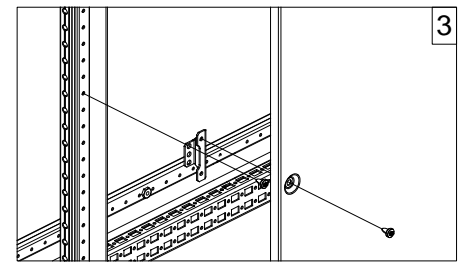
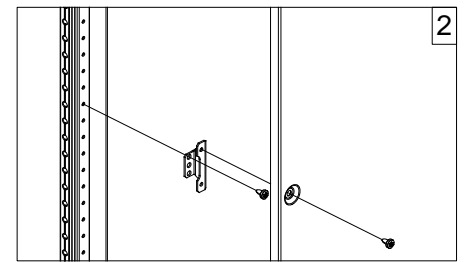
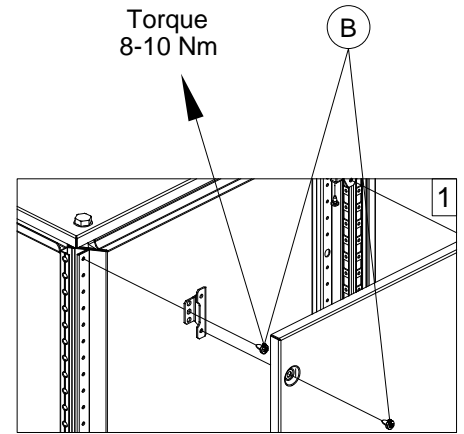
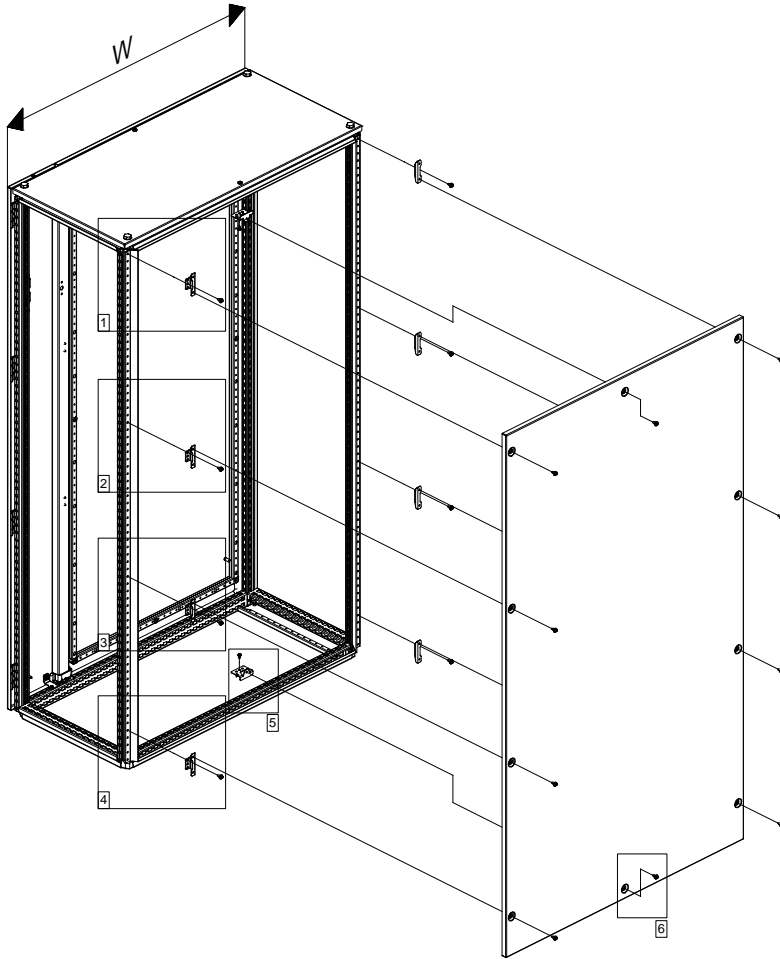

* - Used on enclosures 1000mm and 1200mm wide.



MCF

Ref.	Pic.	Qty.
A	St. 5.5x10	6
B		5

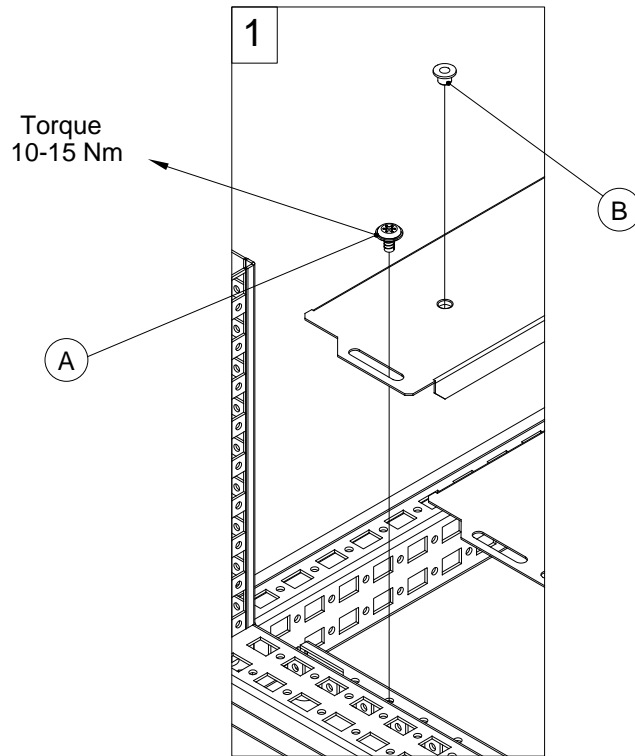
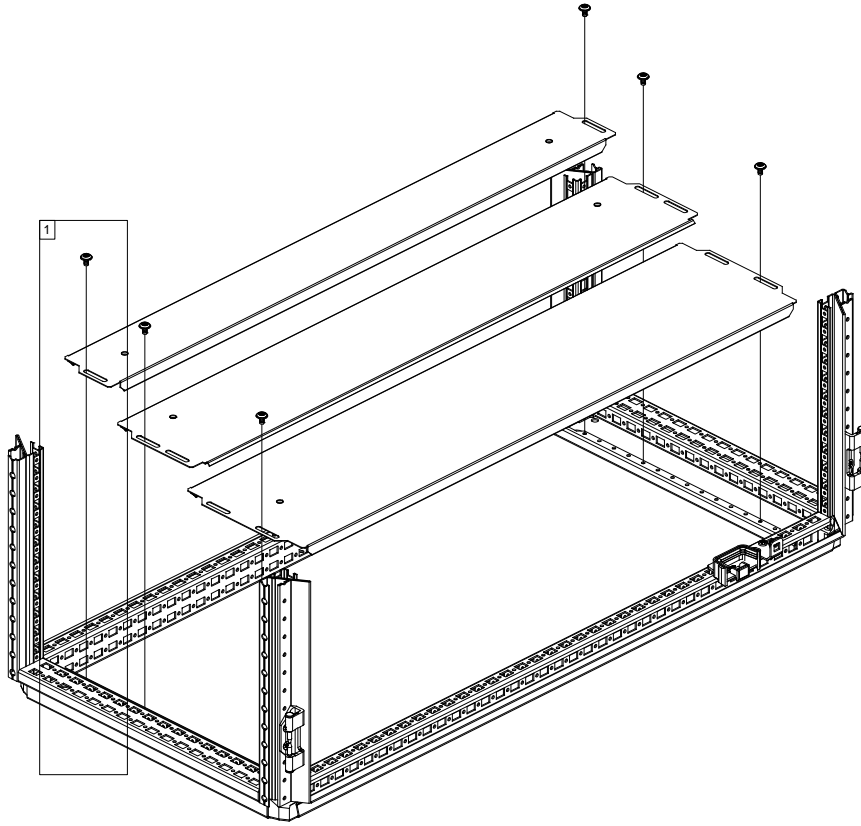



MOUNTING PLATE

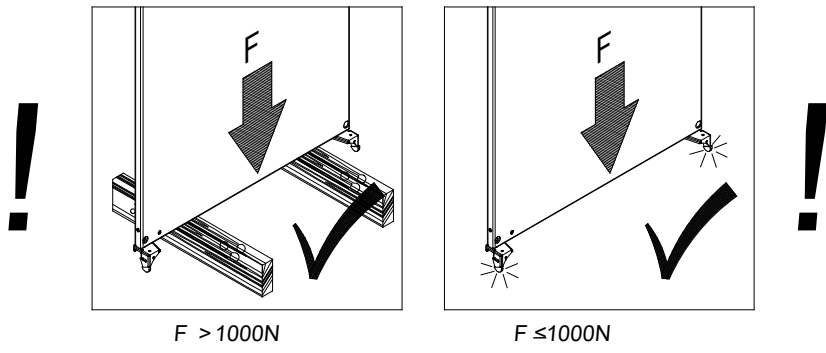

Ref.	Pic.	Qty.
A	M8x16	2
B	M8x16	2
C		2
D	Bottom right	1
E	Bottom left	1
F	Top right	1
G	Top left	1

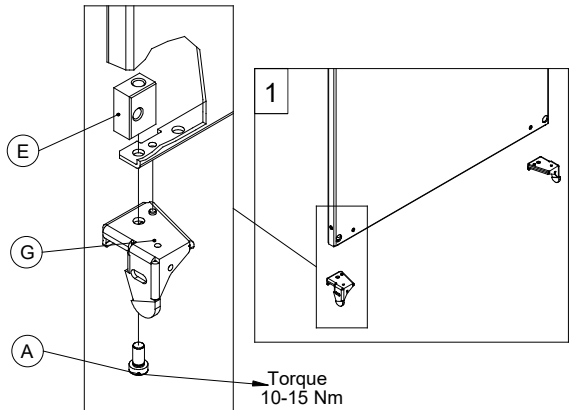

MOUNTING

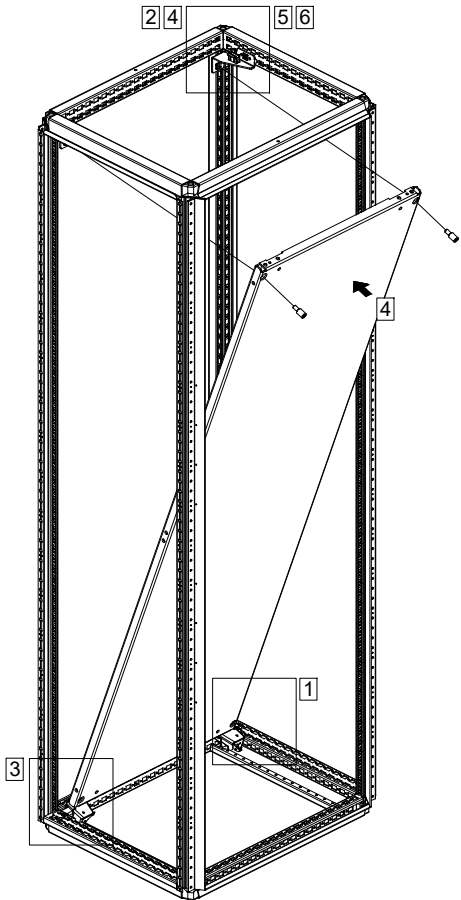
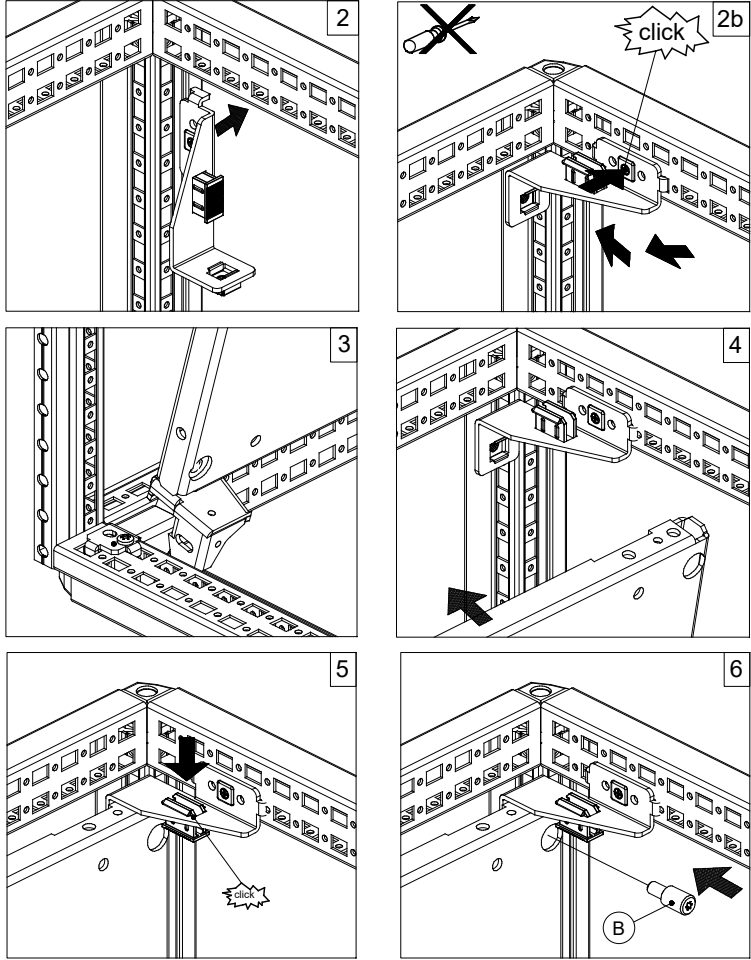

UNMOUNTING

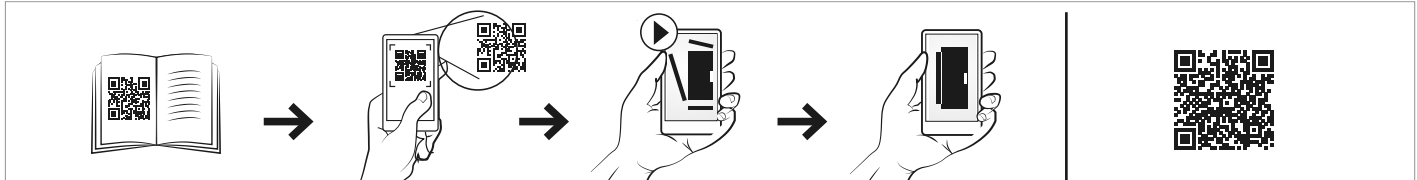
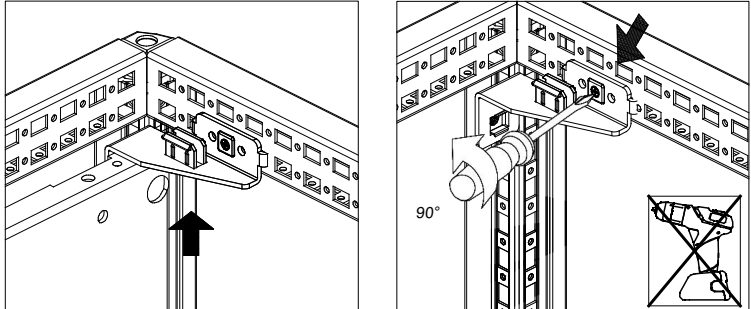

MPD02



Ref.	Pic.	Qty.
A	M5x12	2
B	Bottom left	1
C	Bottom right	1
D	M8x16	2

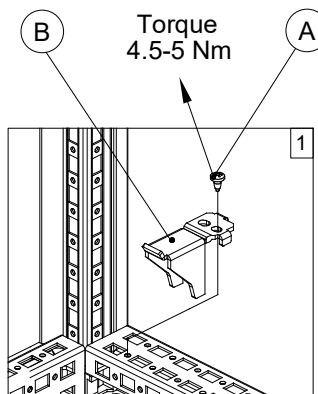
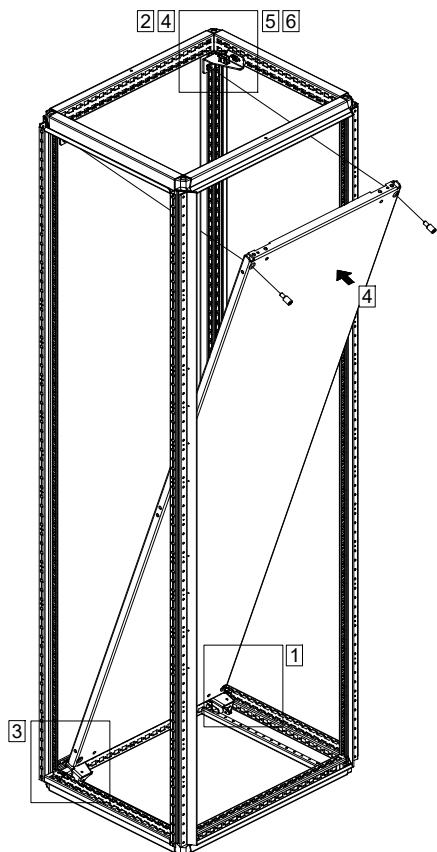

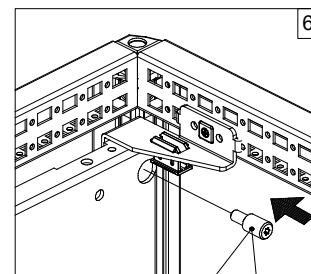
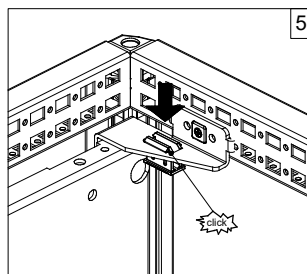
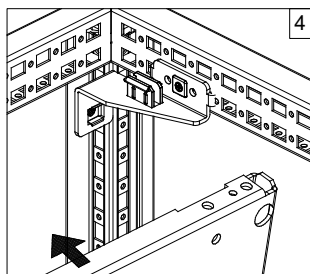
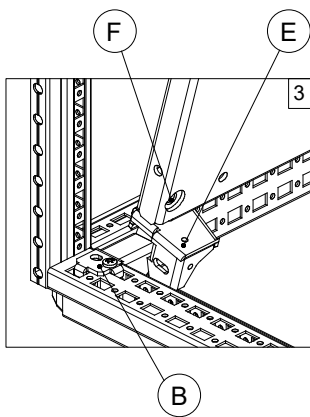
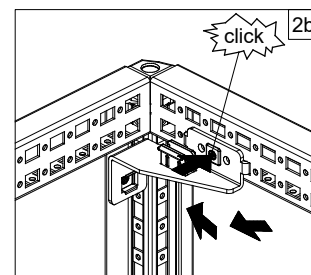
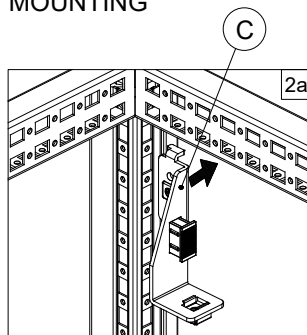

MOUNTING

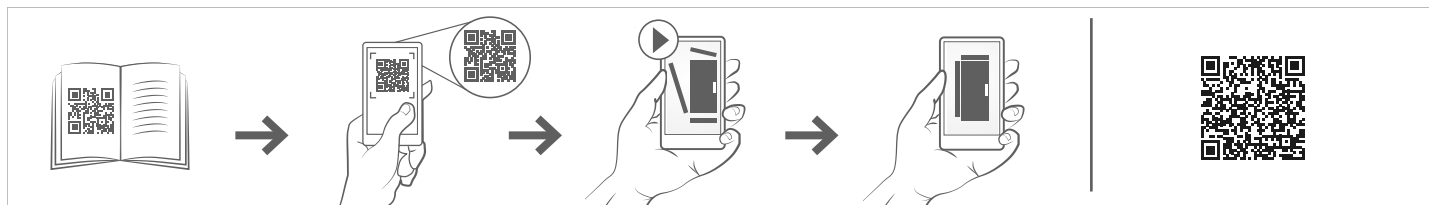
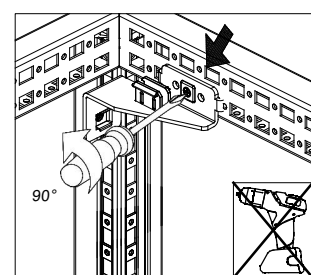
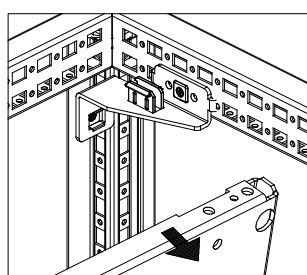
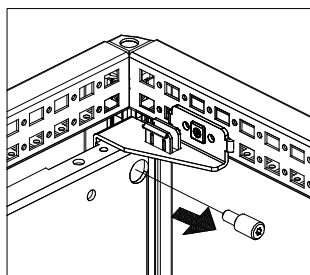
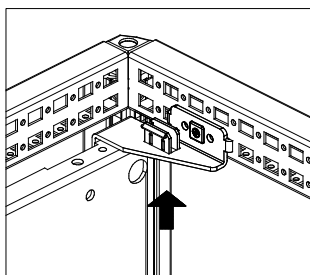

UNMOUNTING



SPM

Ref.	Pic.	Qty.
A		6/8/9
B		6/8/9
C		2

Side panel mounting

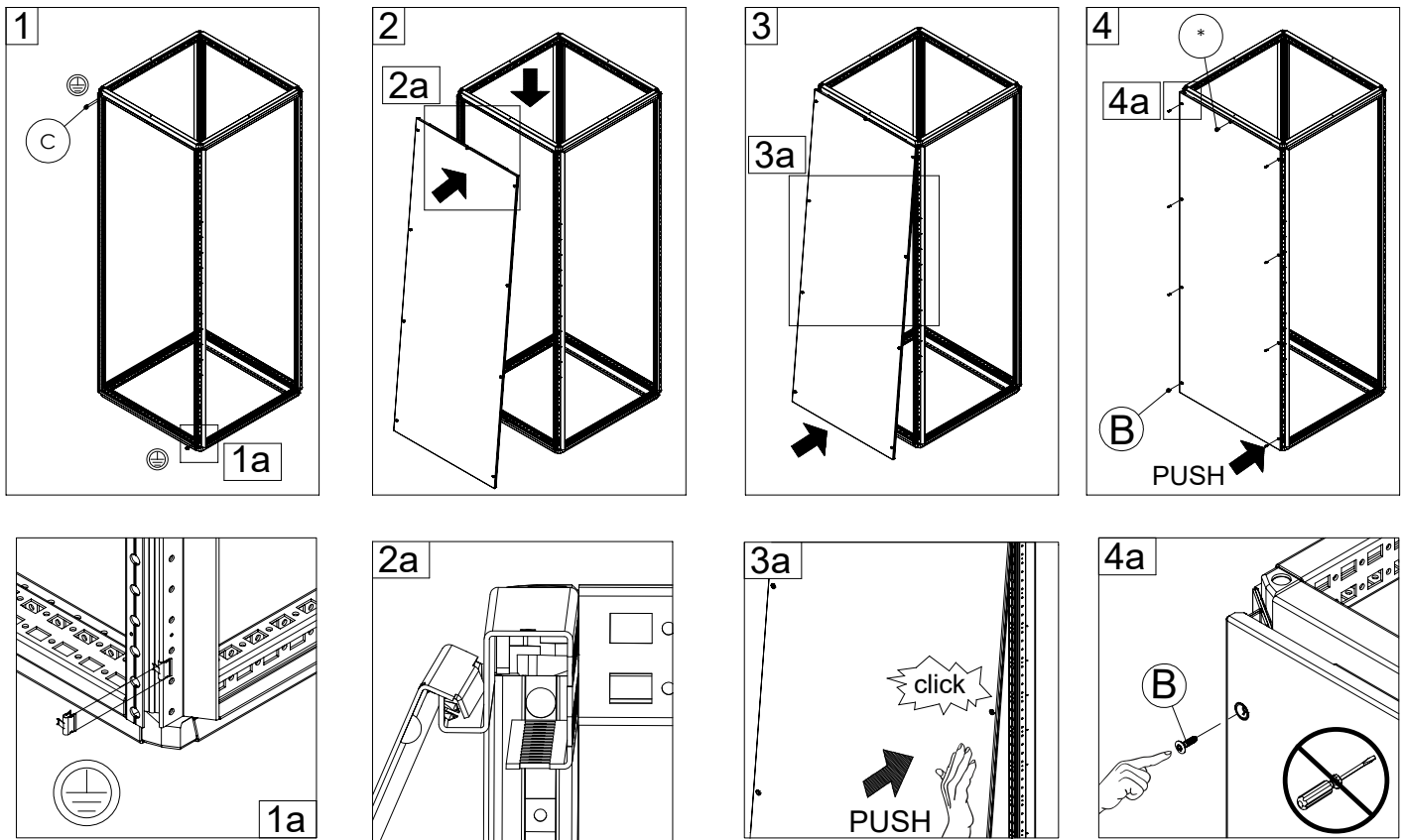

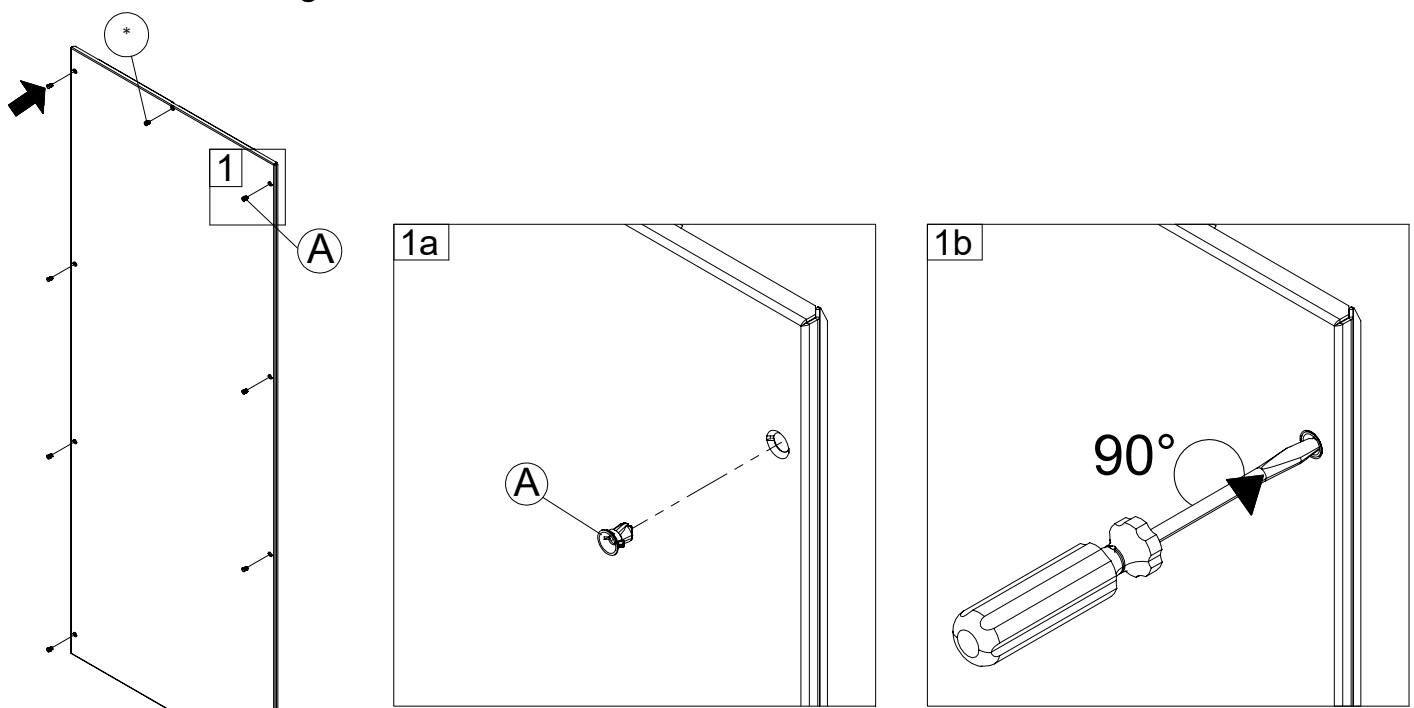

* - Used only on enclosures 800 mm deep and above.

Retainer mounting



NOTE: Retainers are delivered pre-assembled.

SPM

Ref.	Pic.	Qty.
A		1
B	 M6x16	1
C		1

For the old design frame (800 mm in depth or more), the following additional steps are required:

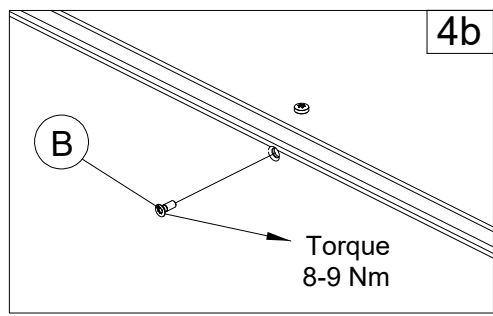
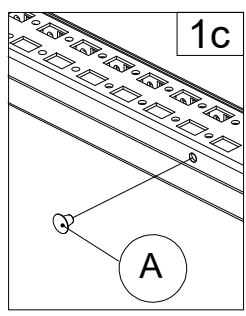
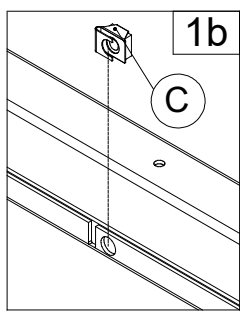
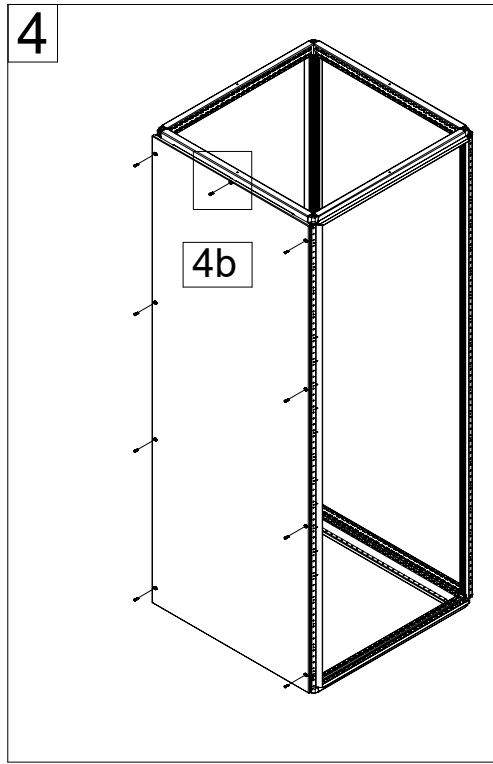
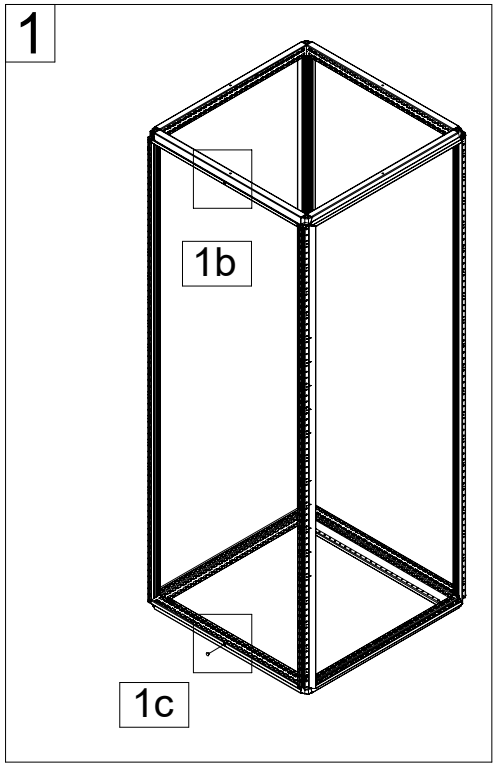



Ref.	Pic.	Qty.
A		8
B		6
C		12
D		6

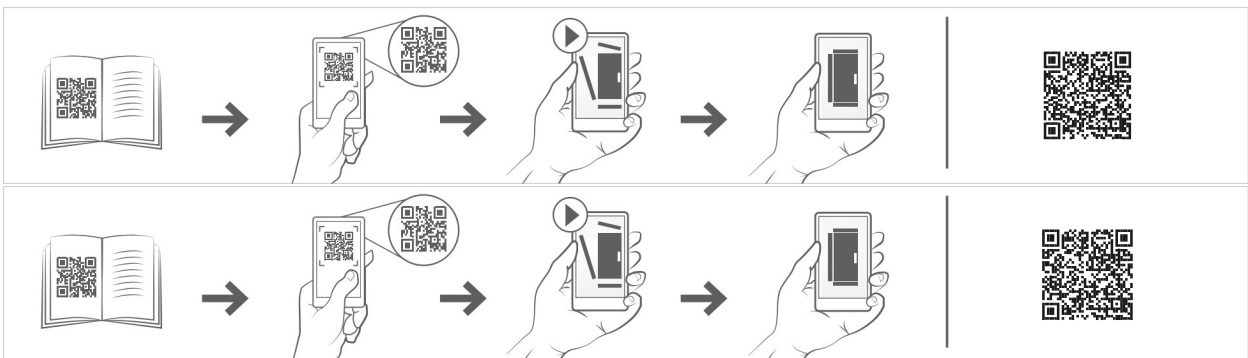
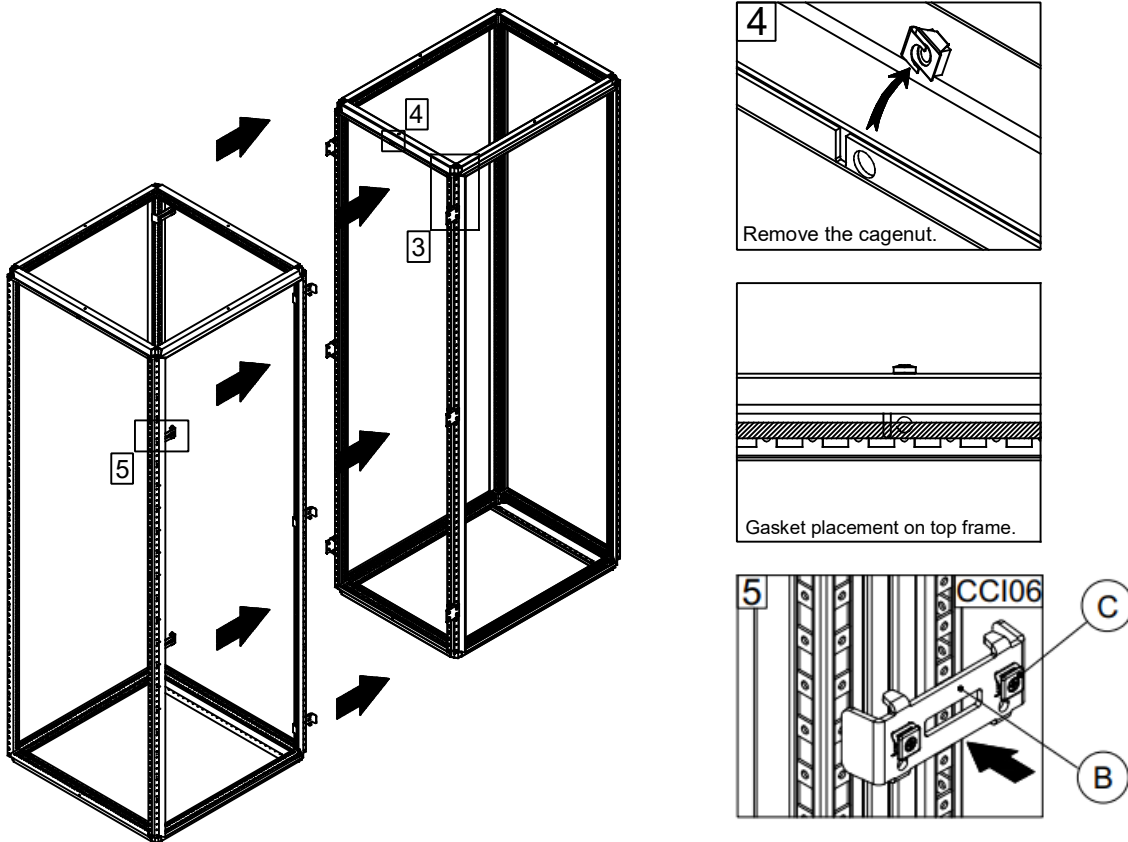
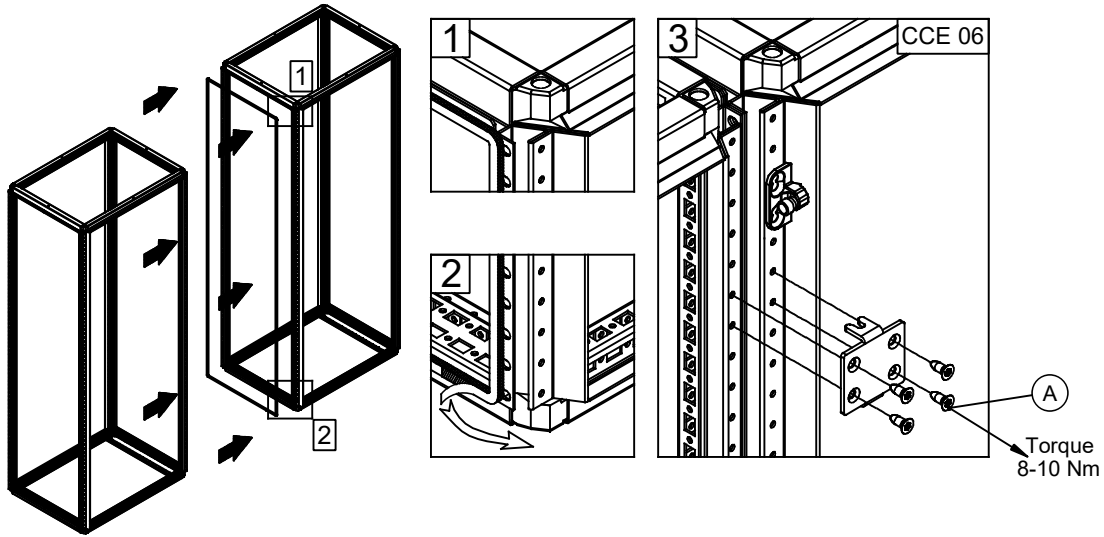



Ref.	Pic.	Qty.
A		4
B		4
C		2
D		4

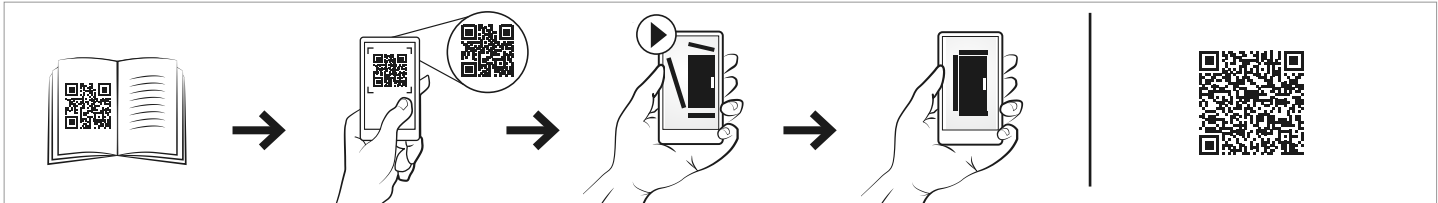
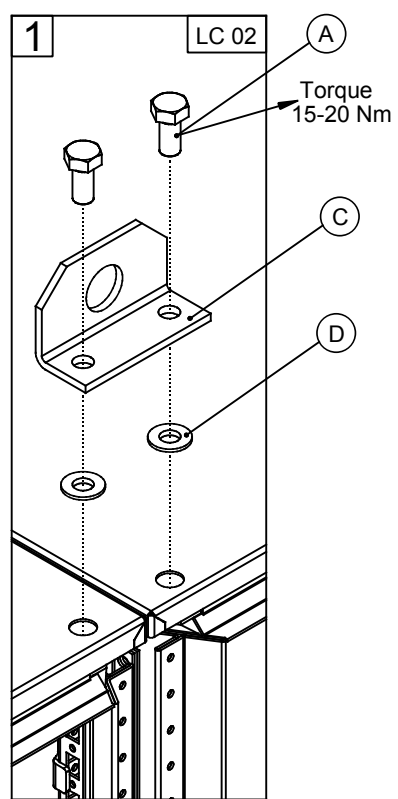
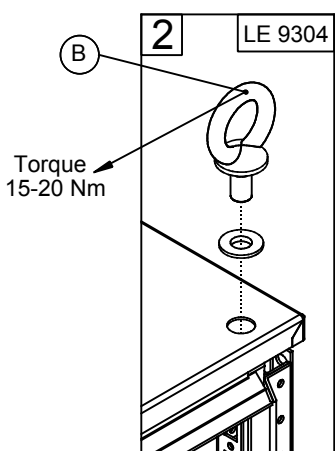
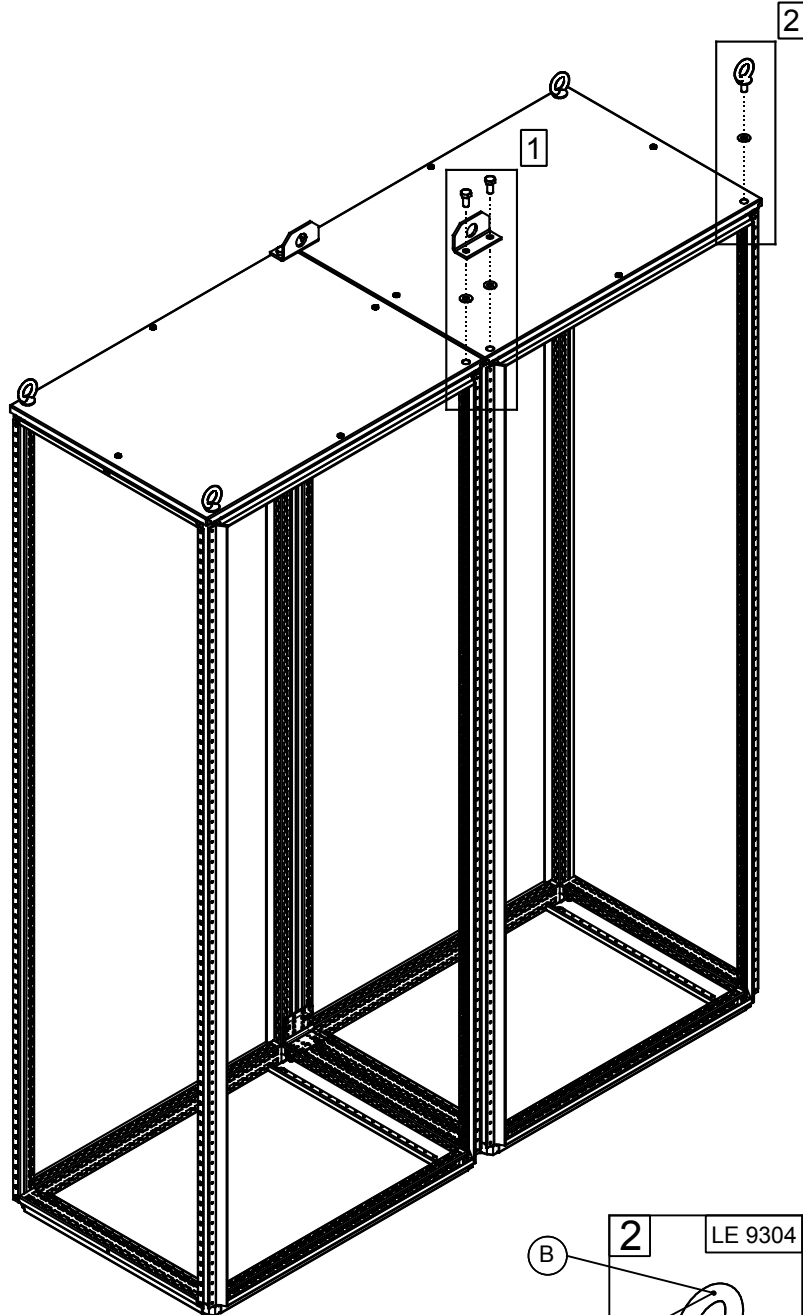



CCM 04



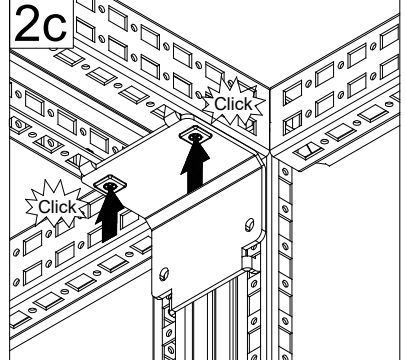
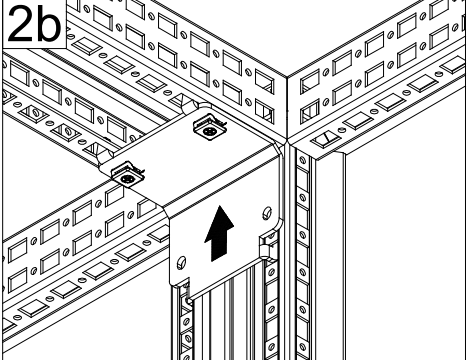
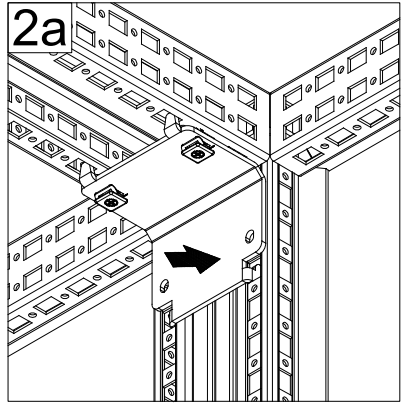
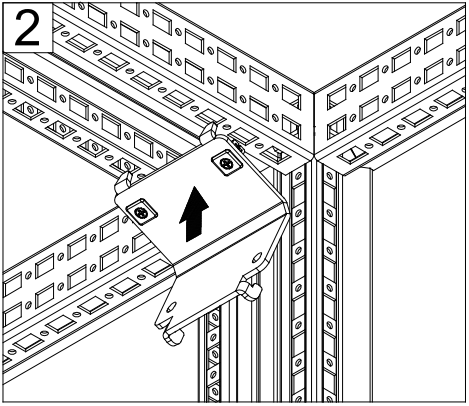
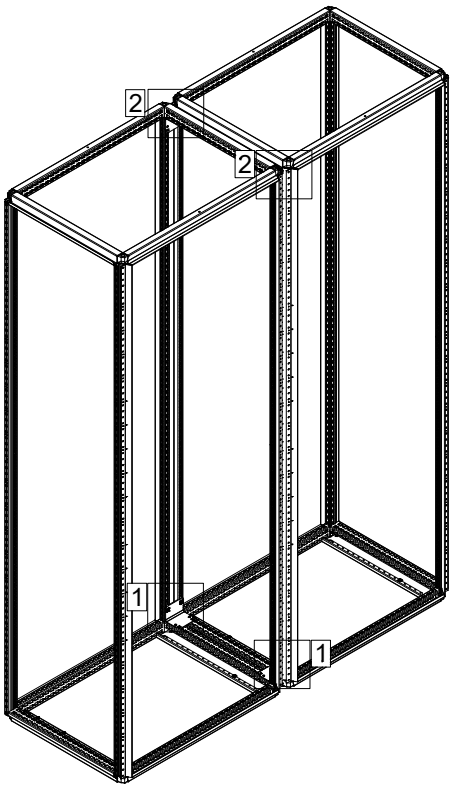
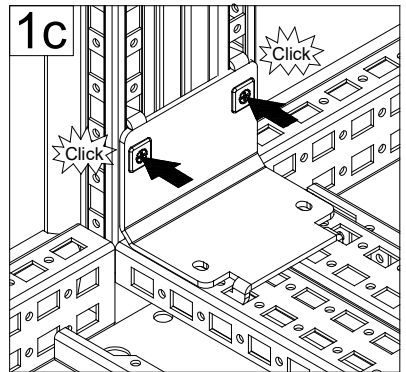
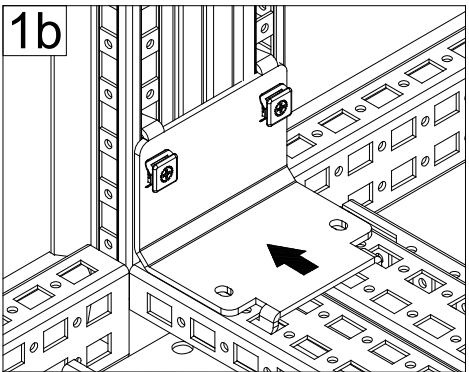
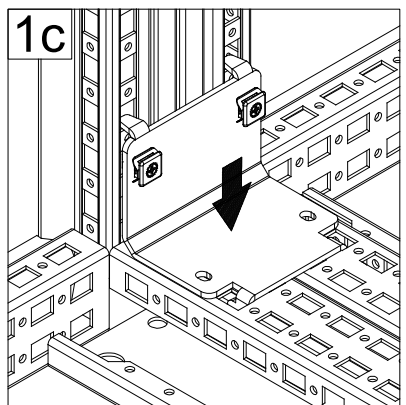
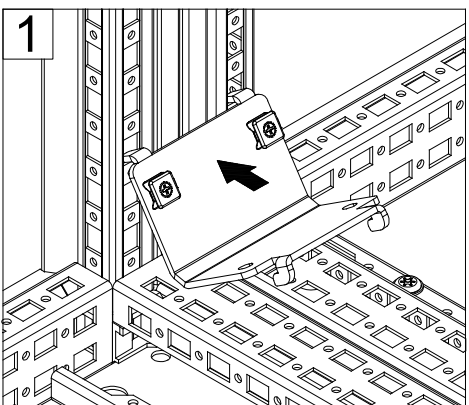
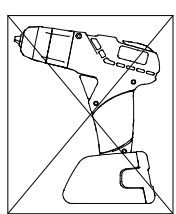
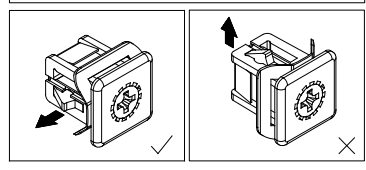
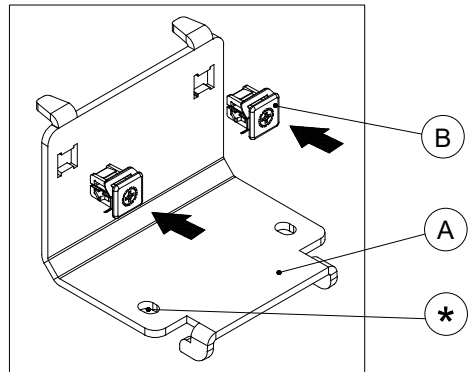

Ref.	Pic.	Qty.
A		4
B		8

MOUNTING

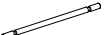

Note: It is mandatory for all four brackets to be installed at all four corners !
 * The fixation holes can be used to better fix the bracket to the frame, using cage nuts and screws !

MPF

Ref.	Pic.	Qty.
A		1
B		1
C		2
D		2

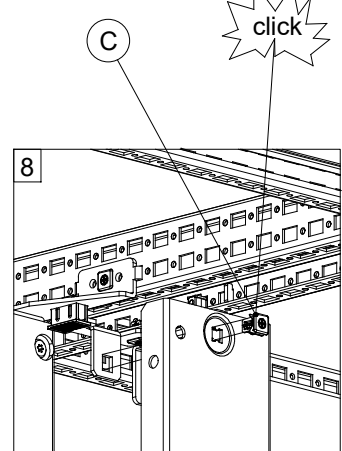
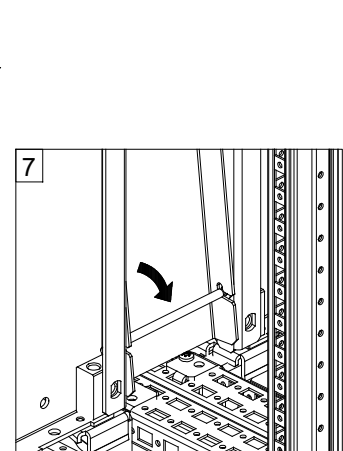
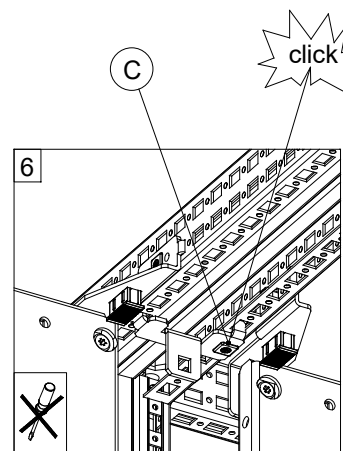
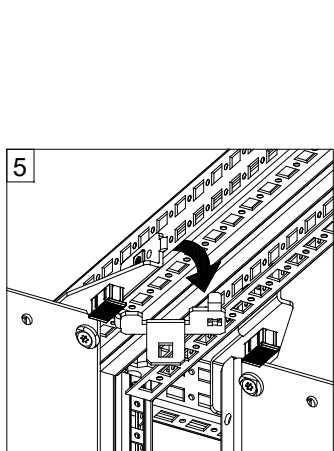
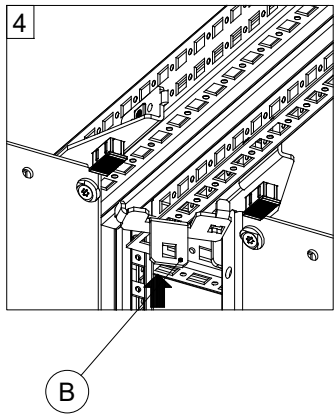
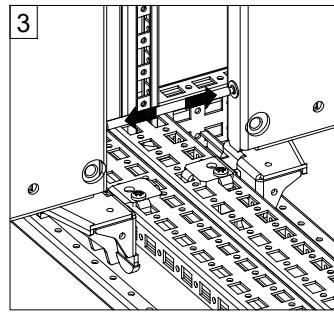
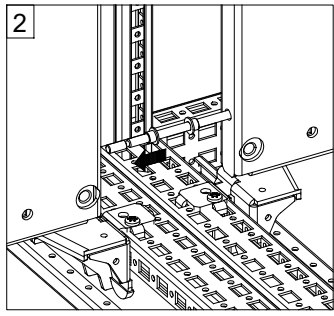
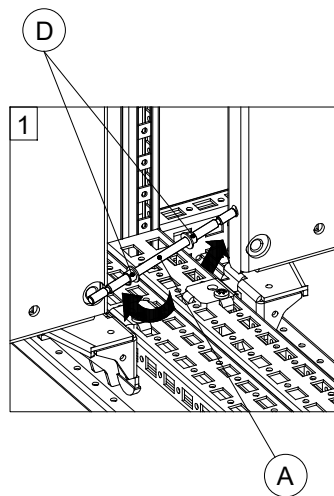
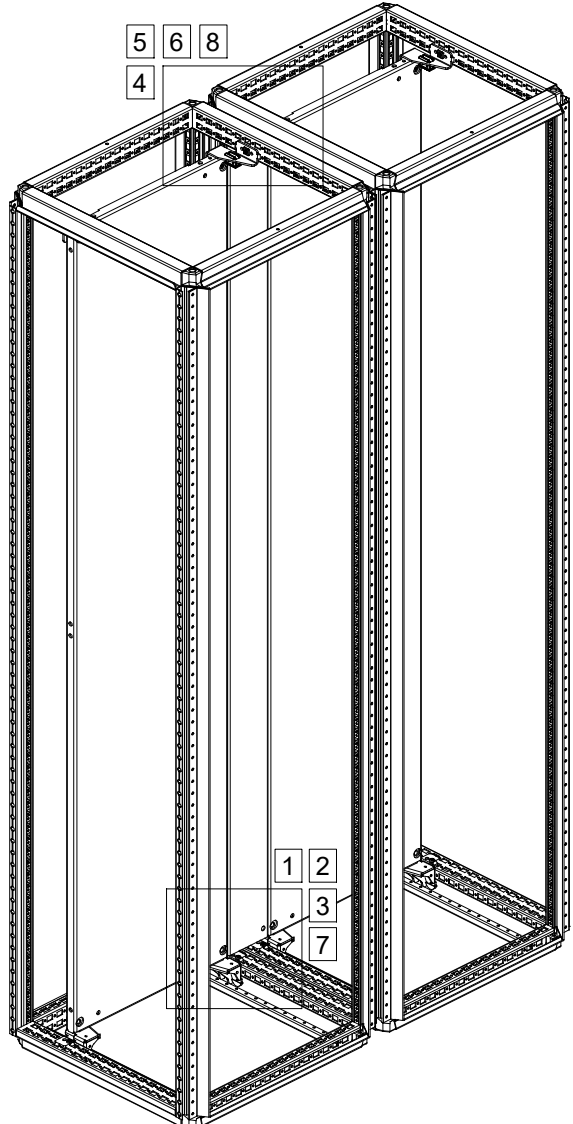

Back view

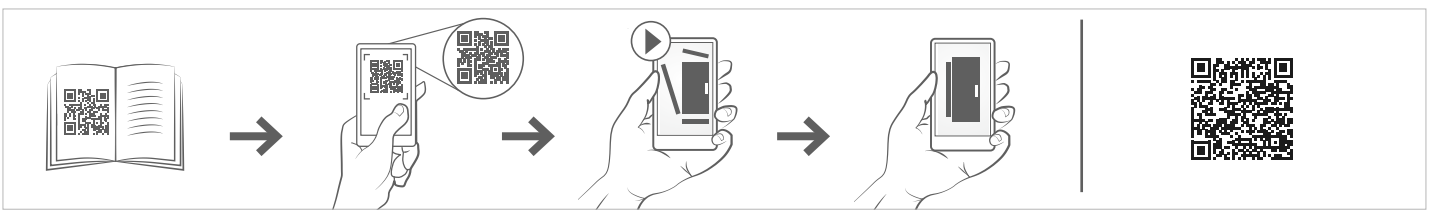

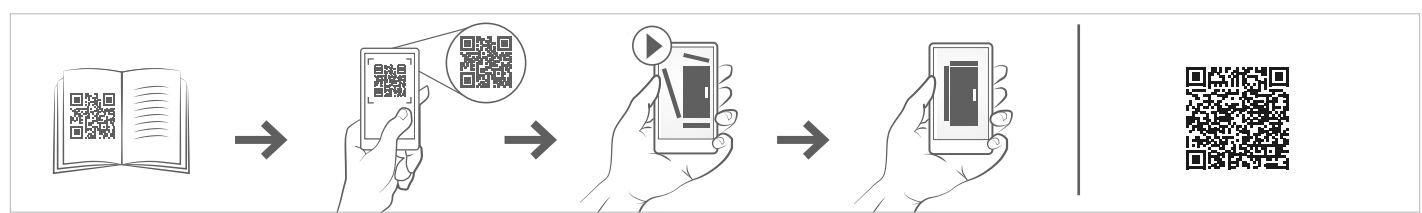
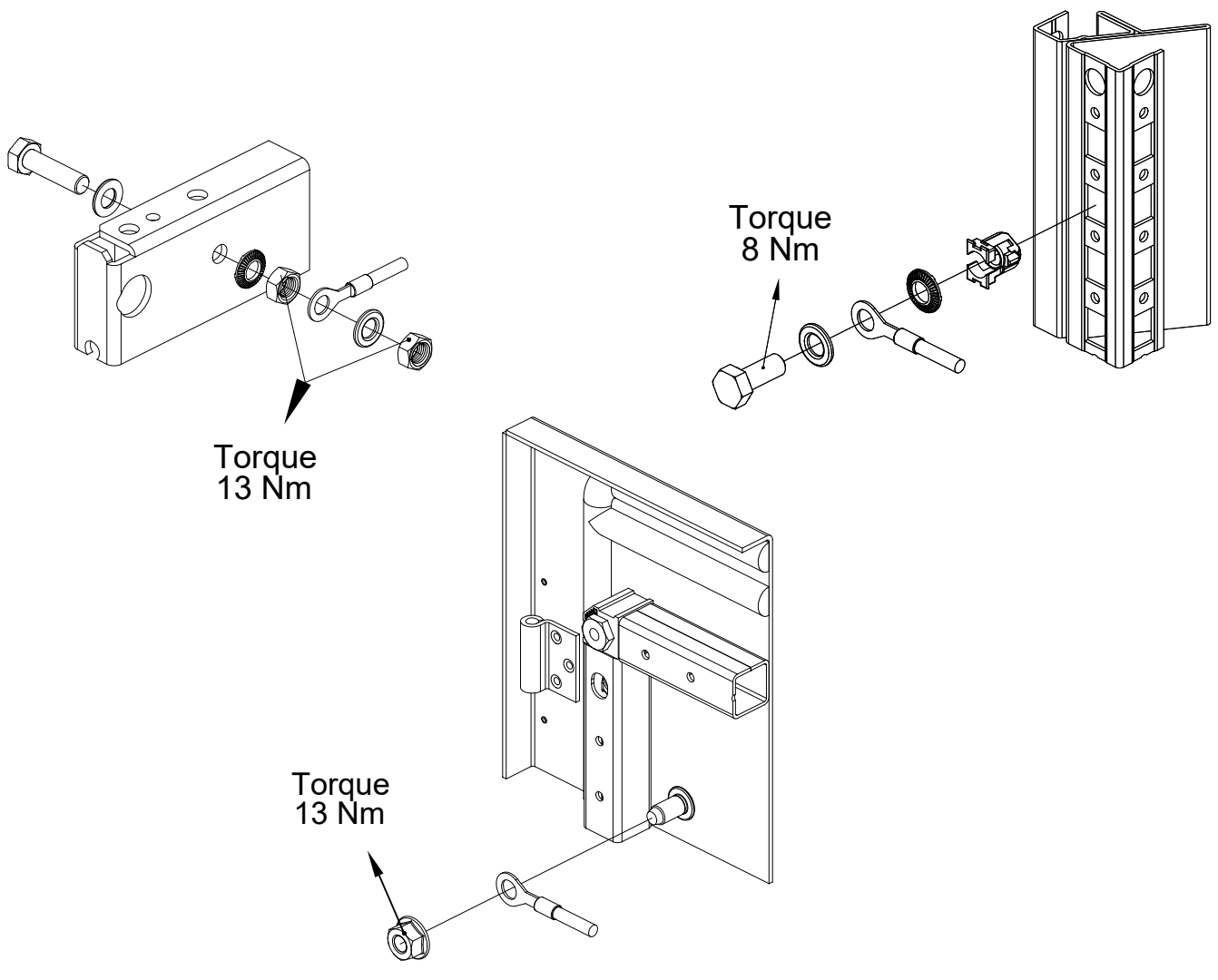

CNM

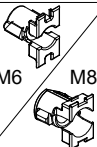
Ref.	Pic.	Qty.
A		1

