

nVent LENTON Standard Couplers (A32K)



CONNECT AND PROTECT



FEATURES

- High strength and corrosion resistant, for use with ASTM A1035 reinforcing steel (Grades 100 and 120)
- ChromX® 9000 materials provide for a unique combination of strength and corrosion resistance
- Designed to splice the same diameter bars where one bar can be rotated and the bar is not restricted in its axial direction
- Taper thread design eliminates cross-threading
- Taper threading on the bar is the same for all nVent LENTON taper coupler families
- Slim design reduces concrete cover
- Installs quickly and easily

The nVent LENTON A32K family of standard couplers is designed for use on ChromX® 2000, 4000 and 9000 Series reinforcing steels. The couplers are produced from ChromX 9000 Series steel which is manufactured to the ASTM A1035 specification. The ChromX 9000 material specification provides for a ductile, high strength coupler that has improved corrosion resistance. The performance of the spliced connection is designed to meet the bars' ultimate tensile strength of 150 KSI (1034 MPa) when connected with ASTM A1035 Grade 100 or 120.

nVent LENTON Standard Couplers are typically specified to provide continuity and structural integrity in reinforced concrete structures. The couplers are machined to have taper threads at both ends, creating a mechanical butt splice of two sections of reinforcing steel. nVent LENTON standard couplers are designed to splice the same diameter bars when at least one bar is free to rotate. They are one of the slimmest couplers available and the tapered thread makes them one of the most reliable, easy-to-install and cost-effective systems on the market.

Product is produced from 100% U.S. Domestic Steel and is currently available from #4 through #14 (12 mm through 43 mm). Other sizes are available upon request.

TYPICAL APPLICATIONS

Column bar, beam bar, shear wall and core wall splicing: creates a continuous length of bar

Segmental pours: positioned within the form of the first pour to allow fastening prior to the second pour

Part Number	Rebar Size			Diameter Ø	Length L	Bar Depth BD	Bar Gap BG	Unit Weight
	Metric	US	Canada					
EL12A32K	12 mm	#4	10M	0.75"	1.96"	0.73"	0.50"	0.2 lb
EL16A32K	16 mm	#5	15M	1.00"	2.41"	0.96"	0.49"	0.4 lb
EL20A32K	20 mm	#6	20M	1.25"	3.41"	1.37"	0.67"	0.8 lb
EL22A32K	22 mm	#7	—	1.25"	3.60"	1.46"	0.68"	0.8 lb
EL25A32K	25 mm	#8	25M	1.50"	3.80"	1.57"	0.66"	1.2 lb
EL28A32K	28 mm	#9	30M	1.50"	3.97"	1.65"	0.67"	1.1 lb
EL32A32K	32 mm	#10	—	1.75"	4.23"	1.78"	0.67"	1.6 lb
EL36A32K	36 mm	#11	35M	2.00"	4.76"	2.04"	0.68"	2.5 lb
EL40A32K	40 mm	—	—	2.25"	5.17"	2.25"	0.67"	3.5 lb
EL43TA32K	43 mm	#14	45M	2.25"	6.22"	2.60"	1.02"	3.8 lb

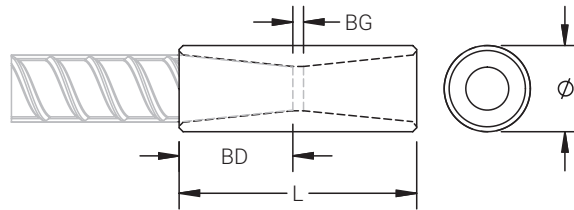

Our powerful portfolio of brands:

CADDY ERICO HOFFMAN ILSCO RAYCHEM SCHROFF