

nVent LENTON® Ultimate Detailer's Guide (Americas)

NOTE

- A controlled amount of reinforcing steel and coupler material are consumed as part of the friction welding process.
- For this reason, the "B" dimensions in this document are in reference to the "as-welded" condition and will not match nominal "pre-welded" part lengths shown in other literature.
- The following sections show a "DETAILED LENGTH" reference point for the assembly and provide "DIFF" dimensions for calculation of respective "CUT LENGTHS" on the associated parts.

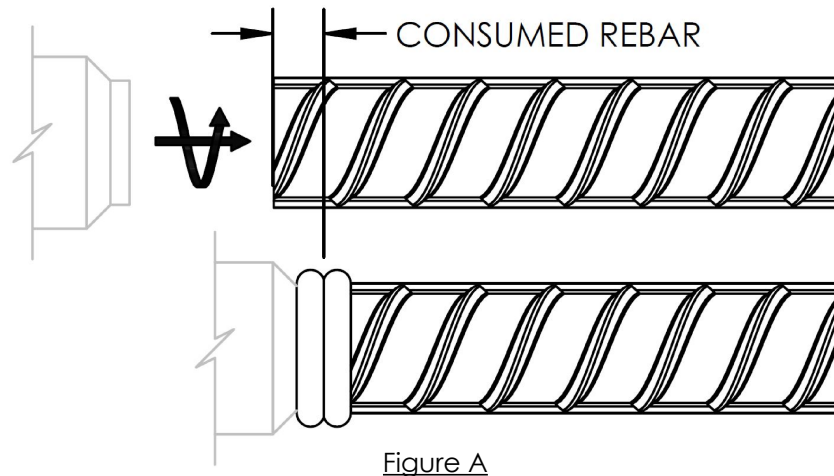

WARNING:

1. nVent products shall be installed and used only as indicated in nVent product instruction sheets and training materials. Instruction sheets are available at www.nVent.com and from your nVent customer service representative.
2. nVent products must never be used for a purpose other than the purpose for which they were designed or in a manner that exceeds specified load ratings.
3. All instructions must be completely followed to ensure proper and safe installation and performance.
4. Improper installation, misuse, misapplication or other failure to completely follow nVent's instructions and warnings may cause product malfunction, property damage, serious bodily injury and/or death, and void your warranty.

The customer is responsible for:

- a. Conformance to all governing codes.
- b. The integrity of structures to which the products are attached, including their capability of safely accepting the loads imposed, as evaluated by a qualified engineer.
- c. Using appropriate industry standard hardware as noted above.

SAFETY INSTRUCTIONS:

All governing codes and regulations and those required by the job site must be observed. Always use appropriate safety equipment such as eye protection, hard hat, and gloves as appropriate to the application.

nVent, CADDY, ERICO CADWELD, ERICO CRITEC, ERICO, ERIFLEX, and LENTON are registered trademarks of nVent or its global affiliates. All other trademarks are the property of their respective owners. nVent reserves the right to change specifications without prior notice.

nVent LENTON® Ultimate Detailer's Guide (Americas)

A= Diameter or Hex Size
 B= Length (Part)
 L= Length (Assembly)

All dimensions in inches [mm]

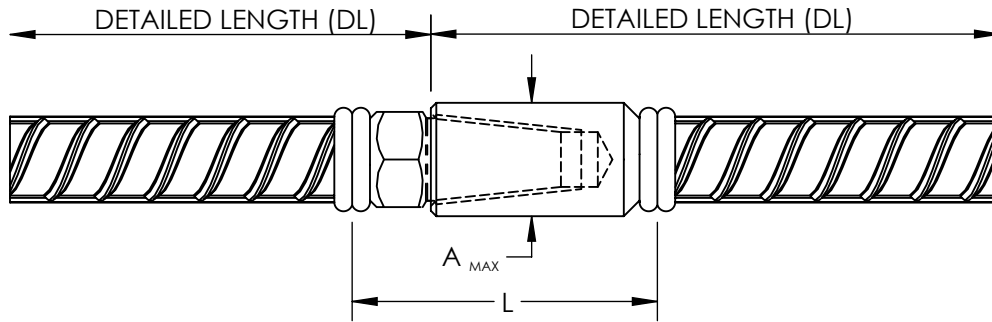

Figure B

Bar Size	Part Numbers		"A _{MAX} " Hex	"A _{MAX} " Round	"L"	Total Splice "DIFF"	Figure(s)	Table(s)
	Female	Male						
#4	LU12FT12	LU12MT12	0.69 [17.5]	---	2.2 [56]	1.6 [40]	B,C,D	2, 3
#5	LU16FT12	LU16MT12	0.88 [22.4]	---	2.4 [61]	1.8 [46]	B,C,D	2, 3
#6	LU20FT12	LU20MT12	1.06 [26.9]	---	3.2 [81]	2.6 [66]	B,C,D	2, 3
#7	LU22FT12	LU22MT12	1.19 [30.2]	---	3.5 [89]	2.8 [71]	B,C,D	2, 3
#8	LU25FT12	LU25MT12	---	1.38 [35.1]	3.7 [94]	3.1 [79]	B,C,D	2, 3
#9	LU28FT12	LU28MT12	---	1.50 [38.1]	3.8 [97]	3.2 [82]	B,C,D	2, 3
#10	LU32FT12	LU32MT12	---	1.75 [44.5]	4.0 [102]	3.4 [86]	B,C,D	2, 3
#11	LU36FT12	LU36MT12	---	1.88 [47.8]	4.5 [114]	3.7 [94]	B,C,D	2, 3
#14	LU43TFT12	LU43TMT12	---	2.25 [57.2]	5.8 [147]	5.0 [127]	B,C,D	2, 3
#18	LU57TFT12	LU57TMT12	---	3.00 [76.2]	6.8 [173]	5.9 [149]	B,C,D	2, 3

Bar Size	Part Number	"A" Hex	"A" Round	"B"	"TL"	"DIFF"	Figure(s)
#4	LU12MT12	0.69 [17.5]	---	1.6 [41]	0.8 [20]	0.4 [10]	C
#5	LU16MT12	0.88 [22.4]	---	1.8 [46]	1.1 [28]	0.4 [10]	C
#6	LU20MT12	1.06 [26.9]	---	2.3 [58]	1.5 [38]	0.5 [13]	C
#7	LU22MT12	1.06 [26.9]	---	2.6 [66]	1.6 [41]	0.6 [15]	C
#8	LU25MT12	1.19 [30.2]	---	2.7 [69]	1.7 [43]	0.7 [18]	C
#9	LU28MT12	---	1.38 [35.1]	2.8 [71]	1.8 [46]	0.7 [18]	C
#10	LU32MT12	---	1.50 [38.1]	3.1 [79]	2.0 [51]	0.8 [20]	C
#11	LU36MT12	---	1.75 [44.5]	3.4 [86]	2.2 [56]	0.8 [20]	C
#14	LU43TMT12	---	2.00 [50.8]	4.4 [112]	2.9 [74]	1.1 [28]	C
#18	LU57TMT12	---	2.50 [63.5]	5.3 [135]	3.6 [91]	1.2 [30]	C

CL = DL - DIFF

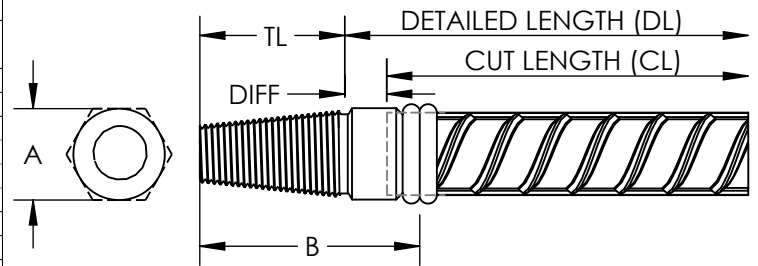

Figure C

Bar Size	Part Number	"A" Hex	"A" Round	"B"	"DIFF"	Figure(s)
#4	LU12FT12	0.69 [17.5]	---	1.4 [36]	1.2 [30]	D
#5	LU16FT12	0.88 [22.4]	---	1.7 [43]	1.4 [36]	D
#6	LU20FT12	1.06 [26.9]	---	2.4 [61]	2.1 [53]	D
#7	LU22FT12	1.19 [30.2]	---	2.5 [64]	2.2 [56]	D
#8	LU25FT12	---	1.38 [35.1]	2.7 [69]	2.4 [61]	D
#9	LU28FT12	---	1.50 [38.1]	2.8 [71]	2.5 [64]	D
#10	LU32FT12	---	1.75 [44.5]	2.9 [74]	2.6 [66]	D
#11	LU36FT12	---	1.88 [47.8]	3.3 [84]	2.9 [74]	D
#14	LU43TFT12	---	2.25 [57.2]	4.3 [109]	3.9 [99]	D
#18	LU57TFT12	---	3.00 [76.2]	5.1 [130]	4.7 [119]	D

CL = DL - DIFF

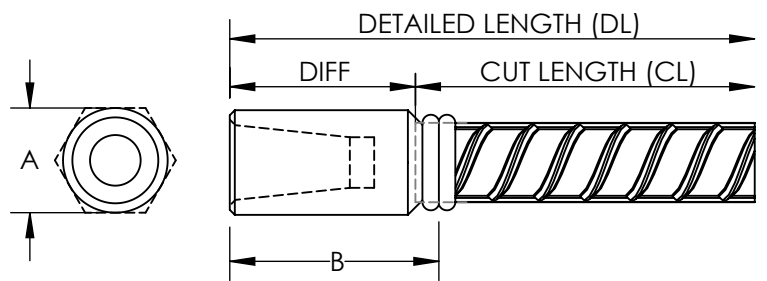

Figure D

nVent, CADDY, ERICO CADWELD, ERICO CRITEC, ERICO, ERIFLEX, and LENTON are registered trademarks of nVent or its global affiliates. All other trademarks are the property of their respective owners. nVent reserves the right to change specifications without prior notice.

nVent LENTON® Ultimate Detailer's Guide (Americas)

A= Diameter or Hex Size
B= Length (Part)
L= Length (Assembly)

All dimensions in inches [mm]

Table 4 - nVent LENTON Ultimate Coupler with Threaded Rebar Splice Assembly - FT12 & nVent LENTON Taper

Bar Size	Part Numbers		"A" Hex	"A" Round	Figure(s)	Table(s)
	Female	Male				
#4	LU12FT12	LENTON #4 Taper Thread	0.69 [17.5]	---	D, E	3, 5
#5	LU16FT12	LENTON #5 Taper Thread	0.88 [22.4]	---	D, E	3, 5
#6	LU20FT12	LENTON #6 Taper Thread	1.06 [26.9]	---	D, E	3, 5
#7	LU22FT12	LENTON #7 Taper Thread	1.19 [30.2]	---	D, E	3, 5
#8	LU25FT12	LENTON #8 Taper Thread	---	1.38 [35.1]	D, E	3, 5
#9	LU28FT12	LENTON #9 Taper Thread	---	1.50 [38.1]	D, E	3, 5
#10	LU32FT12	LENTON #10 Taper Thread	---	1.75 [44.5]	D, E	3, 5
#11	LU36FT12	LENTON #11 Taper Thread	---	1.88 [47.8]	D, E	3, 5
#14	LU43TFT12	LENTON #14 Taper Thread	---	2.25 [57.2]	D, E	3, 5
#18	LU57TFT12	LENTON #18 Taper Thread	---	3.00 [76.2]	D, E	3, 5

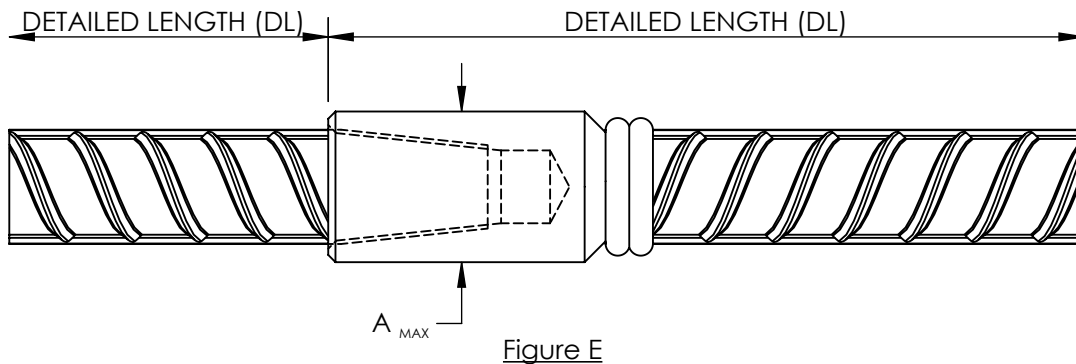

NOTE: When detailing spliced bars individually, refer to Table 3 on page 2, and Table 5 below.

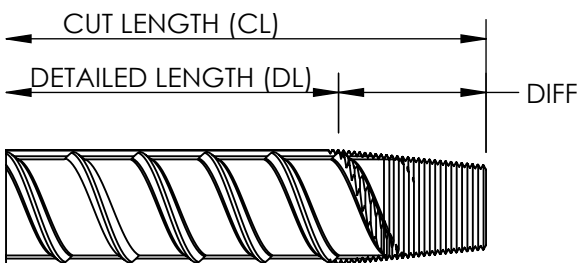

Figure F

Table 5 - nVent LENTON Tapered Threads

Bar Size	Part Number	"DIFF"*	Figure(s)
#4	LENTON #4 Taper Thread	0.7 [19]	F
#5	LENTON #5 Taper Thread	1.0 [24]	F
#6	LENTON #6 Taper Thread	1.4 [35]	F
#7	LENTON #7 Taper Thread	1.5 [37]	F
#8	LENTON #8 Taper Thread	1.6 [40]	F
#9	LENTON #9 Taper Thread	1.7 [42]	F
#10	LENTON #10 Taper Thread	1.8 [45]	F
#11	LENTON #11 Taper Thread	2.0 [52]	F
#14	LENTON #14 Taper Thread	2.6 [66]	F
#18	LENTON #18 Taper Thread	3.3 [83]	F

*CUT LENGTH IS LONGER THAN DETAILED LENGTH
CL = DL + DIFF

nVent LENTON® Ultimate Detailer's Guide (Americas)

A= Diameter or Hex Size
B= Length (Part)
L= Length (Assembly)

All dimensions in inches [mm]

Table 6 - nVent LENTON Ultimate Positional Coupler Assembly - PT15, MS15 & MT12

Bar Size	Part Numbers			"A _{MAX} " Hex	"A _{MAX} " Round	"L _{MIN} "	"L _{MAX} "	Total Splice "DIFF"	Total Travel "TT"	Figure(s)	Table(s)
	Male-Taper	Male-Parallel	Coupler								
#8	LU25MT12	LU25MS15	LU25PT15	---	1.50 [38.1]	6.9 [175]	8.7 [221]	6.3 [160]	1.8 [46]	C, G, H	2, 7
#9	LU28MT12	LU28MS15	LU28PT15	---	1.75 [44.5]	7.4 [188]	9.3 [236]	6.8 [173]	1.9 [48]	C, G, H	2, 7
#10	LU32MT12	LU32MS15	LU32PT15	---	2.00 [50.8]	7.9 [201]	10.0 [254]	7.3 [185]	2.1 [53]	C, G, H	2, 7
#11	LU36MT12	LU36MS15	LU36PT15	---	2.25 [57.2]	8.7 [221]	11.0 [279]	7.9 [201]	2.3 [58]	C, G, H	2, 7
#14	LU43TMT12	LU43TMS15	LU43TPT15	---	2.75 [69.9]	11.3 [287]	14.4 [366]	10.5 [267]	3.1 [79]	C, G, H	2, 7
#18	LU57TMT12	LU57TMS15	LU57TPT15	---	4.00 [101.6]	14.0 [356]	17.8 [452]	13.1 [333]	3.8 [97]	C, G, H	2, 7

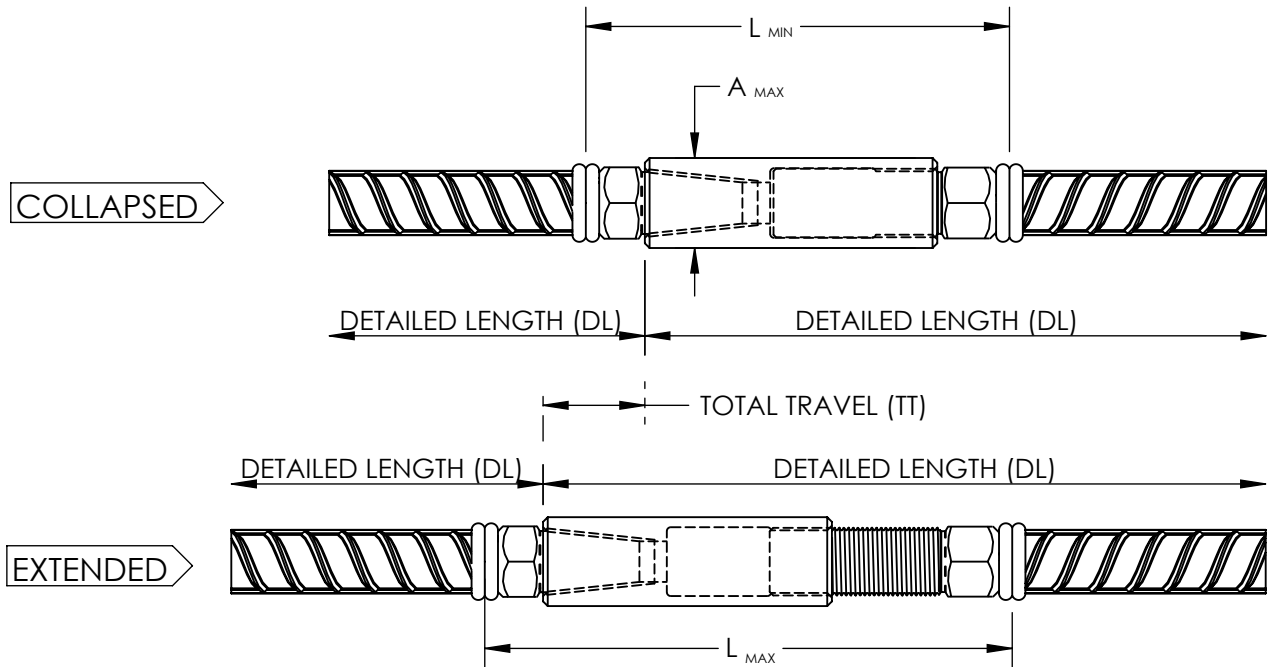

Figure G

NOTE: When detailing spliced bars individually, refer to Table 2 on page 2, and Table 7 below.

Table 7 - nVent LENTON Ultimate Parallel Threaded Assembly - PT15 & MS15

Bar Size	Part Number	"A" Hex	"A" Round	"B"	"DIFF"	Total Travel "TT"	Figure(s)
#8	LU25MS15	1.19 [30.2]	---	3.8 [97]	5.6 [142]	1.8 [46]	G, H
#9	LU28MS15	---	1.38 [35.1]	4.2 [107]	6.1 [155]	1.9 [48]	G, H
#10	LU32MS15	---	1.50 [38.1]	4.5 [114]	6.5 [165]	2.1 [53]	G, H
#11	LU36MS15	---	1.75 [44.5]	4.9 [125]	7.1 [180]	2.3 [58]	G, H
#14	LU43TMS15	---	2.00 [50.8]	6.4 [163]	9.4 [239]	3.1 [79]	G, H
#18	LU57TMS15	---	2.75 [69.9]	8.3 [211]	11.9 [302]	3.8 [97]	G, H

CL = DL - DIFF

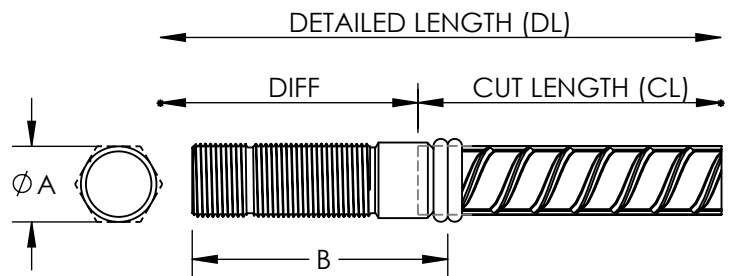

Figure H

nVent, CADDY, ERICO CADWELD, ERICO CRITEC, ERICO, ERIFLEX, and LENTON are registered trademarks of nVent or its global affiliates. All other trademarks are the property of their respective owners. nVent reserves the right to change specifications without prior notice.

nVent LENTON® Ultimate Detailer's Guide (Americas)

A= Diameter or Hex Size
B= Length (Part)
L= Length (Assembly)

All dimensions in inches [mm]

Bar Size	Part			"A _{MAX} " Hex	"A _{MAX} " Round	"L _{MIN} "	"L _{MAX} "	Total Splice "DIFF"	Total Travel "TT"	Figure(s)	Table(s)
	Male-Taper	Male-Parallel	Coupler								
#8	LENTON #8 Taper Thread	LU25MS15	LU25PT15	---	1.50 [38.1]	5.9 [150]	7.7 [196]	3.8 [97]	1.8 [46]	F, H, I	5, 7
#9	LENTON #9 Taper Thread	LU28MS15	LU28PT15	---	1.75 [44.5]	6.4 [163]	8.3 [211]	4.2 [107]	1.9 [48]	F, H, I	5, 7
#10	LENTON #10 Taper Thread	LU32MS15	LU32PT15	---	2.00 [50.8]	6.8 [173]	8.9 [226]	4.4 [112]	2.1 [53]	F, H, I	5, 7
#11	LENTON #11 Taper Thread	LU36MS15	LU36PT15	---	2.25 [57.2]	7.5 [191]	9.8 [249]	4.8 [122]	2.3 [58]	F, H, I	5, 7
#14	LENTON #14 Taper Thread	LU43TMS15	LU43TPT15	---	2.75 [69.9]	9.8 [249]	12.9 [328]	6.4 [163]	3.1 [79]	F, H, I	5, 7
#18	LENTON #18 Taper Thread	LU57TMS15	LU57TPT15	---	4.00 [101.6]	12.3 [312]	16.1 [409]	8.2 [208]	3.8 [97]	F, H, I	5, 7

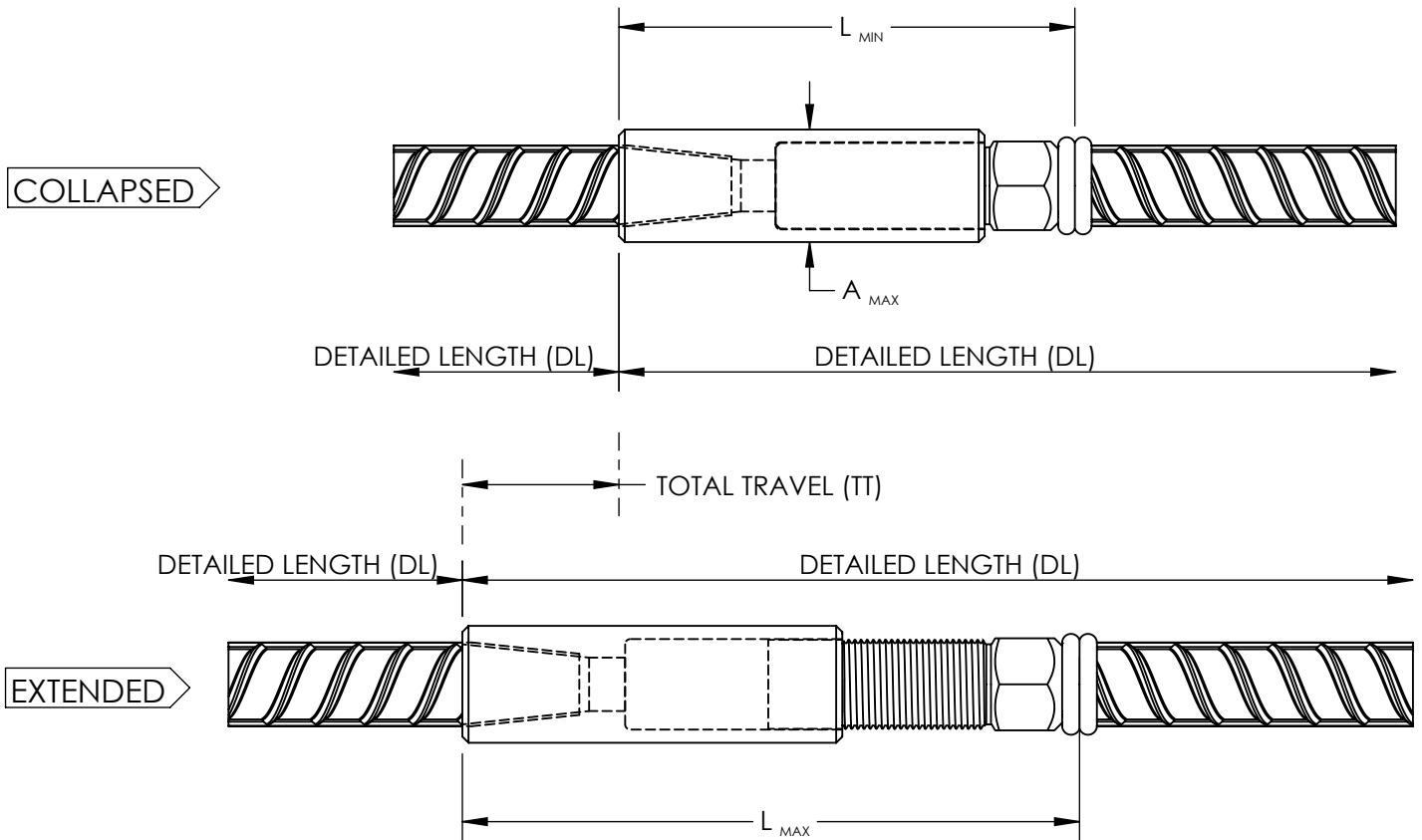

Figure I

NOTE: When detailing spliced bars individually, refer to Table 5 on page 3, and Table 7 on page 4.

nVent LENTON® Ultimate Detailer's Guide (Americas)

A= Diameter or Hex Size
 B= Length (Part)
 L= Length (Assembly)
 T= Headed Product Thickness

All dimensions in inches [mm]

Bar Size	Part Numbers		"A"			Figure(s)	Table(s)
	Head	Male	Round	"T"	"DIFF"		
#4	LU12DR16	----	1.38 [35.1]	0.59 [15.0]	0.3 [8]	J	---
#5	LU16DR16	----	1.75 [44.5]	0.59 [15.0]	0.3 [8]	J	---
#6	LU20DR16	----	2.00 [50.8]	0.59 [15.0]	0.3 [8]	J	---
#7	LU22DR16	----	2.25 [57.2]	0.59 [15.0]	0.3 [8]	J	---
#8	LU25DR16	----	2.50 [63.5]	0.78 [19.8]	0.5 [13]	J	---
#9	LU28DR16	----	2.75 [69.9]	0.78 [19.8]	0.5 [13]	J	---
#10	LU32DR16	----	3.00 [76.2]	0.78 [19.8]	0.5 [13]	J	---
#11	LU36DR16	----	3.25 [82.6]	0.98 [24.9]	0.7 [18]	J	---
#14	EL43TD16	LU43TMT12	4.00 [101.6]	1.64 [41.7]	4.0 [102]	C, K	2
#18	EL57TD16	LU57TMT12	5.13 [130.3]	2.31 [58.7]	4.8 [122]	C, K	2

CL = DL - DIFF

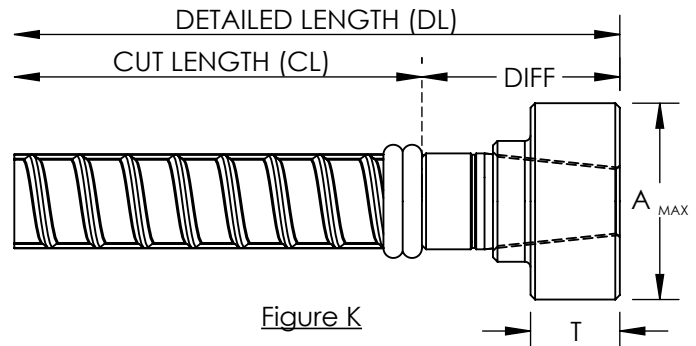
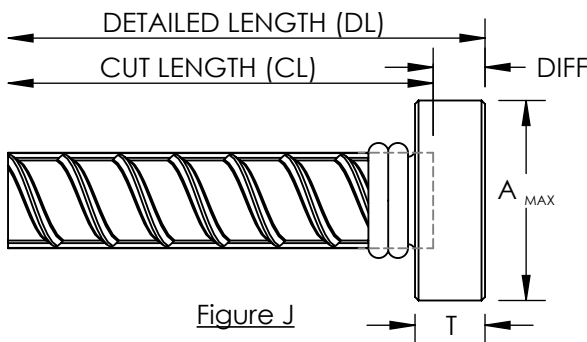

Bar Size	Part Numbers		"A"			Figure(s)	Table(s)
	Head	Male	Round	"T"	"DIFF"		
#4	LU12DR14	----	1.75 [44.5]	0.59 [15.0]	0.3 [8]	L	---
#5	LU16DR14	----	2.00 [50.8]	0.59 [15.0]	0.3 [8]	L	---
#6	LU20DR14	----	2.50 [63.5]	0.59 [15.0]	0.3 [8]	L	---
#7	LU22DR14	----	2.75 [69.9]	0.59 [15.0]	0.3 [8]	L	---
#8	LU25DR14	----	3.25 [82.6]	0.78 [19.8]	0.5 [13]	L	---
#9	EL28D14	LU28MT12	3.75 [95.3]	0.65 [16.5]	2.5 [64]	C, M	2
#10	EL32D14	LU32MT12	4.00 [101.6]	0.78 [19.8]	2.7 [69]	C, M	2
#11	EL36D14	LU36MT12	4.50 [114.3]	1.04 [26.4]	3.0 [76]	C, M	2
#14	EL43TD14	LU43TMT12	5.50 [139.7]	1.64 [41.7]	4.0 [102]	C, M	2
#18	EL57TD14	LU57TMT12	7.25 [184.2]	2.31 [58.7]	4.8 [122]	C, M	2

CL = DL - DIFF

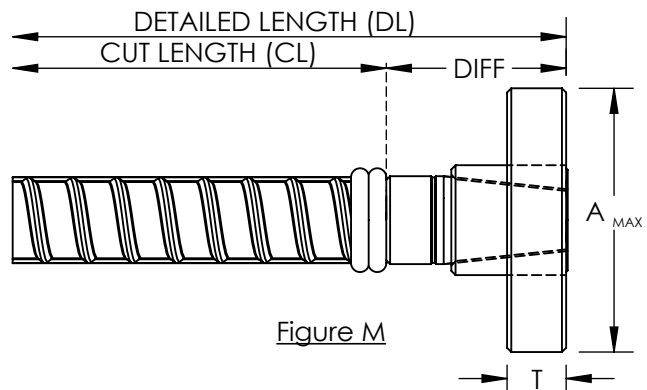
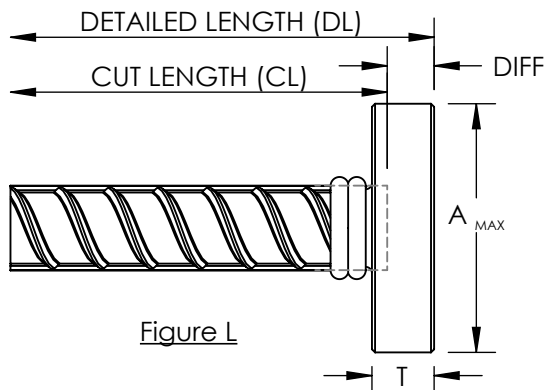

nVent, CADDY, ERICO CADWELD, ERICO CRITEC, ERICO, ERIFLEX, and LENTON are registered trademarks of nVent or its global affiliates. All other trademarks are the property of their respective owners. nVent reserves the right to change specifications without prior notice.