

# nVent LENTON Connect Coupler Transition Chart



## CANADIAN REBAR

Standard nVent LENTON Connect is designed to be used for single-step transitions and in some cases multi-step transitions.

	LC16S2D LC16B12D	LC20S2D LC20B12D	LC25S2D LC25B12D	LC28S2D LC28B12D	LC36S2D LC36B12D
10M	✓	-	-	-	-
15M	✓	✓	-	-	-
20M	-	✓	✓	-	-
25M	-	-	✓	✓	-
30M	-	-	-	✓	✓
35M	-	-	-	-	✓

✓ Indicates which rebar sizes can be used in each coupler.

The higher-performing nVent LENTON Connect B12-series coupler can be substituted in place of the nVent LENTON Connect S2-series.

Please contact nVent LENTON or visit [www.nVent.com/LENTON](http://www.nVent.com/LENTON) for specific questions regarding regional availability, approvals or performance requirements.

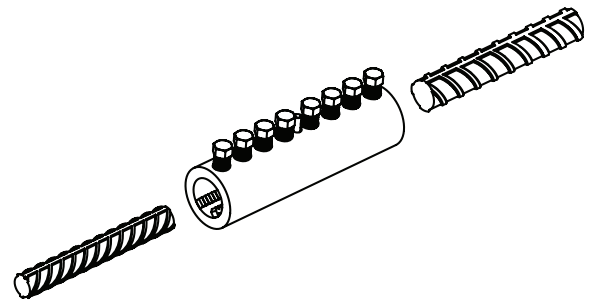

Our powerful portfolio of brands:

**CADDY ERICO HOFFMAN RAYCHEM SCHROFF TRACER**